

MPS-MT - Test plugs



0201744

<https://www.phoenixcontact.com/us/products/0201744>

Please be informed that the data shown in this PDF document is generated from our online catalog. Please find the complete data in the user documentation. Our general terms of use for downloads are valid.



Test plugs, with solder connection up to 1 mm² conductor cross section, number of positions: 1, color: gray

Your advantages

- The test plug reliably makes contact in the bridge shaft and in all test sockets with a 2.3 mm diameter
- Two-piece test plug for individual plug color combinations
- The test plugs are inserted in the function shaft of terminal blocks from the CLIPLINE complete system or in the test connections provided

Commercial data

| | |
|--------------------------------------|--------------------|
| Item number | 0201744 |
| Packing unit | 1 pc |
| Minimum order quantity | 10 pc |
| Sales key | BE19 |
| Product key | BE1Z3X |
| Catalog page | Page 38 (C-1-2019) |
| GTIN | 4017918098803 |
| Weight per piece (including packing) | 1.38 g |
| Weight per piece (excluding packing) | 1.3 g |
| Customs tariff number | 85366990 |
| Country of origin | DE |

MPS-MT - Test plugs

0201744

<https://www.phoenixcontact.com/us/products/0201744>



Technical data

Product properties

| | |
|---------------------|--------------------------|
| Product type | Test plug terminal block |
| Number of positions | 1 |
| Pitch | 5 mm |

Dimensions

| | |
|----------------------|----------------------------------|
| Width | 5 mm |
| Height | 5 mm |
| Length contact range | 10.85 mm |
| Pin diameter | 2.3 mm |
| Pitch | 5 mm |
| Note on dimensions | Length without insulating sleeve |

Material specifications

| | |
|-------|------|
| Color | gray |
|-------|------|

MPS-MT - Test plugs

0201744

<https://www.phoenixcontact.com/us/products/0201744>



Classifications

ECLASS

| | |
|-------------|----------|
| ECLASS-11.0 | 27440313 |
| ECLASS-12.0 | 27440313 |
| ECLASS-13.0 | 27440313 |

ETIM

| | |
|----------|----------|
| ETIM 8.0 | EC002255 |
|----------|----------|

UNSPSC

| | |
|-------------|----------|
| UNSPSC 21.0 | 20122000 |
|-------------|----------|

MPS-MT - Test plugs



0201744

<https://www.phoenixcontact.com/us/products/0201744>

Environmental product compliance

| | |
|------------|--|
| China RoHS | Environmentally Friendly Use Period = 50 years |
| | For information on hazardous substances, refer to the manufacturer's declaration available under "Downloads" |

MPS-MT - Test plugs

0201744

<https://www.phoenixcontact.com/us/products/0201744>



Accessories

MPS-IH WH - Insulating sleeve

0201663

<https://www.phoenixcontact.com/us/products/0201663>

Insulating sleeve, color: white



MPS-IH RD - Insulating sleeve

0201676

<https://www.phoenixcontact.com/us/products/0201676>

Insulating sleeve, color: red



MPS-MT - Test plugs

0201744

<https://www.phoenixcontact.com/us/products/0201744>



MPS-IH BU - Insulating sleeve

0201689

<https://www.phoenixcontact.com/us/products/0201689>

Insulating sleeve, color: blue

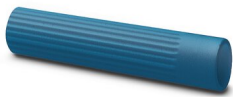

MPS-IH YE - Insulating sleeve

0201692

<https://www.phoenixcontact.com/us/products/0201692>

Insulating sleeve, color: yellow



MPS-MT - Test plugs

0201744

<https://www.phoenixcontact.com/us/products/0201744>



MPS-IH GN - Insulating sleeve

0201702

<https://www.phoenixcontact.com/us/products/0201702>

Insulating sleeve, color: green



MPS-IH GY - Insulating sleeve

0201728

<https://www.phoenixcontact.com/us/products/0201728>

Insulating sleeve, color: gray



MPS-MT - Test plugs

0201744

<https://www.phoenixcontact.com/us/products/0201744>



MPS-IH BK - Insulating sleeve

0201731

<https://www.phoenixcontact.com/us/products/0201731>

Insulating sleeve, color: black



Phoenix Contact 2023 © - all rights reserved

<https://www.phoenixcontact.com>

Phoenix Contact USA
586 Fulling Mill Road
Middletown, PA 17057, United States
(+717) 944-1300
info@phoenixcon.com