

THIS DOCUMENT IS SUBJECT TO CHANGE WITHOUT NOTICE. IT IS CONFIDENTIAL AND A PROPERTY OF Amphenol LTW. DISCLOSURE TO THIRD PARTY HAS TO BE AUTHORIZED BY Amphenol LTW.

REV.	ECN NO.	DATE	SIGN	DESCRIPTION
A	-	2021/10/20	Allen	New Initial.
B	C211672	2021/11/03	Allen	△ B X3.

M5-XXBMMM-SL7FXX

XX:NO.OF Pin

XX:01~99Meter  
 01:01Meter  
 02:02Meters  
 :  
 99:99Meters

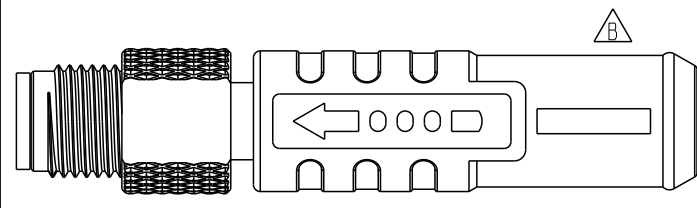
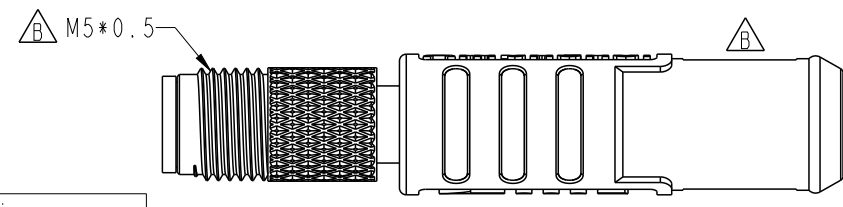
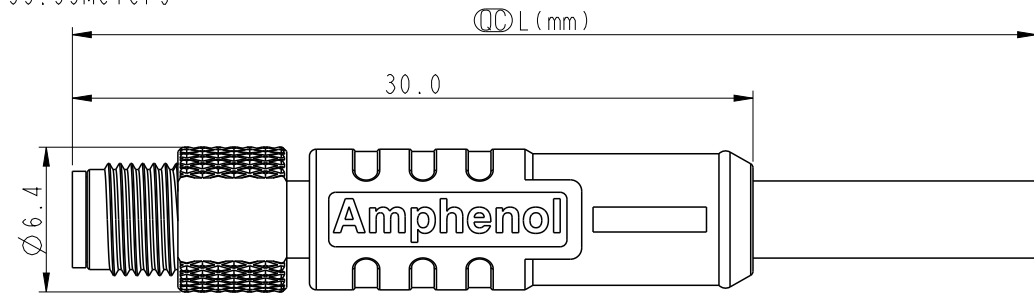
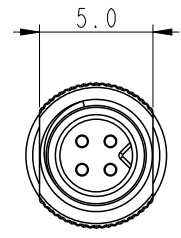

3Pin		4Pin	
4	Black 黑	4	Black 黑
3	Blue 藍	3	Blue 藍
1	Brown 棕	2	White 白
		1	Brown 棕
Pin #	Wire	Pin #	Wire

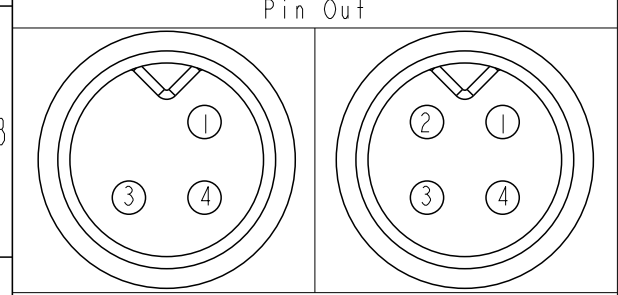

Note

- \*  $\varnothing$  Important Dimension To Check
- \* Waterproof Rate: IPX7, Mated.
- \* Connector Housing: Thermoplastic, Black.
- \* Pin: Copper Alloy, Gold Plated.
- \* Nut: Metal.
- \* Outer mold: Thermoplastic, Black.
- \* Cable: UL2103 26AWG, PVC Jacket, Black.
- \* Cable length tolerance: 1M: +50/-0 mm
- 1M < L ≤ 3M: +100/-0 mm
- 3M < L ≤ 5M: +150/-0 mm
- 5M < L ≤ 10M: ±100 mm
- 10M < L ≤ 20M: ±200 mm
- 20M < L ≤ 30M: ±300 mm
- 30M < L ≤ 99M: ±500 mm

\* RoHS Compliant.

UNIT:mm		TITLE	N SEN, M5, 04P, SCREW CABLE W/O SR, M, M, MOLDING	
TOLERANCE	±0.5mm	SCALE	3:1	SIZE A4
		REV.	B	WC-REV. .0
			$\varnothing$ Inspection item	

**Amphenol LTW**  
 安費諾亮泰企業股份有限公司

ITEM NO	DRAWN BY	DATE
	Allen	2021/10/20
DWG NO	CHECKED BY	DATE
M5-XXBMMM-SL7FXX	Wen	2021/10/20
CUSTOMER	APPROVED BY	DATE
ALTW	Neo	2021/10/20