

# I.142 | Tapered handle

Duroplast

METRIC

RoHS

PF

+230 °F  
-4 °F

## MATERIAL

Phenolic based (PF) Duroplast, black colour, glossy finish.

## STANDARD EXECUTION

Threaded blind hole.

# I.195 | Tapered handle

Duroplast

METRIC

RoHS

PF

+230 °F  
-4 °F

## MATERIAL

Phenolic based (PF) Duroplast, black colour, glossy finish.

## STANDARD EXECUTION

Threaded blind hole.

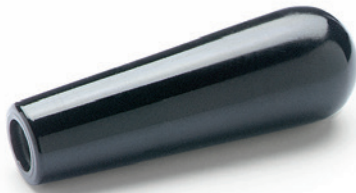

Conversion Table	
1 mm = 0.039 inch	
L	
mm	inch
60	2.36

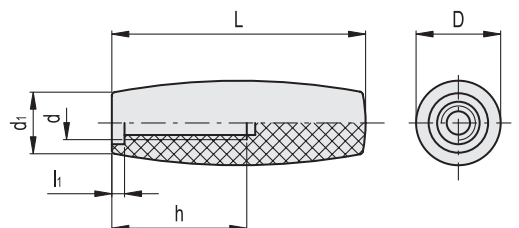
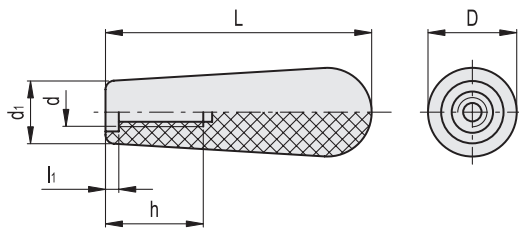

METRIC

METRIC

Code	Description	D	L	d	d1	h	l1	⚖️
19701	I.142/60-M8	20	60	M8	14	20	3	17

Code	Description	D	L	d	d1	h	l1	⚖️
20401	I.195/60-M8	20	60	M8	14	30	4	18

Fixed & Revolving handles