

Technical Data Sheet

16in. USB 2.0 to RS-232 Serial Converter w/ LED Indicators & FTDI

Model Number: GM-FTDI-LED16

Rev 03.210312

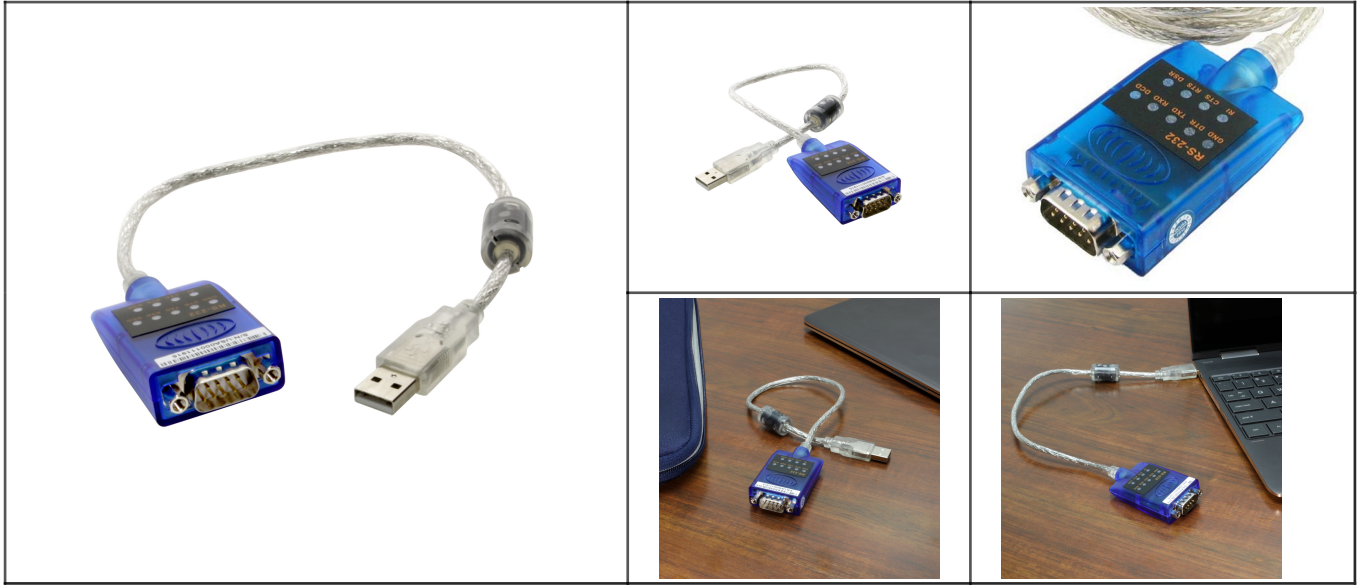

This 16 inch USB to Serial adapter is a tool of choice when supporting serial peripherals in newer computers without serial support. Now supported by Windows 10, this is an ideal solution for device support.

Features

- Convenient 16 inch total length for troubleshooting
- Fully compliant with USB Spec 2.0
- ESD Protection for RS-232 I/O +/-15KV RS-232 for DTE Mode
- Supports Win 7, 8, and Windows 10, Linux, and Mac OS 10.X
- RS-232 - DB9 / M Data rate : Over 1000kbps

Product Information

- Model Number: GM-FTDI-LED16
- Packing List:
 -

Specifications

OVERVIEW

Product Type	Serial Adapter
Electrical Protections	15KV ESD Protection
Mountable	
Material	
Compliance	N/A
LED indicators	All Signals
Requires Host to Function	

0

Serial Modes	RS232
RS232 Signals	DCD, RxD, TxD, DTR, GND, DSR, RTS, CTS, RI
RS422 Signals	
RS485 2-wire Signals	
RS485 4-wire Signals	

SERIAL SPECS

Maximum Data Rate	460.8 Kbps
Minimum Data Rate	300 baud/bps
Data Bits	
Parity	
Stop Bits	
Flow Control	
FIFO	

Specifications Cont.**ENVIRONMENTAL**

Operating Temperature	-40C ~ 85C
Operating Humidity	5% to 95% RH
Storage Temperature	-40C ~ 85C

PHYSICAL

Length	inches
Width	inches
Height	inches
Item Weight	lbs
Ship Weight	0.1310 lbs

OS SUPPORT

Supported Operating Systems	Linux, OSX 10, Windows 10, Windows 8, Windows 7
-----------------------------	-------------------------------------------------

WARRANTY

Warranty Period	
-----------------	--

PRODUCT URL

GM-FTDI-LED16 Product Page	
----------------------------	--