

Female Flag Disconnects

Non-Insulated Female Flag Disconnects

Material: Tin Plated Brass

Temperature: 300°F

Maximum Electrical Current: 22-16: 10 Amps **Barrel ID (d1):** 0.067
 16-14: 15 Amps **Barrel ID (d1):** 0.091
 12-10: 24 Amps **Barrel ID (d1):** 0.134

T = Material Thickness

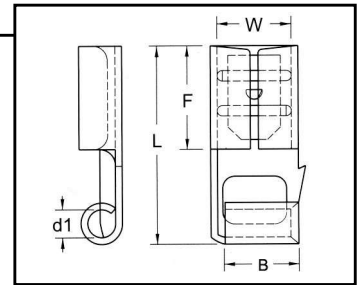

HOFFMAN PART NO.	WIRE SIZE	TAB	DIMENSIONS (INCHES)						UL	TAPE ON MOUNT REEL QTY	HAND TOOL
			W	F	L	B	T	UL			
DF22181ST5	22-18	.187 x .020	.197	0.244	0.445	0.217	0.016	NA	NA	FG6100	
DF22181ST8	22-18	.187 x .032	.197	0.244	0.445	0.217	0.016	NA	NA	FG6100	
DF22181T	22-18	.250 x .032	.26	0.299	0.551	0.291	0.016	NA	NA	FG6100	
DF18141ST5	16-14	.187 x .020	.197	0.244	0.457	0.217	0.016	NA	NA	FG6100	
DF18141ST8	16-14	.187 x .032	.197	0.244	0.457	0.217	0.016	NA	NA	FG6100	
DF18141T	16-14	.250 x .032	.26	0.299	0.551	0.291	0.016	NA	NA	FG6100	
DF12101T	12-10	.250 x .032	.26	0.299	0.571	0.295	0.016	NA	NA	FG6100	

Nylon Insulated Female Flag Disconnects

Material: Tin Plated Brass

Insulation Material: 6/6 UL94V2 Nylon

Maximum Electrical Rating: 105°C, 300V

Maximum Electrical Current: 22-16: 10 Amps **Barrel ID (d1):** 0.067
 16-14: 15 Amps **Barrel ID (d1):** 0.091
 12-10: 24 Amps **Barrel ID (d1):** 0.134

T = Material thickness

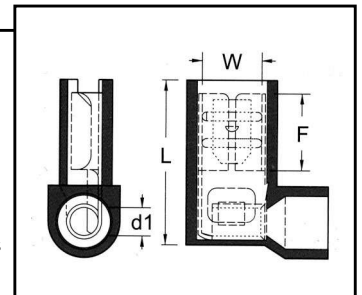

HOFFMAN PART NO.	WIRE SIZE	TAB	DIMENSIONS (INCHES)					UL	TAPE MOUNT REEL QTY	DIE FOR SCT70MS MOUNT	HAND TOOL
			W	F	L	T	UL				
FNDF22181ST5	22-18	.187 x .020	0.197	0.276	0.591	0.016	Y	1000	AFNDF2DIE	YNG2214	
FNDF22181ST8	22-18	.187 x .032	0.197	0.276	0.591	0.016	Y	1000	AFNDF2DIE	YNG2214	
FNDF22181T	22-18	.250 x .032	0.260	0.299	0.598	0.016	Y	1000	AFNDF2DIE	YNG2214	
FNDF18141ST5	16-14	.187 x .020	0.197	0.276	0.598	0.016	Y	1000	BFNDF2DIE	YNG2214	
FNDF18141ST8	16-14	.187 x .032	0.197	0.276	0.598	0.016	Y	1000	BFNDF2DIE	YNG2214	
FNDF18141T	16-14	.250 x .032	0.260	0.299	0.598	0.016	Y	1000	BFNDF2DIE	YNG2214	

