

SUMMARY

Wires

Low voltage 65



Image is for illustrative purpose only

Series	1R
Termination type	Female crimp
IP rating	50
AWG wire size	32.00 - 28.00
Cable Ø	2.00 - 9.20 mm
Status	Active
Matching parts	FGG.1R.365.GLC92

Download

[Request a quote](#)

[Catalog](#)

TECHNICAL DETAILS

Mechanics

Shell Style/Model	EBG*: Fixed receptacle, key (G) or key (A) with visible shell
Keying	3 keys (alpha=50,beta=30, plug: male contacts, receptacle: female contacts)
Housing Material	Crastin® PBT (Polybutylene terephthalate), gray
Weight	16.86 g

Performance

Configuration	1R.365 : 65 low voltage
Insulator	L: PEEK (UL 94 / V-0/1.5)
Rated Current	0.5 Amps

Specifications

Contact Type: Crimp
Test voltage (kV rms) Contact-contact: 0.6

Others

LEMO products and services are provided "as is". LEMO makes no warranties or representations with regard to LEMO product & services or use of them, express, implied or statutory, including for accuracy, completeness, or security. The user is fully responsible for his products and applications using LEMO components.

DRAWINGS

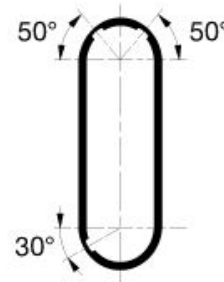
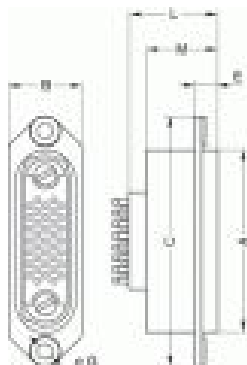

Dimensions

	A	B	C	E	G	L	M
mm.	37	15	51	4.5	3.2	19.5	14.5
in.	1,46	0,59	2,01	0,18	0,13	0,77	0,57

RECOMMENDED BY LEMO

Tools

- Crimp Tool: [DPC.91.701.V](#)
Crimp settings: AWG/Selector = 28-30-32/4-3-3
Positionner: [DCE.91.051.BVM](#)
Extractor: [DCC.05.02B.LAG](#)
Replacement contact: EGG.00.654.ZZM

LEMO products and services are provided "as is". LEMO makes no warranties or representations with regard to LEMO product & services or use of them, express, implied or statutory, including for accuracy, completeness, or security. The user is fully responsible for his products and applications using LEMO components.