

SUMMARY

Wires

Low voltage 36



Image is for illustrative purpose only

Series 1R
Termination type Female print PCB
IP rating 50
AWG wire size 0.00 - 0.00
Cable Ø 0.00 - 0.00 mm
Status Active

Download

[Request a quote](#)
[PCB Eagle Pattern](#)
[PCB Altium Pattern](#)
[PCB KiCad Pattern](#)
[Catalog](#)

TECHNICAL DETAILS

Mechanics

Shell Style/Model EBG*: Fixed receptacle, key (G) or key (A) with visible shell
Keying 3 keys (alpha=50,beta=30, plug: male contacts, receptacle: female contacts)
Housing Material Crastin® PBT (Polybutylene terephthalate), gray
Weight 14.05 g

Performance

Configuration 1R.336 : 36 low voltage
Insulator L: PEEK (UL 94 / V-0/1.5)
Rated Current 2.5 Amps

Specifications

Contact Type: Print (straight)

Others

LEMO products and services are provided "as is". LEMO makes no warranties or representations with regard to LEMO product & services or use of them, express, implied or statutory, including for accuracy, completeness, or security. The user is fully responsible for his products and applications using LEMO components.

DRAWINGS

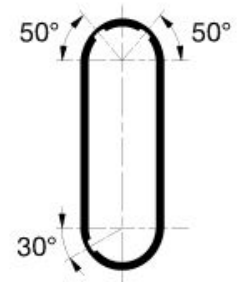
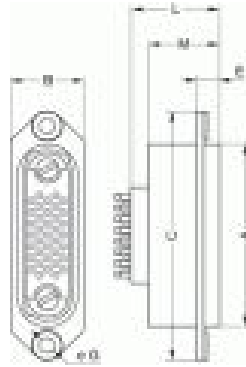

Dimensions

	A	B	C	E	G	L	M
mm.	37	15	51	4.5	3.2	19.5	14.5
in.	1,46	0,59	2,01	0,18	0,13	0,77	0,57

RECOMMENDED BY LEMO

Tools

LEMO products and services are provided "as is". LEMO makes no warranties or representations with regard to LEMO product & services or use of them, express, implied or statutory, including for accuracy, completeness, or security. The user is fully responsible for his products and applications using LEMO components.