

SUMMARY

Wires

| | |
|-------------|---|
| Low voltage | 2 |
|-------------|---|

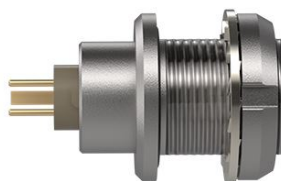

Image is for illustrative purpose only

| | |
|------------------|-----------------------------|
| Series | 0T |
| Termination type | Female print PCB |
| IP rating | 68 mated (mating interface) |
| AWG wire size | 0.00 - 0.00 |
| Cable Ø | 0.00 - 0.00 mm |
| Status | Active |

Download

[Request a quote](#)
[PCB Eagle Pattern](#)
[PCB Altium Pattern](#)
[PCB KiCad Pattern](#)

TECHNICAL DETAILS

Mechanics

| | |
|-------------------|---|
| Shell Style/Model | EA*: Fixed receptacle, nut fixing (back panel mounting) |
| Keying | 1 key (alpha=0, plug: male contacts, receptacle: female contacts) |
| Housing Material | Brass (chrome plated [SAE AMS 2460]) shell and collet nut, nickel plated [SAE AMS QQ N 290] brass latch sleeve and mid pieces |
| Weight | 4.37 g |

Performance

| | |
|---------------|---|
| Configuration | 0T.511 : SPE - 2 High Speed, Low Voltage (1000BASE-T1 (IEEE 802.3bp)) |
| Insulator | L: PEEK (UL 94 / V-0/1.5) |
| Rated Current | |

Others

Endurance (Shell): >3000 mating cycles
Temp (min / max): -55°C / +200°C
Humidity (max): <=95% [at 60 deg C / 140 F]
Resistance to vibration: 15 g [10 Hz - 2000 Hz]

LEMO products and services are provided "as is". LEMO makes no warranties or representations with regard to LEMO product & services or use of them, express, implied or statutory, including for accuracy, completeness, or security. The user is fully responsible for his products and applications using LEMO components.

Shock Resistance: 100 g [6 ms]
Climatical Category: 50/175/21
Shielding efficiency (min): 75 dB (at 10 MHz)
Shielding efficiency (min): 40 dB (at 1 GHz)
Salt Spray Corrosion: >1000 hr

DRAWINGS

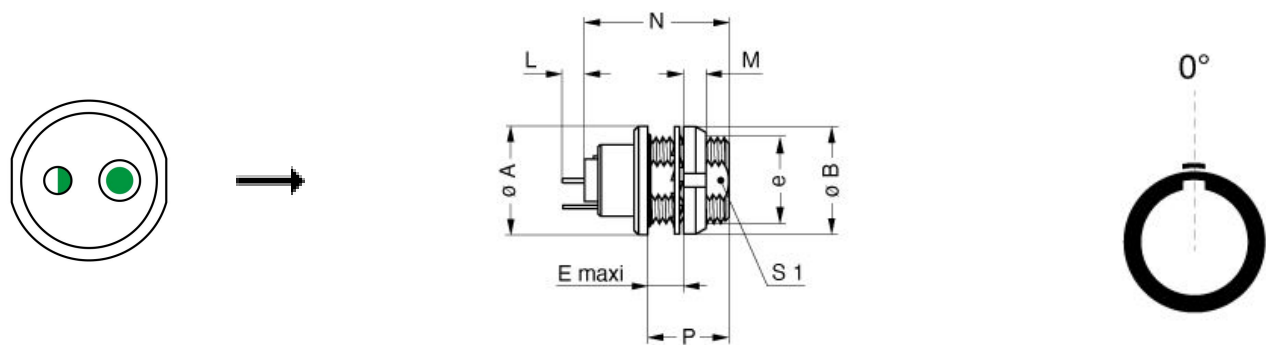

Dimensions

| | A | B | E | L | M | N | P | S1 | e |
|-----|------|------|------|------|------|------|------|------|--------|
| mm. | 12 | 12 | 6.5 | 3.3 | 2.5 | 13 | 9 | 8.2 | M9x0.6 |
| in. | 0,47 | 0,47 | 0,26 | 0,13 | 0,10 | 0,51 | 0,35 | 0,32 | |

RECOMMENDED BY LEMO

Tools

Spanner wrench: [Socket for torque wrench DCM.0S.M09.4](#)

LEMO products and services are provided “as is”. LEMO makes no warranties or representations with regard to LEMO product & services or use of them, express, implied or statutory, including for accuracy, completeness, or security. The user is fully responsible for his products and applications using LEMO components.