



- 1
- 2
- 3
- 4
- 5
- 6
- 7
- 8
- 9
- 10
- 11
- 12
- 13
- 14
- 15
- 16
- 17
- 18

STANDARD EXECUTIONS

- **DVA.4:** threaded stud and base plate in polished zinc-plated steel, vibration-damper body in natural rubber NR, black colour, hardness 40, 55, 70 Shore A ±5.
- **DVA.4-SST:** threaded stud and base plate in INOX AISI 304 stainless steel, vibration-damper body in natural rubber NR, black colour, hardness 55 Shore A ±5.

FEATURES AND APPLICATIONS

The rubber buffers have been designed to damp vibrations, shocks and noises produced by moving bodies or non-balanced vibrating masses of equipment and machines which can cause:

- malfunctioning and reduction of the machine lifespan and/or of the adjacent ones;
- damage to health;
- noise.

Load diagrams for each single code are available on request. See Technical data and guidelines for the choice (on page 728).

SPECIAL EXECUTIONS ON REQUEST

Natural rubber NR, hardness 40, 70 tolerance ±5 Shore A for executions with AISI 304 stainless steel base.

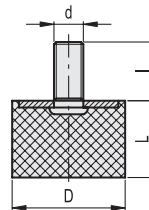

DVA.4

* Complete the description with the desired hardness: 40, 55 or 70 tolerance ±5 Shore A.

DVA.4 - 8 - 8 - M3 - 6 - 55

D
L
d
l
Shore A

Conversion Table					
1 mm = 0.039 inch					
D			L		
mm	inch	mm	inch	mm	inch
8	0.31	50	1.97	8	0.31
10	0.39	60	2.36	10	0.39
15	0.59	70	2.76	13	0.51
20	0.79	75	2.95	15	0.59
25	0.98	80	3.12	17	0.67
30	1.18	100	3.94	20	0.79
40	1.57	125	4.92	25	0.98

DVA.4



Description	D	L	d	l	⚖️	Hardness 40 Shore A			Hardness 55 Shore A			Hardness 70 Shore A					
						Code	Max load [N]	Max deflection [mm]	Stiffness [N/mm]	Code	Max load [N]	Max deflection [mm]	Stiffness [N/mm]	Code	Max load [N]	Max deflection [mm]	Stiffness [N/mm]
DVA.4-8-8-M3-6*	8	8	M3	6	3	415201	34	2	17	412700	55	2	28	417901	141	2	71
DVA.4-8-13-M3-6*	8	13	M3	6	1	415205	33	3	10	412699	50	3	15	417905	133	3	41
DVA.4-10-10-M4-10*	10	10	M4	10	2	415211	54	3	21	412701	88	3	35	417911	217	3	87
DVA.4-10-15-M4-10*	10	15	M4	10	3	415221	69	4	18	412703	92	4	25	417921	175	4	47
DVA.4-10-20-M4-10*	10	20	M4	10	3	415223	54	5	11	412705	95	5	19	417923	156	5	31
DVA.4-15-10-M4-10*	15	10	M4	10	4	415231	110	2	55	412706	168	2	84	417931	410	2	205
DVA.4-15-15-M4-10*	15	15	M4	10	5	415241	141	4	38	412709	259	4	69	417941	384	4	102
DVA.4-15-20-M4-10*	15	20	M4	10	7	415251	134	5	27	412711	223	5	45	417951	590	5	118
DVA.4-15-30-M4-10*	15	30	M4	10	9	415261	125	8	17	412716	258	8	34	417961	392	8	52
DVA.4-20-5-M6-18*	20	5	M6	18	12	415266	1148	1	918	412718	11840	1	9472	417967	3250	1	2600
DVA.4-20-8-M6-18*	20	8	M6	18	14	415267	560	2	280	412719	882	2	441	417969	1713	2	856
DVA.4-20-10-M6-18*	20	10	M6	18	15	415271	390	3	156	412721	645	3	258	417971	940	3	376
DVA.4-20-15-M6-18*	20	15	M6	18	10	415281	289	4	77	412741	468	4	125	417981	704	4	188
DVA.4-20-20-M6-18*	20	20	M6	18	13	415291	258	5	52	412746	367	5	73	417991	809	5	162
DVA.4-20-25-M6-18*	20	25	M6	18	17	415296	250	6	40	412748	345	6	55	417996	857	6	137
DVA.4-20-30-M6-18*	20	30	M6	18	23	415301	237	8	32	412751	420	8	56	418001	848	8	113
DVA.4-25-15-M6-18*	25	15	M6	18	18	415311	485	4	129	412756	797	4	213	418011	1627	4	434
DVA.4-25-17-M6-18*	25	17	M6	18	20	415321	422	4	99	412761	833	4	196	418021	1726	4	406
DVA.4-25-20-M6-18*	25	20	M6	18	20	415331	416	5	83	412766	581	5	116	418031	1382	5	276
DVA.4-25-25-M6-18*	25	25	M6	18	23	415336	410	6	65	412768	645	6	103	418036	1500	6	240
DVA.4-25-25-M8-18*	25	25	M8	18	22	415346	532	6	85	412773	650	6	104	418056	1120	6	179
DVA.4-25-30-M6-18*	25	30	M6	18	25	415341	290	8	39	412771	591	8	79	418041	1186	8	158

Vibration damping elements

DVA.4

METRIC

Description	D	L	d	l	△	Hardness 40 Shore A			Hardness 55 Shore A			Hardness 70 Shore A					
						Code	Max load [N]	Max deflection [mm]	Stiffness [N/mm]	Code	Max load [N]	Max deflection [mm]	Stiffness [N/mm]	Code	Max load [N]	Max deflection [mm]	Stiffness [N/mm]
DVA.4-30-15-M8-20-*	30	15	M8	20	30	415351	746	4	199	412776	1023	4	273	418051	2610	4	696
DVA.4-30-17-M8-20-*	30	17	M8	20	31	415361	772	4	182	412781	1275	4	300	418061	2447	4	576
DVA.4-30-20-M8-20-*	30	20	M8	20	35	415371	567	5	113	412801	1014	5	203	418071	1878	5	376
DVA.4-30-22-M8-20-*	30	22	M8	20	36	415376	689	5	125	412806	1103	5	200	418076	1996	5	362
DVA.4-30-25-M8-20-*	30	25	M8	20	38	415381	576	6	92	412811	1026	6	164	418081	1591	6	255
DVA.4-30-30-M8-20-*	30	30	M8	20	43	415391	601	8	80	412821	776	8	103	418091	1616	8	215
DVA.4-30-40-M8-20-*	30	40	M8	20	48	415396	580	10	58	412826	910	10	91	418096	1780	10	178
DVA.4-40-20-M8-23-*	40	20	M8	23	55	415401	1200	5	240	412831	2500	5	500	418101	4750	5	950
DVA.4-40-20-M10-23-*	40	20	M10	23	54	415433	1027	5	205	412866	1907	5	381	418133	3230	5	646
DVA.4-40-25-M8-23-*	40	25	M8	23	60	415411	1170	6	187	412836	1660	6	266	418111	4130	6	661
DVA.4-40-25-M10-23-*	40	25	M10	23	59	415434	975	6	156	412868	1925	6	308	418134	2880	6	460
DVA.4-40-28-M8-23-*	40	28	M8	23	62	415435	1012	7	145	412838	1748	7	249	418116	3060	7	437
DVA.4-40-30-M8-23-*	40	30	M8	23	73	415421	1140	8	152	412841	1480	8	197	418121	2830	8	377
DVA.4-40-35-M10-23-*	40	35	M10	23	78	415436	940	8	107	412871	1572	8	179	418135	3680	8	420
DVA.4-40-38-M8-23-*	40	38	M8	23	80	415437	970	9	102	412851	1492	9	157	418126	3370	9	354
DVA.4-40-40-M8-23-*	40	40	M8	23	83	415431	995	10	100	412861	1403	10	140	418131	3150	10	315
DVA.4-40-40-M10-23-*	40	40	M10	23	82	415438	1040	10	104	412875	1575	10	157	418136	3130	10	313
DVA.4-40-45-M10-23-*	40	45	M10	23	85	415439	1005	11	89	412878	1665	11	148	418137	2640	11	234
DVA.4-50-20-M10-28-*	50	20	M10	28	90	415441	2680	5	536	412881	3460	5	692	418141	7450	5	1490
DVA.4-50-25-M10-28-*	50	25	M10	28	98	415446	1867	6	298	412891	2970	6	475	418146	5130	6	820
DVA.4-50-30-M10-28-*	50	30	M10	28	118	415451	1820	8	243	412901	2520	8	336	418151	5420	8	723
DVA.4-50-35-M10-28-*	50	35	M10	28	125	415456	1705	8	194	412911	2800	8	320	418156	4920	8	562
DVA.4-50-40-M10-28-*	50	40	M10	28	140	415461	1430	10	143	412921	2760	10	276	418161	4950	10	495
DVA.4-50-45-M10-28-*	50	45	M10	28	158	415466	1627	11	144	412922	2455	11	218	418166	4600	11	408
DVA.4-50-50-M10-28-*	50	50	M10	28	155	415463	1366	13	109	412923	2700	13	216	418163	4190	13	335
DVA.4-60-20-M10-28-*	60	20	M10	28	219	415471	1885	5	377	412931	3850	5	770	418171	11990	5	2398
DVA.4-60-25-M10-28-*	60	25	M10	28	223	415473	2550	6	408	412933	5000	6	800	418173	8020	6	1283
DVA.4-60-36-M10-28-*	60	36	M10	28	263	415476	2428	9	269	412935	4110	9	456	418176	6690	9	743
DVA.4-60-40-M10-28-*	60	40	M10	28	295	415481	2600	10	260	412936	3540	10	354	418181	4640	10	464
DVA.4-60-45-M10-28-*	60	45	M10	28	300	415486	2378	11	211	412937	4200	11	373	418186	8020	11	712
DVA.4-60-60-M10-28-*	60	60	M10	28	312	415485	2530	15	169	412939	3480	15	232	418185	8110	15	541
DVA.4-70-30-M10-28-*	70	30	M10	28	280	415490	4930	8	657	412940	7170	8	956	418190	13070	8	1743
DVA.4-70-35-M10-28-*	70	35	M10	28	285	415489	4120	9	471	412942	6680	9	763	418189	9850	9	1125
DVA.4-70-40-M10-28-*	70	40	M10	28	290	415491	3850	10	385	412941	6280	10	628	418191	15280	10	1528
DVA.4-70-50-M10-28-*	70	50	M10	28	320	415496	3680	12	294	412946	5550	12	444	418196	14960	12	1196
DVA.4-70-55-M10-28-*	70	55	M10	28	357	415501	3320	14	241	412951	5770	14	420	418201	9510	14	692
DVA.4-70-70-M10-28-*	70	70	M10	28	380	415506	3200	17	182	412966	5370	17	306	418206	13770	17	786
DVA.4-75-25-M12-37-*	75	25	M12	37	270	415511	6560	6	1050	412961	9660	6	1546	418211	20780	6	3325
DVA.4-75-40-M12-37-*	75	40	M12	37	310	415521	5010	10	501	412971	6680	10	668	418221	9170	10	917
DVA.4-75-50-M12-37-*	75	50	M12	37	340	415531	3970	13	318	412981	5570	13	446	418231	13550	13	1084
DVA.4-80-30-M14-37-*	80	30	M14	37	320	415533	6130	7	817	412991	10080	7	1344	418233	21100	7	2813
DVA.4-80-40-M14-37-*	80	40	M14	37	330	415535	4750	10	475	412994	9260	10	926	418235	17050	10	1705
DVA.4-80-80-M14-37-*	80	80	M14	37	390	415537	4280	20	214	412997	6970	20	348	418237	15560	20	778
DVA.4-100-40-M16-41-*	100	40	M16	41	570	415541	9430	10	943	413001	12110	10	1211	418241	24190	10	2419
DVA.4-100-50-M16-41-*	100	50	M16	41	655	415551	8320	13	666	413011	14040	13	1123	418251	22900	13	1832
DVA.4-100-60-M16-41-*	100	60	M16	41	830	415561	7440	15	496	413021	12950	15	863	418261	21450	15	1430
DVA.4-125-55-M16-41-*	125	55	M16	41	1055	415581	19700	14	1433	413025	23790	14	1730	418271	25000	14	2212
DVA.4-125-75-M16-41-*	125	75	M16	41	1425	415591	17600	19	939	413027	20123	19	1073	418281	24780	19	1322



Vibration damping elements

- 1
- 2
- 3
- 4
- 5
- 6
- 7
- 8
- 9
- 10
- 11
- 12
- 13
- 14
- 15
- 16
- 17
- 18

DVA.4 - 8 - 8 - SST - M3 - 6 - 55
 D L Stainless steel d l Shore A

DVA.4-SST

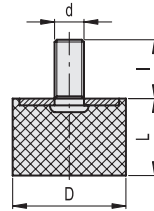

D		L	
mm	inch	mm	inch
8	0.31	50	1.97
10	0.39	60	2.36
15	0.59	70	2.76
20	0.79	75	2.95
25	0.98	80	3.12
30	1.18	100	3.94
40	1.57	125	4.92

DVA.4-SST

INOX STAINLESS STEEL METRIC

Description	D	L	d	l	⚖	Hardness 40 Shore A			Hardness 55 Shore A			Hardness 70 Shore A					
						Code	Max load [N]	Max deflection [mm]	Stiffness [N/mm]	Code	Max load [N]	Max deflection [mm]	Stiffness [N/mm]	Code	Max load [N]	Max deflection [mm]	Stiffness [N/mm]
DVA.4-8-8-SST-M3-6-55	8	8	M3	6	3		34	2	17	410301	55	2	28		141	2	71
DVA.4-8-13-SST-M3-6-55	8	13	M3	6	1		33	3	10	410303	50	3	15		133	3	41
DVA.4-10-10-SST-M4-10-55	10	10	M4	10	2		54	3	21	410305	88	3	35		217	3	87
DVA.4-10-15-SST-M4-10-55	10	15	M4	10	3		69	4	18	410307	92	4	25		175	4	47
DVA.4-10-20-SST-M4-10-55	10	20	M4	10	3		54	5	11	410309	95	5	19		156	5	31
DVA.4-15-10-SST-M4-10-55	15	10	M4	10	4		110	2	55	410311	168	2	84		410	2	205
DVA.4-15-15-SST-M4-10-55	15	15	M4	10	5		141	4	38	410313	259	4	69		384	4	102
DVA.4-15-20-SST-M4-10-55	15	20	M4	10	7		134	5	27	410315	223	5	45		590	5	118
DVA.4-15-30-SST-M4-10-55	15	30	M4	10	9		125	8	17	410317	258	8	34		392	8	52
DVA.4-20-5-SST-M6-18-55	20	5	M6	18	12		1148	1	918	410318	11840	1	9472	ON REQUEST	3250	1	2600
DVA.4-20-8-SST-M6-18-55	20	8	M6	18	14		560	2	280	410319	882	2	441		1713	2	856
DVA.4-20-10-SST-M6-18-55	20	10	M6	18	15		390	3	156	410321	645	3	258		940	3	376
DVA.4-20-15-SST-M6-18-55	20	15	M6	18	10		289	4	77	410323	468	4	125		704	4	188
DVA.4-20-20-SST-M6-18-55	20	20	M6	18	13		258	5	52	410325	367	5	73		809	5	162
DVA.4-20-25-SST-M6-18-55	20	25	M6	18	17		250	6	40	410326	345	6	55		857	6	137
DVA.4-20-30-SST-M6-18-55	20	30	M6	18	23		237	8	32	410327	420	8	56		848	8	113
DVA.4-25-15-SST-M6-18-55	25	15	M6	18	18		485	4	129	410331	797	4	213		1627	4	434
DVA.4-25-17-SST-M6-18-55	25	17	M6	18	20		422	4	99	410333	833	4	196		1726	4	406
DVA.4-25-20-SST-M6-18-55	25	20	M6	18	20		416	5	83	410335	581	5	116		1382	5	276
DVA.4-25-25-SST-M6-18-55	25	25	M6	18	23		410	6	65	410336	645	6	103		1500	6	240
DVA.4-25-25-SST-M8-18-55	25	25	M8	18	22		532	6	85	410338	650	6	104		1120	6	179
DVA.4-25-30-SST-M6-18-55	25	30	M6	18	25		290	8	39	410337	591	8	79		1186	8	158

Vibration damping elements

DVA.4-SST

INOX STAINLESS STEEL METRIC

Description	D	L	d	l	⚖️	Hardness 40 Shore A			Hardness 55 Shore A			Hardness 70 Shore A					
						Code	Max load [N]	Max deflection [mm]	Stiffness [N/mm]	Code	Max load [N]	Max deflection [mm]	Stiffness [N/mm]	Code	Max load [N]	Max deflection [mm]	Stiffness [N/mm]
DVA.4-30-15-SST-M8-20-55	30	15	M8	20	30		746	4	199	410341	1023	4	273		2610	4	696
DVA.4-30-17-SST-M8-20-55	30	17	M8	20	31		772	4	182	410343	1275	4	300		2447	4	576
DVA.4-30-20-SST-M8-20-55	30	20	M8	20	35		567	5	113	410345	1014	5	203		1878	5	376
DVA.4-30-22-SST-M8-20-55	30	22	M8	20	36		689	5	125	410346	1103	5	200		1996	5	362
DVA.4-30-25-SST-M8-20-55	30	25	M8	20	38		576	6	92	410347	1026	6	164		1591	6	255
DVA.4-30-30-SST-M8-20-55	30	30	M8	20	43		601	8	80	410349	776	8	103		1616	8	215
DVA.4-30-40-SST-M8-20-55	30	40	M8	20	48		580	10	58	410350	910	10	91		1780	10	178
DVA.4-40-20-SST-M8-23-55	40	20	M8	23	55		1200	5	240	410351	2500	5	500		4750	5	950
DVA.4-40-20-SST-M10-23-55	40	20	M10	23	54		1027	5	205	410352					3230	5	646
DVA.4-40-25-SST-M8-23-55	40	25	M8	23	60		1170	6	187	410353	1660	6	266		4130	6	661
DVA.4-40-25-SST-M10-23-55	40	25	M10	23	23		975	6	156	410354	1925	6	308		2880	6	460
DVA.4-40-28-SST-M8-23-55	40	28	M8	23	22		1012	7	145	410356	1748	7	249		3060	7	437
DVA.4-40-30-SST-M8-23-55	40	30	M8	23	73		1140	8	152	410355	1480	8	197		2830	8	377
DVA.4-40-35-SST-M10-23-55	40	35	M10	23	78		940	8	107	410358	1572	8	179		3680	8	420
DVA.4-40-38-SST-M8-23-55	40	38	M8	23	80		970	9	102	410359	1492	9	157		3370	9	354
DVA.4-40-40-SST-M8-23-55	40	40	M8	23	83		995	10	100	410357	1403	10	140		3150	10	315
DVA.4-40-40-SST-M10-23-55	40	40	M10	23	82		1040	10	104	410360	1575	10	157		3130	10	313
DVA.4-40-45-SST-M10-23-55	40	45	M10	23	85		1005	11	89	410362	1665	11	148		2640	11	234
DVA.4-50-20-SST-M10-28-55	50	20	M10	28	90		2680	5	536	410361	3460	5	692		7450	5	1490
DVA.4-50-25-SST-M10-28-55	50	25	M10	28	98		1867	6	298	410364	2970	6	475		5130	6	820
DVA.4-50-30-SST-M10-28-55	50	30	M10	28	118		1820	8	243	410363	2520	8	336		5420	8	723
DVA.4-50-35-SST-M10-28-55	50	35	M10	28	125		1705	8	194	410366	2800	8	320		4920	8	562
DVA.4-50-40-SST-M10-28-55	50	40	M10	28	140	ON REQUEST	1430	10	143	410365	2760	10	276	ON REQUEST	4950	10	495
DVA.4-50-45-SST-M10-28-55	50	45	M10	28	148		1627	11	144	410368	2455	11	218		4600	11	408
DVA.4-50-50-SST-M10-28-55	50	50	M10	28	155		1366	13	109	410367	2700	13	216		4190	13	335
DVA.4-60-20-SST-M10-28-55	60	20	M10	28	219		1885	5	377	410371	3850	5	770		11990	5	2398
DVA.4-60-25-SST-M10-28-55	60	25	M10	28	223		2550	6	408	410370	5000	6	800		8020	6	1283
DVA.4-60-36-SST-M10-28-55	60	36	M10	28	263		2428	9	269	410372	4110	9	456		6690	9	743
DVA.4-60-40-SST-M10-28-55	60	40	M10	28	195		2600	10	260	410373	3540	10	354		4640	10	464
DVA.4-60-45-SST-M10-28-55	60	45	M10	28	300		2378	11	211	410374	4200	11	373		8020	11	712
DVA.4-60-60-SST-M10-28-55	60	60	M10	28	312		2530	15	169	410375	3480	15	232		8110	15	541
DVA.4-70-30-SST-M10-28-55	70	30	M10	28	280		4930	8	657	410376	7170	8	956		13070	8	1743
DVA.4-70-35-SST-M10-28-55	70	35	M10	28	285		4120	9	471	410378	6680	9	763		9850	9	1125
DVA.4-70-40-SST-M10-28-55	70	40	M10	28	265		3850	10	385	410377	6280	10	628		15280	10	1528
DVA.4-70-50-SST-M10-28-55	70	50	M10	28	320		3680	12	294	410380	5550	12	444		14960	12	1196
DVA.4-70-55-SST-M10-28-55	70	55	M10	28	357		3320	14	241	410379	5770	14	420		9510	14	692
DVA.4-70-70-SST-M10-28-55	70	70	M10	28	380		3200	17	182	410382	5370	17	306		13770	17	786
DVA.4-75-25-SST-M12-37-55	75	25	M12	37	223		6560	6	1050	410381	9660	6	1546		20780	6	3325
DVA.4-75-40-SST-M12-37-55	75	40	M12	37	310		5010	10	501	410383	6680	10	668		9170	10	917
DVA.4-75-50-SST-M12-37-55	75	50	M12	37	340		3970	13	318	410385	5570	13	446		13550	13	1084
DVA.4-80-30-SST-M14-37-55	80	30	M14	37	320		6130	7	817	410387	10080	7	1344		21100	7	2813
DVA.4-80-40-SST-M14-37-55	80	40	M14	37	330		4750	10	475	410388	9260	10	926		17050	10	1705
DVA.4-80-80-SST-M14-37-55	80	80	M14	37	390		4280	20	214	410389	6970	20	348		15560	20	778
DVA.4-100-40-SST-M16-41-55	100	40	M16	41	570		9430	10	943	410391	12110	10	1211		24190	10	2419
DVA.4-100-50-SST-M16-41-55	100	50	M16	41	655		8320	13	666	410393	14040	13	1123		22900	13	1832
DVA.4-100-60-SST-M16-41-55	100	60	M16	41	830		7440	15	496	410395	12950	15	863		21450	15	1430
DVA.4-125-55-SST-M16-41-55	125	55	M16	41	1055		19700	14	1433	410396	23790	14	1730		25000	14	2212
DVA.4-125-75-SST-M16-41-55	125	75	M16	41	1425		17600	19	939	410397	20123	19	1073		24780	19	1322



Vibration damping elements