



- 1
- 2
- 3
- 4
- 5
- 6
- 7
- 8
- 9
- 10
- 11
- 12
- 13
- 14
- 15
- 16
- 17
- 18

STANDARD EXECUTIONS

- **DVA.3:** bushings with threaded blind holes and base plate in polished zinc-plated steel, vibration-damper body in natural rubber NR, black colour, hardness 40, 55, 70 Shore A ±5.
- **DVA.3-SST:** bushings with threaded blind holes and base plate in INOX AISI 304 stainless steel, vibration-damper body in natural rubber NR, black colour, hardness 55 Shore A ±5.

FEATURES AND APPLICATIONS

The rubber buffers have been designed to damp vibrations, shocks and noises produced by moving bodies or non-balanced vibrating masses of equipment and machines which can cause:

- malfunctioning and reduction of the machine lifespan and/or of the adjacent ones;
- damage to health;
- noise.

Load diagrams for each single code are available on request. See Technical data and guidelines for the choice (on page 728).

SPECIAL EXECUTIONS ON REQUEST

Natural rubber NR, hardness 40, 70 tolerance ±5 Shore A for executions with AISI 304 stainless steel base.

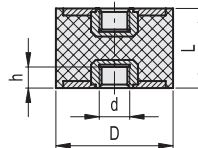

DVA.3

* Complete the description with the desired hardness: 40, 55 or 70 tolerance ±5 Shore A.

DVA.3 - 8 - 8 - M3 - 55
 D L d Shore A

Conversion Table					
1 mm = 0.039 inch					
D			L		
mm	inch	mm	inch	mm	inch
8	0.31	60	2.34	8	0.31
10	0.39	70	2.73	10	0.39
15	0.59	75	2.93	13	0.51
16	0.62	80	3.12	15	0.59
20	0.78	100	3.90	20	0.78
25	0.98	125	4.88	25	0.98
30	1.17	150	5.85	30	1.17
40	1.56	200	7.80	35	1.37
50	1.95	40	1.56		



DVA.3

Description	D	L	d	h	△	Hardness 40 Shore A			Hardness 55 Shore A			Hardness 70 Shore A					
						Code	Max load [N]	Max deflection [mm]	Stiffness [N/mm]	Code	Max load [N]	Max deflection [mm]	Stiffness [N/mm]	Code	Max load [N]	Max deflection [mm]	Stiffness [N/mm]
DVA.3-8-8-M3*	8	8	M3	3	1	414801	50	2	25	412301	85	2	43	417501	150	2	75
DVA.3-8-13-M3*	8	13	M3	3	2	414805	41	3	13	412305	74	3	23	417505	152	3	47
DVA.3-10-10-M4*	10	10	M4	4	2	414811	75	3	30	412321	100	3	40	417511	200	3	80
DVA.3-10-15-M4*	10	15	M4	4	3	414821	65	4	17	412326	100	4	27	417521	150	4	40
DVA.3-10-20-M4*	10	20	M4	4	3	414823	54	5	11	412329	108	5	22	417523	201	5	40
DVA.3-15-10-M4*	15	10	M4	4	4	414831	210	2	105	412331	325	2	163	417531	717	2	359
DVA.3-15-15-M4*	15	15	M4	4	6	414841	155	4	41	412341	280	4	75	417541	513	4	137
DVA.3-15-20-M4*	15	20	M4	4	8	414851	151	5	30	412346	234	5	47	417551	468	5	94
DVA.3-16-15-M5*	16	15	M5	5	10	414854	752	4	200	412348	2137	4	570	417555	2900	4	773
DVA.3-16-20-M5*	16	20	M5	5	12	414855	290	5	58	412349	330	5	66	417557	655	5	131
DVA.3-20-15-M6*	20	15	M6	6	13	414861	175	2	117	412351	227	2	151	417561	550	2	367
DVA.3-20-20-M6*	20	20	M6	6	16	414871	220	5	44	412361	430	5	86	417571	995	5	199
DVA.3-20-25-M6*	20	25	M6	6	19	414881	264	6	42	412371	433	6	69	417581	1010	6	162
DVA.3-25-20-M6*	25	20	M6	6	26	414891	391	5	78	412381	620	5	124	417591	1533	5	307
DVA.3-25-25-M6*	25	25	M6	6	29	414901	441	6	71	412386	529	6	85	417601	1374	6	220
DVA.3-25-30-M6*	25	30	M6	6	25	414911	432	8	58	412391	524	8	70	417611	1208	8	161

Vibration damping elements

* Complete the description with the desired hardness:
40, 55 or 70 tolerance ± 5 Shore A.



DVA.3

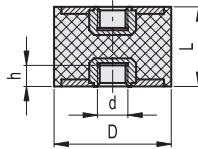

Conversion Table							
1 mm = 0.039 inch							
D				L			
mm	inch	mm	inch	mm	inch	mm	inch
8	0.31	60	2.34	8	0.31	45	1.76
10	0.39	70	2.73	10	0.39	50	1.95
15	0.59	75	2.93	13	0.51	55	2.15
16	0.62	80	3.12	15	0.59	60	2.34
20	0.78	100	3.90	20	0.78	75	2.93
25	0.98	125	4.88	25	0.98	100	3.90
30	1.17	150	5.85	30	1.17	35	1.37
40	1.56	200	7.80	40	1.56		
50	1.95			40	1.56		

DVA.3

METRIC

Description	D	L	d	h	△	Hardness 40 Shore A			Hardness 55 Shore A			Hardness 70 Shore A					
						Code	Max load [N]	Max deflection [mm]	Stiffness [N/mm]	Code	Max load [N]	Max deflection [mm]	Stiffness [N/mm]	Code	Max load [N]	Max deflection [mm]	Stiffness [N/mm]
DVA.3-30-20-M8*	30	20	M8	8	39	414921	770	1	1100	412401	1067	1	1524	417621	2260	1	3229
DVA.3-30-25-M8*	30	25	M8	8	42	414926	4490	6	718	412411	8370	6	1339	417626	12630	6	2021
DVA.3-30-30-M8*	30	30	M8	8	45	414931	500	8	67	412421	1055	8	141	417631	1960	8	261
DVA.3-30-40-M8*	30	40	M8	8	53	414941	700	10	70	412431	2100	10	210	417641	2400	10	240
DVA.3-40-20-M8*	40	20	M8	8	64	414950	815	3	255	412440	2650	5	530	417650	6200	2	2818
DVA.3-40-30-M8*	40	30	M8	8	80	414951	1137	8	152	412441	1574	8	210	417651	3420	8	456
DVA.3-40-40-M8*	40	40	M8	8	98	414961	1056	10	106	412461	1397	10	140	417661	3190	10	319
DVA.3-50-30-M10*	50	30	M10	10	125	414971	2010	8	268	412463	3300	8	440	417671	5450	8	727
DVA.3-50-35-M10*	50	35	M10	10	138	414976	2450	9	280	412464	2530	9	289	417676	5840	9	667
DVA.3-50-40-M10*	50	40	M10	10	150	414981	1477	10	148	412466	2130	10	213	417681	4940	10	494
DVA.3-50-50-M10*	50	50	M10	10	125	414991	1500	11	133	412469	2188	11	194	417691	4750	11	422
DVA.3-60-30-M10*	60	30	M10	10	189	415001	3020	8	403	412471	4170	8	556	417701	9130	8	1217
DVA.3-60-40-M10*	60	40	M10	10	220	415011	2520	10	252	412476	3610	10	361	417711	6950	10	695
DVA.3-60-50-M10*	60	50	M10	10	310	415013	2930	13	234	412479	3410	13	273	417713	7125	13	570
DVA.3-70-30-M10*	70	30	M10	10	305	415020	3168	4	792	412480	4900	4	1225	417720	7250	3	2417
DVA.3-70-35-M10*	70	35	M10	10	315	415022	22540	9	2576	412482	8540	9	976	417693	15940	9	1822
DVA.3-70-45-M10*	70	45	M10	10	335	415021	3810	11	339	412481	7130	11	624	417721	13210	11	1174
DVA.3-70-50-M10*	70	50	M10	10	345	415023	3700	12	296	412491	5750	12	460	417694	14960	12	1197
DVA.3-75-30-M12*	75	30	M12	12	320	415030	6880	3	2293	412500	9895	3	3192	417730	25000	5	5000
DVA.3-75-40-M12*	75	40	M12	12	360	415031	4910	10	491	412501	6970	10	697	417731	11880	8	1485
DVA.3-75-50-M12*	75	50	M12	12	375	415036	4120	12	330	412511	7110	12	569	417696	17900	12	1432
DVA.3-75-55-M12*	75	55	M12	12	445	415041	3470	14	252	412521	7510	14	546	417741	11240	14	817
DVA.3-80-70-M14*	80	70	M14	14	460	415046	4260	18	243	412531	7500	17	428	417698	13010	18	743
DVA.3-100-40-M16*	100	40	M16	16	690	415051	13990	10	1399	412541	20000	10	2000	417751	29000	10	2900
DVA.3-100-55-M16*	100	55	M16	16	765	415061	7320	14	532	412551	13080	14	951	417761	24260	14	1764
DVA.3-100-60-M16*	100	60	M16	16	885	415071	7000	15	467	412561	11290	15	753	417771	28500	15	1900
DVA.3-100-75-M16*	100	75	M16	16	965	415081	7790	19	415	412581	9640	19	514	417781	22350	19	1192
DVA.3-125-55-M16*	125	55	M16	16	1320	415091	18240	14	1327	412591	19260	14	1401	417791	25000	8	3185
DVA.3-125-75-M16*	125	75	M16	16	1500	415093	13380	19	714	412593	19440	19	1037	417793	23751	19	1267
DVA.3-150-55-M20*	150	55	M20	20	1750	415095	9070	5	1814	412601	27900	9	3100	417801	23350	5	4670
DVA.3-150-75-M20*	150	75	M20	20	1825	415097	18650	19	995	412611	27600	16	1725	417803	28600	10	2860
DVA.3-200-100-M20*	200	100	M20	20	1900	415101	5490	5	1098	412631	28000	10	2667	417821	28400	7	4176



Vibration damping elements



DVA.3 - 8 - 8 - SST - M3 - 55
 D L Stainless steel d Shore A

DVA.3-SST

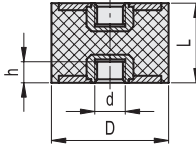

INOX STAINLESS STEEL METRIC

DVA.3-SST

Description	D	L	d	h	⚖️	Hardness 40 Shore A			Hardness 55 Shore A			Hardness 70 Shore A					
						Code	Max load [N]	Max deflection [mm]	Stiffness [N/mm]	Code	Max load [N]	Max deflection [mm]	Stiffness [N/mm]	Code	Max load [N]	Max deflection [mm]	Stiffness [N/mm]
DVA.3-8-8-SST-M3-55	8	8	M3	3	1		50	2	25	410201	85	2	43		150	2	75
DVA.3-8-13-SST-M3-55	8	13	M3	3	2		41	3	13	410203	74	3	23		152	3	47
DVA.3-10-10-SST-M4-55	10	10	M4	4	2		75	3	30	410205	100	3	40		200	3	80
DVA.3-10-15-SST-M4-55	10	15	M4	4	3		65	4	17	410207	100	4	27		150	4	40
DVA.3-10-20-SST-M4-55	10	20	M4	4	3		54	5	11	410209	108	5	22		201	5	40
DVA.3-15-10-SST-M4-55	15	10	M4	4	4		210	2	105	410213	325	2	163		717	2	359
DVA.3-15-15-SST-M4-55	15	15	M4	4	6		155	4	41	410215	280	4	75		513	4	137
DVA.3-15-20-SST-M4-55	15	20	M4	4	8		151	5	30	410217	234	5	47		468	5	94
DVA.3-16-15-SST-M5-55	16	15	M5	5	10		752	4	200	410219	2137	4	570		2900	4	773
DVA.3-16-20-SST-M5-55	16	20	M5	5	12		290	5	58	410220	330	5	66		655	5	131
DVA.3-20-15-SST-M6-55	20	15	M6	6	13		175	2	117	410221	227	2	151		550	2	367
DVA.3-20-20-SST-M6-55	20	20	M6	6	16		220	5	44	410223	430	5	86		995	5	199
DVA.3-20-25-SST-M6-55	20	25	M6	6	19		264	6	42	410225	433	6	69		1010	6	162
DVA.3-25-20-SST-M6-55	25	20	M6	6	26		391	5	78	410231	620	5	124		1533	5	307
DVA.3-25-25-SST-M6-55	25	25	M6	6	29		441	6	71	410233	529	6	85		1374	6	220
DVA.3-25-30-SST-M6-55	25	30	M6	6	25		432	8	58	410237	524	8	70		1208	8	161
DVA.3-30-20-SST-M8-55	30	20	M8	8	39		770	1	1100	410241	1067	1	1524		2260	1	3229
DVA.3-30-25-SST-M8-55	30	25	M8	8	42		4490	6	718	410242	8370	6	1339		12630	6	2021
DVA.3-30-30-SST-M8-55	30	30	M8	8	45		500	8	67	410243	1055	8	141		1960	8	261
DVA.3-30-40-SST-M8-55	30	40	M8	8	53		700	10	70	410245	2100	10	210		2400	10	240
DVA.3-40-20-SST-M8-55	40	20	M8	8	64		815	3	255	410251	2650	5	530		6200	2	2818
DVA.3-40-30-SST-M8-55	40	30	M8	8	80		1137	8	152	410253	1574	8	210		3420	8	456
DVA.3-40-40-SST-M8-55	40	40	M8	8	98		1056	10	106	410255	1397	10	140		3190	10	319
DVA.3-50-30-SST-M10-55	50	30	M10	10	125	ON REQUEST	2010	8	268	410263	3300	8	440	ON REQUEST	5450	8	727
DVA.3-50-35-SST-M10-55	50	35	M10	10	138		2450	9	280	410264	2530	9	289		5840	9	667
DVA.3-50-40-SST-M10-55	50	40	M10	10	150		1477	10	148	410265	2130	10	213		4940	10	494
DVA.3-50-50-SST-M10-55	50	50	M10	10	129		1500	11	133	410269	2188	11	194		4750	11	422
DVA.3-60-30-SST-M10-55	60	30	M10	10	185		3020	8	403	410271	4170	8	556		9130	8	1217
DVA.3-60-40-SST-M10-55	60	40	M10	10	220		2520	10	252	410273	3610	10	361		6950	10	695
DVA.3-60-50-SST-M10-55	60	50	M10	10	310		2930	13	234	410275	3410	13	273		7125	13	570
DVA.3-70-30-SST-M10-55	70	30	M10	10	305		3168	4	792	410276	4900	4	1225		7250	3	2417
DVA.3-70-35-SST-M10-55	70	35	M10	10	315		22540	9	2576	410278	8540	9	976		15940	9	1822
DVA.3-70-45-SST-M10-55	70	45	M10	10	335		3810	11	339	410277	7130	11	624		13210	11	1174
DVA.3-70-50-SST-M10-55	70	50	M10	10	345		3700	12	296	410279	5750	12	460		14960	12	1197
DVA.3-75-30-SST-M12-55	75	30	M12	12	320		6880	3	2293	410281	9895	3	3192		25000	5	5000
DVA.3-75-40-SST-M12-55	75	40	M12	12	360		4910	10	491	410283	6970	10	697		15380	10	1538
DVA.3-75-50-SST-M12-55	75	50	M12	12	375		4120	12	330	410284	7110	12	569		17900	12	1432
DVA.3-75-55-SST-M12-55	75	55	M12	12	445		3470	14	252	410285	7510	14	546		11240	14	817
DVA.3-80-70-SST-M14-55	80	70	M14	14	460		4260	18	243	410288	7500	17	429		13010	18	743
DVA.3-100-40-SST-M16-55	100	40	M16	16	690		13990	10	1399	410291	20000	10	2000		29000	10	2900
DVA.3-100-55-SST-M16-55	100	55	M16	16	765		7320	14	532	410293	13080	14	951		24260	14	1764
DVA.3-100-60-SST-M16-55	100	60	M16	16	885		7000	15	467	410295	11290	15	753		28500	15	1900
DVA.3-100-75-SST-M16-55	100	75	M16	16	965		7790	19	415	410297	9640	19	514		22350	19	1192
DVA.3-125-55-SST-M16-55	125	55	M16	16	1320		18240	14	1327	410298	19260	14	1401		25000	8	3185
DVA.3-125-75-SST-M16-55	125	75	M16	16	1500		13380	19	714	410299	19440	19	1037		23751	19	1267
DVA.3-150-55-SST-M20-55	150	55	M20	20	1750		9070	5	1814	410300	27900	9	3100		23350	5	4670
DVA.3-150-75-SST-M20-55	150	75	M20	20	1825		18650	19	995	410302	27600	16	1725		28600	10	2860
DVA.3-200-100-SST-M20-55	200	100	M20	20	1900		5490	5	1098	410304	28000	10	2667		28400	7	4176

Vibration damping elements