

REVISIONS			
REV	DESCRIPTION	DATE	APPV
A	PRODUCTION RELEASE	JHAGER 11/17/20	DV 03/02/21

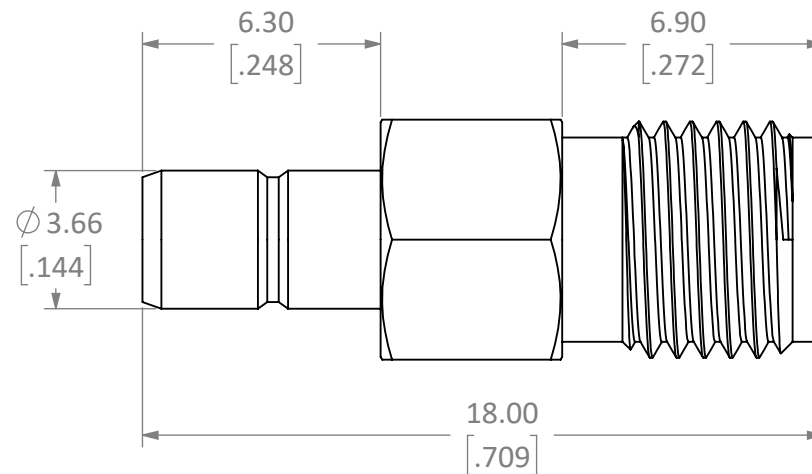
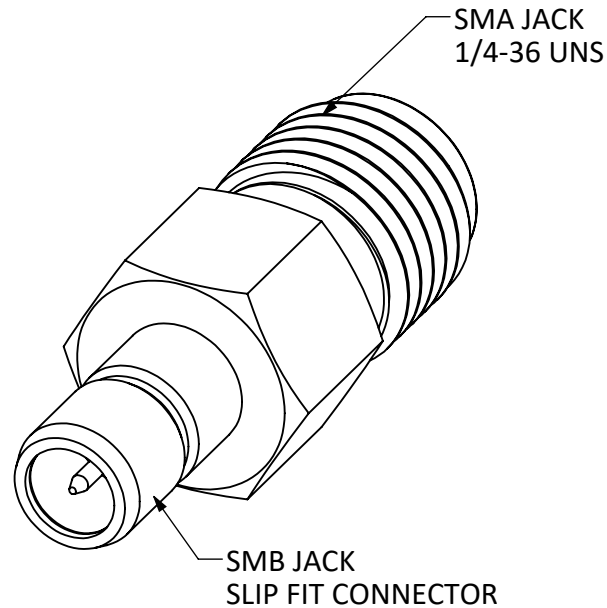

NOTES: (UNLESS OTHERWISE SPECIFIED)

- ALL DIMENSIONS ARE IN MILLIMETERS [IN].
- DIMENSIONS APPLY AFTER FINISHING.
- MANUFACTURE TO BE COMPLIANT WITH EU RoHS DIRECTIVE, USE MATERIALS THAT DO NOT CONTAIN REACH SUBSTANCES OF VERY HIGH CONCERN >1000ppm, AND USE DRC CONFLICT-FREE SOURCED MATERIALS.
- IMPEDANCE: 50Ω
- FREQUENCY RANGE: 0-4GHz
- VSWR: 1.3 dBm MAX
- INTERFACE IAW MIL-STD-348B
- OPERATING TEMP: -65° - 165°C
- DURABILITY: 500 Min.

WARNING: THIS DRAWING CONTAINS PROPRIETARY INFORMATION THAT IS THE SOLE PROPERTY OF LINX TECHNOLOGIES, AND SHALL BE TREATED AS SUCH. NO DISCLOSURE OR REPRODUCTION OF THIS DOCUMENT IS PERMITTED, IN WHOLE OR IN PART, WITHOUT THE EXPRESS WRITTEN PERMISSION OF LINX TECHNOLOGIES OR ITS DESIGNATED AGENTS.

MATERIAL:	INTERPRET DIMENSIONS AND TOLERANCES PER ASME Y14.5.		PROJECTION:
BRASS	.X ±2.0	ANGLES: ±1°	
BeCu	.XX ±1.00	SURFACE: √	
	.XXX ±.500		
FINISH:	DRAWN: JHAGER	DT: 11/17/20	
GOLD	ENGR: DASARATHAN	DT: 11/17/20	



159 ORT LANE
MERLIN, OR 97532

TITLE:
**ADAPTER SMA F
TO SMB F BRAS/GOLD**

SIZE	DWG. NO.	REV
A	C-ADP-SMAF-SMBF-G	A
SCALE: 5:1	DO NOT SCALE DRAWING	SHEET 1 OF 1