

P	LTR	DESCRIPTION	DATE	DWN	APVD
	B	REV PER ECO 16-010602	7-29-16	CT	DW

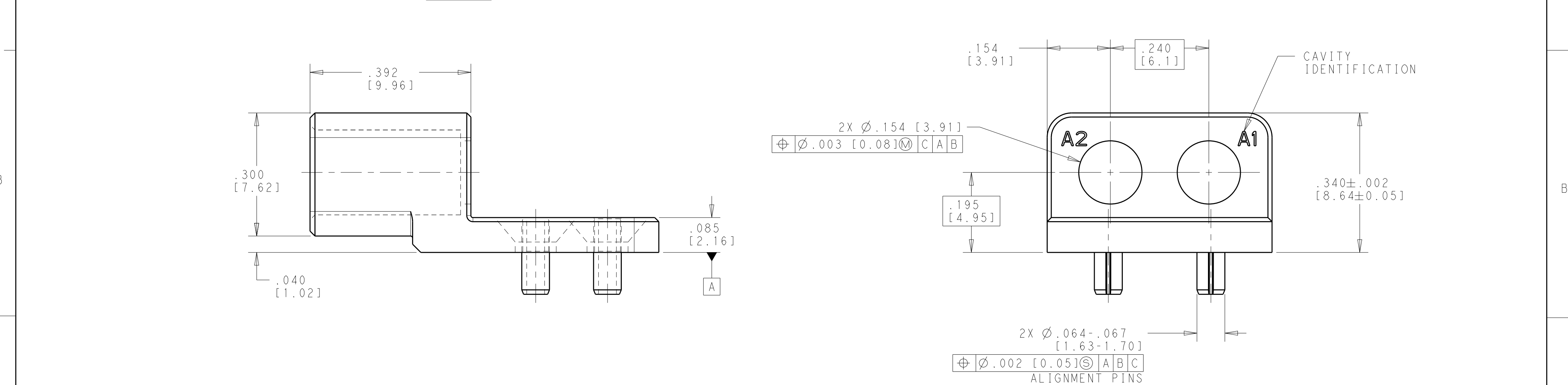
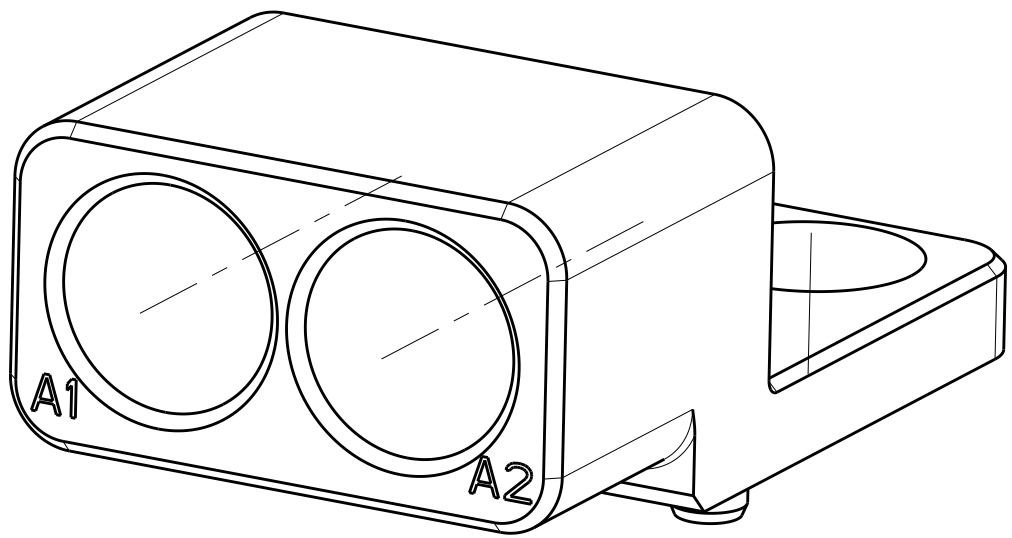
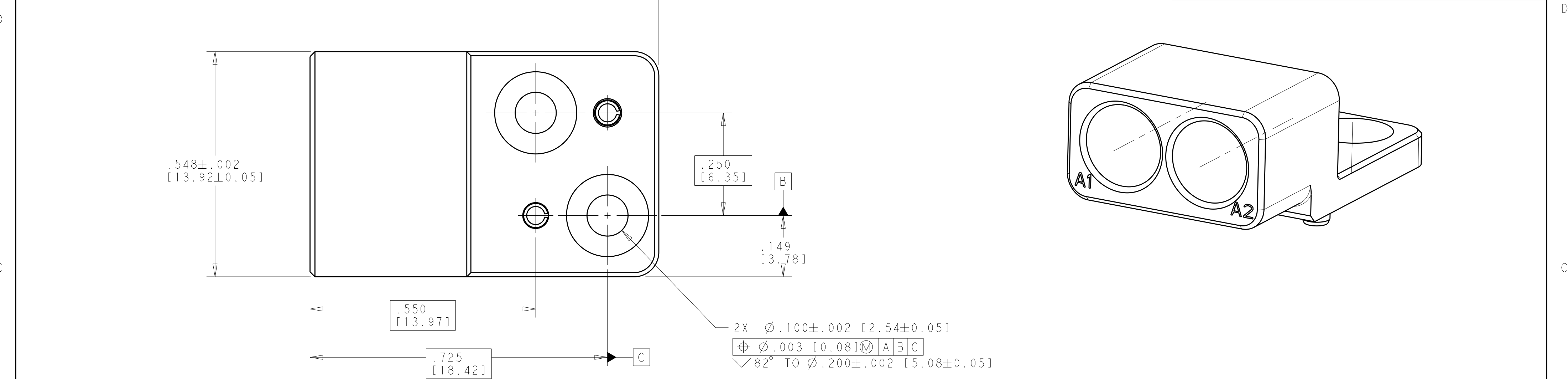

			2221705-4	
			PART NUMBER	

COMPONENT	MATERIAL	FINISH	THIS DRAWING IS A CONTROLLED DOCUMENT.				TE Connectivity			
RF MODULE BODY	STAINLESS STEEL, TYPE 303 PER UNS S 30300	PASSIVATED PER, AMS QQ-P-35	DIMENSIONS: INCHES [mm]	TOLERANCES UNLESS OTHERWISE SPECIFIED:	DWN S. T. Morley 26 JAN 2015	CHK S. T. Morley 26 JAN 2015	NAME 2 POSITION, SINGLE ROW RF DAUGHTER CARD MODULE			
SPRING PIN (ALIGNMENT)	WORK HARDENED NICKEL STAINLESS STEEL	PASSIVATED PER, AMS QQ-P-35			APVD S. T. Morley 26 JAN 2015	PRODUCT SPEC TBD				
			MATERIAL SEE TABLE	FINISH SEE TABLE	APPLICATION SPEC TBD	WEIGHT 7.8 g	SIZE A2	CAGE CODE -	DRAWING NO. ©-2221705	RESTRICTED TO -
			Customer Drawing				SCALE 6:1	SHEET 1 OF 1	REV B	