

## Hot air blower COMPACT max. 6'100W

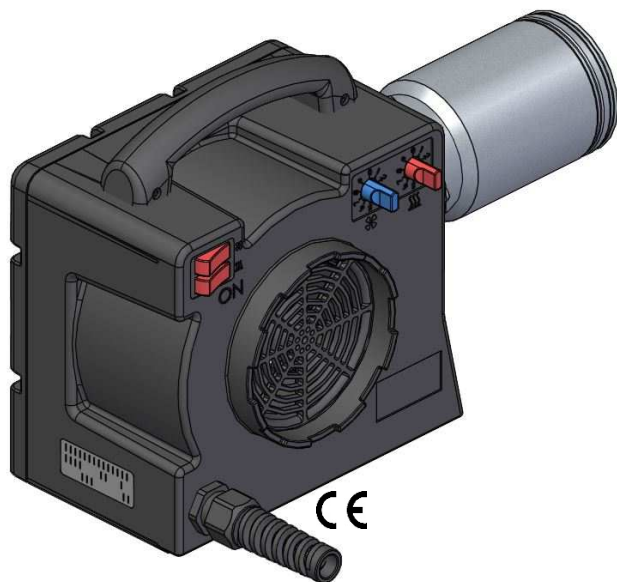

- Function:** Hot air blowers for industrial use
- small dimensions great power
- Configuration:** Default: Temperature control with potentiometer (0 - 9)
- alternatively with external potentiometer (cable length 5 meters) or
  - external control by controller or PLC (cable length 5 meters)
- The unit is equipped with a reliable heating element, the integrated device protection turns off the device when tripped and restore itself back after cooling. No reset is required.
- Features:** Default: Variable air volume control with potentiometer (0 - 9)
- alternatively with external potentiometer (cable length 5 meters) or
  - external control by controller or PLC (cable length 5 meters)
- Custom design with internal thermocouple (cable length 1 or 5 meters)
- For devices with electronics maximum air temperature 50°C/122°F
  - The unit is available without electronics
  - For devices without electronics maximum air temperature 80°C/176°F
  - Special design with internal temperature control
  - Evaluating the fan speed via "open collector"
- Power:** 2,3 KW - 6,1 KW
- Voltage:** 230 / 400V<sub>AC</sub> (2Ph)

### Technical data

| Item number / Basic version                    |                 | 5102586             | 5102602     | 5102581     | 5102605     | 5102599  |
|--|-----------------|---------------------|-------------|-------------|-------------|----------|
| <b>Voltage</b>                                 | V <sub>AC</sub> | 230                 |             |             | 400 (2Ph+N) |          |
| <b>Frequency</b>                               | Hz              | 50 / 60             |             |             |             |          |
| <b>Power</b>                                   | kW              | 2,3                 | 3,1         | 3,7         | 4,7         | 6,1      |
| <b>Current</b>                                 | A               | 10,0                | 13,5        | 16,0        | 11,8        | 15,3     |
| <b>Max. temperaturer</b>                       | °C/°F           | 650/1202            | 800/1472    | 650/1202    |             |          |
| <b>Min. air quantity</b>                       | l/min           | 400                 | 350         | 400         |             | 550      |
| <b>Max. air quantity at 20°C</b>               | l/min           | 940                 | 800         | 930         | 960         | 950      |
| <b>Max. Temperature with full air quantity</b> | °C/°F           | 260/500             | 520/968     | 440/824     | 480/896     | 630/1166 |
| <b>Static pressure</b>                         | Pa              | 450                 |             |             |             |          |
| <b>Sound pressure levell (LpA)</b>             | db              | 73 (at 1m distance) |             |             |             |          |
| <b>Intake opening</b>                          | Ø mm            | 102,5               |             |             |             |          |
| <b>Air outlet</b>                              | Ø mm            | 55                  |             |             |             |          |
| <b>Heating element tube</b>                    | Ø mm            | 62 / 74             |             |             |             |          |
| <b>Dimensions (L x W x H)</b>                  | mm              | 325x136x180         | 365x136x180 | 325x136x180 | 365x136x180 |          |
| <b>Weight incl. Cable</b>                      | kg              | 2,8                 | 3,1         | 2,8         | 3,1         |          |
| <b>Conformity mark</b>                         |                 | CE                  |             |             |             |          |
| <b>Protection class II</b>                     |                 | □                   |             |             |             |          |

### Power curve

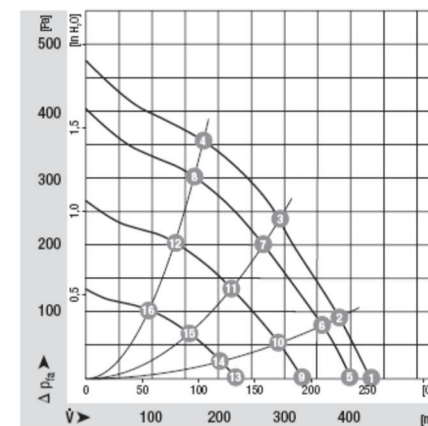

Hot air blower COMPACT max. 6'100W

1. Power cable  
Connection diagram for 400V<sub>AC</sub> version:  
- L1 = black  
- L2 = brown  
- N = blue
2. Heating ON- OFF (only if the fan switch (3) is ON)
3. Fan ON – OFF
4. Handle, pushed laterally (fixed with two screws)
5. Potentiometer for speed/air volume  
- Cable gland for control line for external control (Option)
6. Heating control potentiometer  
- Cable gland for control line for external control (Option)
7. Label (rear panel)
8. Heater tube
9. Intake
10. Temperature controller (optional)  
- Cable gland for signal line for pulse output (option)
11. 6 threaded inserts M5 for mounting the unit during installation (dimensions on the device base)











|  |                        |   |  |
|--|------------------------|---|--|
| <u>Control cable for external temperature control</u><br>- digital signal (PWM 10-24 V <sub>DC</sub> , 0.5 Hz)   | + = brown<br>- = white | <u>Control cable with external potentiometer for temperature- or speed control:</u> |  |
| <u>Control cable for external speed control:</u><br>- digital rpm = 15V <sub>DC</sub> , I <sub>max</sub> = 10mA;<br>- PWM/1-10KHz/50-100% (50% = minimum amount of air)<br>- analog 5-10 V <sub>DC</sub> (5 V <sub>DC</sub> = minimum amount of air) | + = green<br>- = white |   |  |
| <b>WARNING. "Must be guaranteed at analog or digital control of the speed that the minimum amount of air-flow is brought forward when the heat is on!"</b>   |                        |   |  |
| <u>Signal line for external speed display:</u><br>- 1 pulse per turn<br>- Open collector output  | + = brown<br>- = white | Compensation line with internal thermocouple type K':<br>+ = green<br>- = white     |  |

### Hot air blower COMPACT max. 6'100W

#### Available modifications:

| Item number | Type | Modification  |
|-------------|------|---|
| 5005006     | S01  | External heating control incl. 5 meter 2-wire control cable; PWM signal (5-24V <sub>DC</sub> , maximum cycle time 1Hz); control cable 2-wire: brown (+) white (-); cable ends are marked;   |
| 5005005.2   | S02  | External potentiometer for heating incl. 5 meter control cable; 3-wire; potentiometer is soldered to the end of the cable; incl. potentiometer knob red;  |
| 5005005.3   | S29  | External potentiometer for blower speed; incl. 5 meter control cable; 3-wire; potentiometer is soldered to the end of the cable; incl. potentiometer knob blue;   |
| 5005009     | S04  | External control for blower speed incl. 5 meter control cable; control signal analogue: 0-10V <sub>DC</sub> ; control signal digital: PWM 1-10kHz; 12-24V <sub>DC</sub> ; I <sub>max.</sub> 10mA; control cable 3-wire; green (+) white (-) brown (not used); cable ends are marked;  |
| 5005021.8   | S05  | Internal PID control of the temperature without visualization for basic units with potentiometer;   |
| 5005021.9   |      | Internal PID control of the temperature without visualization for basic units with potentiometer; <b>!!! For Compact L !!!</b>  |
| 5005010.3   | S06  | Internal thermocouple with 2 meter compensation lin with open cable ends green (+) white (-);   |
| 5005010.8   |      | Internal thermocouple with 2 meter compensation lin with open cable ends green (+) white (-); <b>!!! For Compact L !!!</b>  |
| 5005018     | S07  | Compact 230V <sub>AC</sub> with 3-pin connection cable with open ends; black (heating), brown (blower), blue (neutral); the double rocker switch is replaced by a double control lamp;  |
| 5005020     | S08  | The fan speed is fixed and cannot be adjusted from the outside;   |
| 5005016.1   | S09  | Compact with internal thermocouple and digital controller;  |
| 5005016.3   |      |   |
| 5700128     | S30  | Compact 230 V <sub>AC</sub> with internal thermocouple, digital controller and potential-free alarm output;   |
| 5000120     | S10  | Compact also has a handle on the back of the housing to hold the device with two hands;   |
| 5005004     | S11  | With the Compact 400V <sub>AC</sub> , the blower is separated from the heater via a separate connection; the double rocker switch is replaced by a double control lamp; Delivery standard is without connection cable; Alternatively, the device is available with a 4-pin connection cable:<br>Terminal: N + L1 (blower 230V <sub>AC</sub> ) L2 + L3 (heater 400V <sub>AC</sub> );<br>Cable: blue (N) black (L1) brown (L2) gray (L3); |
| 5005022     | S18  | Instead of the kink protection spiral, a normal cable gland is screwed inside the Compact; the cable outlet is milled out in a funnel shape to avoid a cable break; the handle is omitted;  |
| 5005034     | S21  | Compact with 5m control line for evaluating the fan speed; Control cable: brown (+) white (-); Signal: 1 pulse/turn;  |
| 5700017     | S24  | The heating output is fixed and cannot be adjusted from the outside;<br><b>Please specify the desired heating output in% when ordering!</b>   |
| 5700161     | S32  | Klixon receives another assembly position ref. 2 ..   |

### Hot air blower COMPACT max. 6'100W

| Accessories  | Description  | Item-No. |
|--|--|----------|
|   | Flange connection  | 5107246  |
|   | Round nozzle Ø 40mm                                      | 5107245  |
|   | Angled nozzle Ø 62mm; length 120 x 112mm                 | 5107265  |
|   | Extension tube Ø 40mm; length = 200mm                    | 5107247  |
|   | Tubular nozzle 700 x 550 x 1,7mm                         | 5107253  |
|   | Wide slot nozzle 85 x 15mm                               | 5107260  |
|   | Wide slot nozzle 150 x 12mm                              | 5107259  |
|   | Wide slot nozzle 200 x 9mm                               | 5105977  |
|  | Wide slot nozzle 250 x 12mm                              | 5107263  |
|  | Wide slot nozzle 300 x 4mm                               | 5107262  |
|  | Wide slot nozzle 500 x 4mm                               | 5105991  |
|   | Shrinking reflector 50 x 400mm; nozzle laterally mounted | 5106177  |
|  | Stainless steel filter for COMPACT suction side          | 5107248  |

Hot air blower COMPACT max. 6'100W

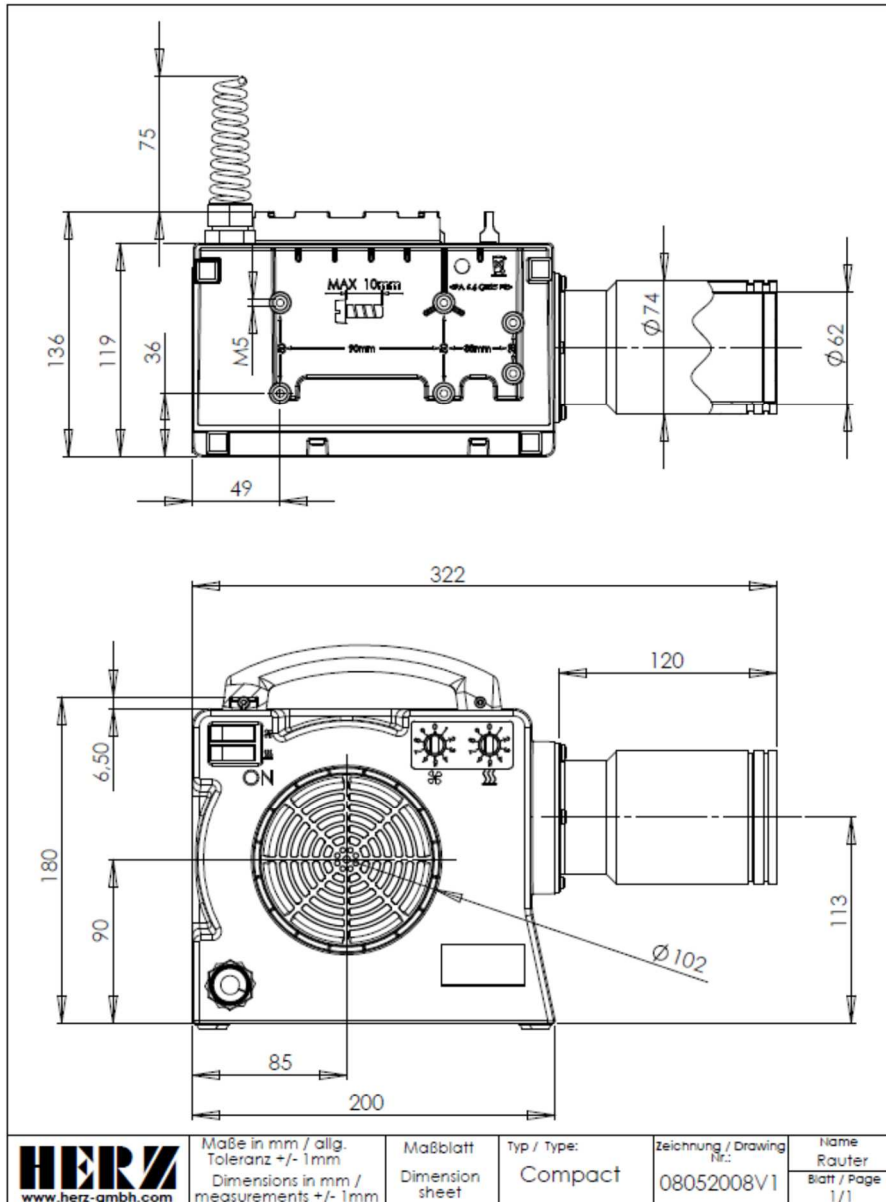

Technische Änderungen vorbehalten / technical changes reserved

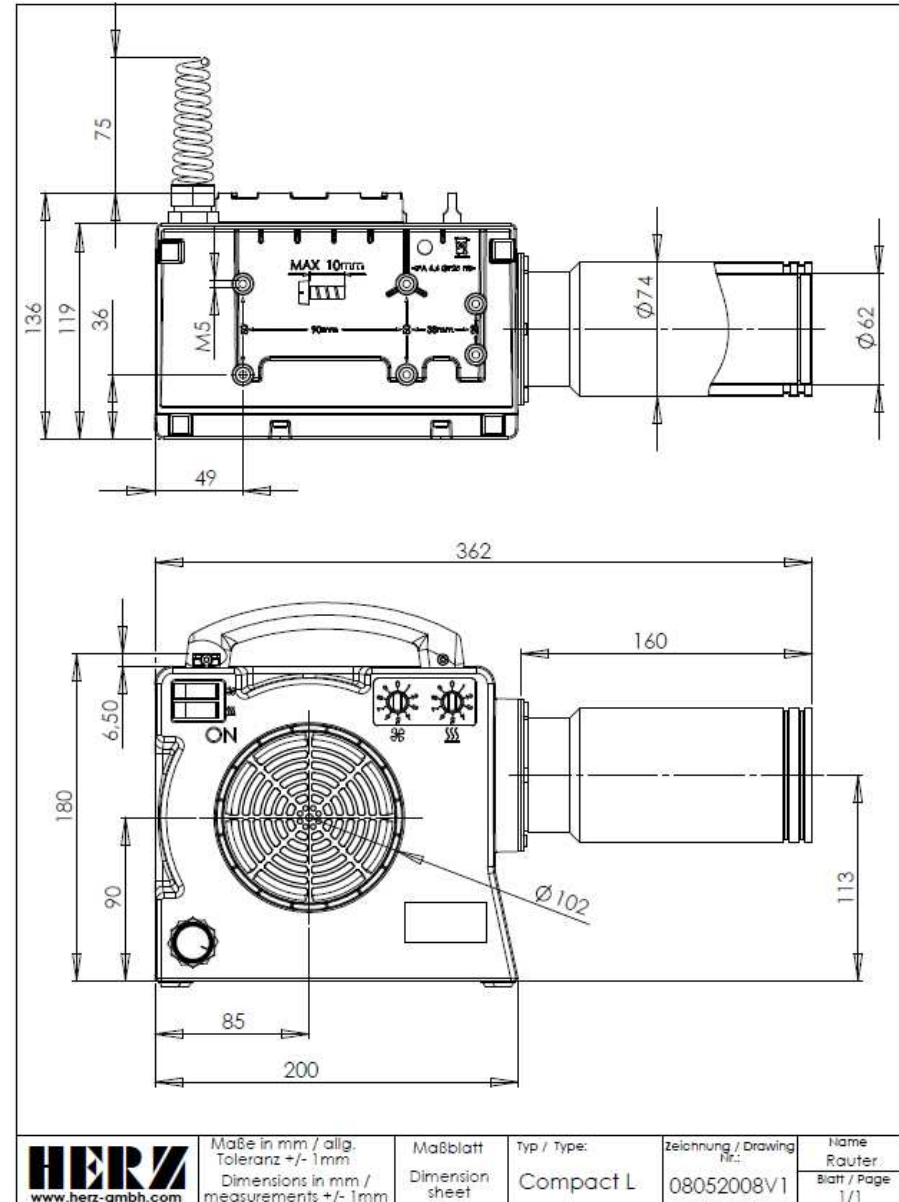

Technische Änderungen vorbehalten / technical changes reserved

## Hot air blower COMPACT max. 6'100W

### **HERZ** GmbH

Kunststoff- & Wärmetechnologie  
Biberweg 1  
DE – 56566 Neuwied  
Tel.: +49 (0)2622-8855-0  
Fax: +49 (0)2622-8855-135  
Fax: +49 (0)2622-8855-136  
www.herz-gmbh.com  
info@herz-gmbh.com

### **HERZ** Austria GmbH

Kunststoff- & Wärmetechnologie  
Gleinser Weg 27  
AT – 6141 Schönberg / Tirol  
Tel.: +43 (0)5225-63113  
Fax: +43 (0)5225-6311385  
www.herz-austria.at  
herz.schoenberg@herz-gmbh.com

### **HERZ** Hungária Kft.

Műanyag- és hőlégtéchnika  
Pesti út 284  
HU – 2225 Üllő  
Tel.: +36 (06)29-522400  
Fax: +36 (06)29-522410  
www.herz-hungaria.hu  
herz@herz-hungaria.hu

### **HERZ** Bulgaria OOD

Boul. Assen Yordanov 10  
BG – 1592 Sofia  
Tel.: +359 (0)2-9790351  
www.herz-bulgaria.com  
office@herz-bulgaria.com

### **HERZ** GmbH

Kunststoff- & Wärmetechnologie  
Am Arenberg 26A  
DE – 86456 Gablingen  
Tel.: +49 (0)8230-85085  
Fax: +49 (0)8230-85087  
www.herz-gmbh.com  
robert.einberger@herz-gmbh.com

### **HERZ** Austria GmbH

Kunststoff- & Wärmetechnologie  
Johann-Galler-Str. 20 IZ – NÖ – Nord  
AT – 2120 Wolkersdorf i. Weinviertel  
Tel.: +43 (0)2245-82494-0  
Fax: +43 (0)2245-82494-9  
www.herz-austria.at  
herz.wolkersdorf@herz-gmbh.com

### **HERZ** Polska Sp.z o. o.

Technologie obróbki tworzyw sztucznych  
Ul. Kostrzyńska 30  
PL – 02-979 Warszawa  
Tel.: +48 (0)22-8428583  
Fax: +48 (0)22-8429700  
www.herz-polska.pl  
herz@herz-polska.pl

