

THREADED DIMPLE

SCREW, 6-32 x .496" LONG
BLACK OXIDE

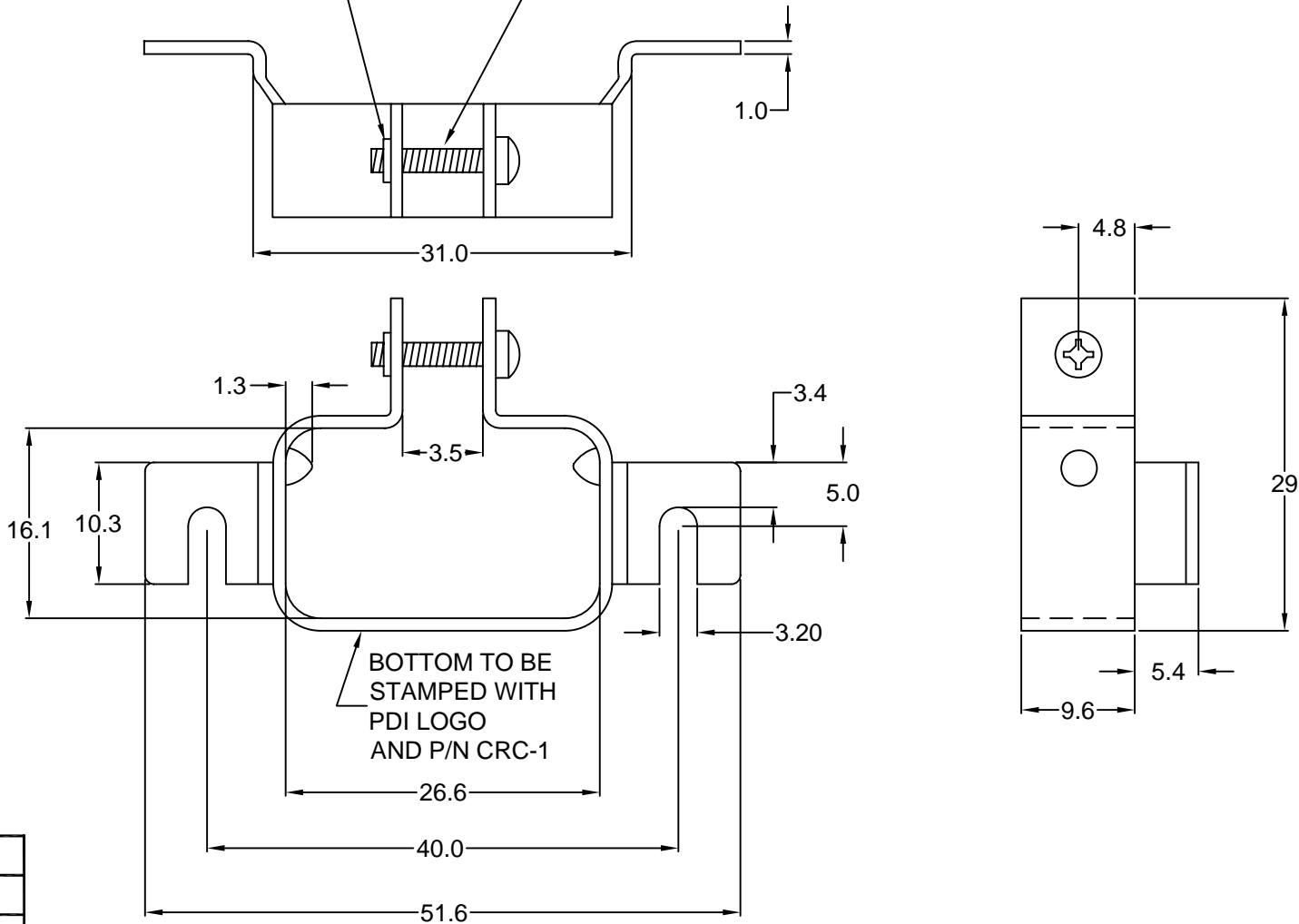

**RoHS
COMPLIANT**

NOTES:
Material: Steel, 1.0mm THK.
Finish: black oxide finish

BREAK AND DEBURR ALL EDGES

REV	DATE	CHANGE	CHNG CHECK APPR			
			SLS	TD	JJ	PB
A	1/89	ADDED 3.5mm RAD.				
B	7/17/00	REVISED	SS	SS	JJ	PB
C	01/02/02	REVISED DRAWING	GO	TD	TD	PB
D	7/24/02	SCREW IS 4-40x1/2"; DIMPLE	PB	TD		
E	3/24/05	SCREW IS 6-32 X .375"	DF			
F	10/26/09	SCREW LENGTH .496"	PB			

TOLERANCE UNLESS OTHERWISE SPECIFIED	
X	± 1
X.X	± 0.4
X.XX	± 0.20

DRAWN BY	SLS	DATE:	7/11/97
CHECK BY	TD	DATE:	9/27/99
APPR BY	JJ	DATE:	9/27/99

Power Dynamics, Inc.
Phone: 973 560-0019 Whippany, New Jersey Fax: 973 560-0076

**PART: IEC CONNECTOR RETAINING CLAMP
FOR IEC 60320 C13**

CRC-1

SIZE: A
SCALE: NTS

ALL DIMENSIONS FOR REFERENCE ONLY
DIMENSIONS ARE IN MILLIMETERS

SHEET 1 of 1
REV: F