

# Quantic™ Evans

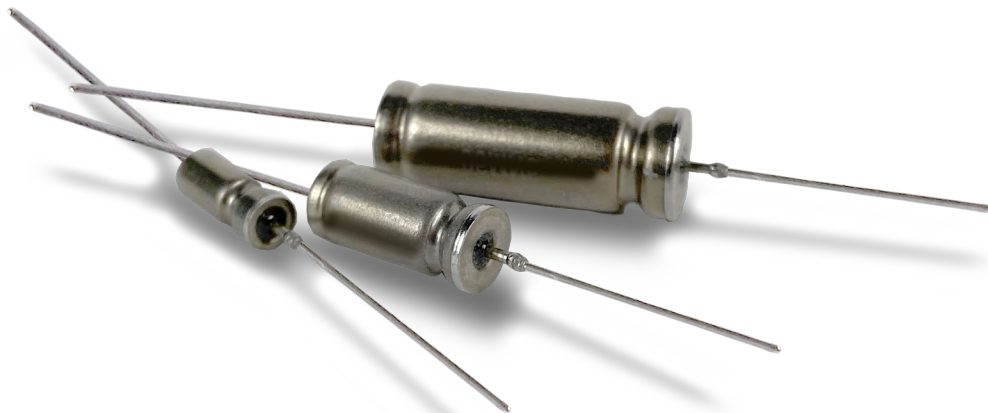

## **CC-HT Series Hybrid Capacitors** Product Datasheet

08.03.2022

### Product Overview

CC-HT series capacitors shall be comprised of sintered tantalum anodes and ruthenium oxide coated cathodes operating in aqueous electrolyte. The components shall be confined within a tantalum case, first by a compressed gasket, followed by a hermetically welded glass to metal seal.

CC-HT capacitors are designed for operation in environments of up to 200°C. For extreme shock environments, HyCap-HTX series offer a robust construction in the largest traditional D(T4) case style. Information available upon request.

### Electrical Specifications

Rated Voltage Range (@200°C)	25VDC to 75VDC
Capacitance Range	22uF to 1800uF
Capacitance Tolerance	±20%

### Mechanical Specifications

Test	Method	Condition	Remarks
Shock	MIL-STD-202 METHOD 213	D	Tested for 1ms at 500g peak
Vibration	MIL-STD-202 METHOD 204	H	12 sweeps/axis, 80g peak
	MIL-STD-202 METHOD 214	II, Letter K	1.5 hours/axis, 53.8g rms
Moisture Resistance	MIL-STD-202 METHOD 106		6V Polarity

Solderability	To ANSI J-STD-002
Operating Temperature Range	-55°C to 200°C with voltage derating (see page 3)
Storage Temperature Range	-62°C to +130°C

### Environmental Compliance

CC-HT Series are RoHS 9/10 compliant to EU RoHS Directive 2015/863

- The standard terminals are 60/40 SnPb plated Nickel Wire
- RoHS 10/10 compliant Lead free leads available. See part numbering nomenclature on page 3 for ordering info.

### Capacitor Life

Capacitors shall be able to withstand either 175°C or 200°C life test (with appropriate voltage derating per the table on page 3) for durations of 500-2000 hours based on the voltage rating.

Contact Evans Capacitor Company to learn more.

## Part Number Description

<b>Product Series</b>	<b>Case Size</b>	<b>Voltage Rating</b>	<b>Cap Rating</b>	<b>HT Series Identifier</b>	<b>Option: ±10% Rating (Standard tolerance ±20%)</b>	<b>Option: Sleeving</b>	<b>Optional: Lead Free</b>
CC-HT	X	XXX	XXX	HT	K	S	LF

## Ratings Table

<b>Part Number</b>	<b>Voltage_ 175°C</b>	<b>Voltage_ 200°C</b>	<b>Cap (µF)</b>	<b>ESR (mΩ)</b>	<b>Height (in)</b>	<b>Mass (g)</b>
CC2A035101HT	30	25	100	2600	0.453	2.25
CC2B035471HT	30	25	470	900	0.641	5.25
CC2D035152HT	30	25	1500	500	1.062	15
CCD040681HT	35	30	680	700	1.062	18
CC2B042331HT	36	30	330	900	0.641	5.25
CC2D042122HT	36	30	1200	500	1.062	15
CC3B042561HT	36	30	560	1300	0.641	5.75
CC3D042182HT	36	30	1800	600	1.062	15
CCD048561HT	42	36	560	800	1.062	18
CC2A053680HT	45	37	68	2800	0.453	2.25
CC2B053221HT	45	37	220	1000	0.641	5.25
CC2D053941HT	45	37	940	600	1.062	15
CC3B053331HT	45	37	330	1500	0.641	5.75
CC3D053122HT	45	37	1200	800	1.062	15
CC4B053391HT	45	37	390	800	0.641	5.75
CCB060111HT	53	45	110	1300	0.641	6
CCD060471HT	53	45	470	900	1.062	18
CC2A070330HT	60	50	33	3000	0.453	2.25
CC2B070151HT	60	50	150	1200	0.641	5.25
CC2D070471HT	60	50	470	700	1.062	15
CC3B070221HT	60	50	220	1000	0.641	5.75
CC3D070681HT	60	50	680	500	1.062	15
CC4B070271HT	60	50	270	1200	0.641	5.75
CC4D053152HT	60	50	1500	600	1.062	15.5
CC4D070881HT	60	50	880	600	1.062	15.5
CCB080680HT	70	60	68	2100	0.641	6
CCD080221HT	70	60	220	1200	1.062	18
CC2A088220HT	75	62	22	3200	0.453	2.25
CC2B088101HT	75	62	100	1800	0.641	5.25
CC2D088331HT	75	62	330	800	1.062	15
CC3B088151HT	75	62	150	1200	0.641	5.75
CC3D088471HT	75	62	470	600	1.062	15
CC4B088181HT	75	62	180	1400	0.641	5.75
CC4D088561HT	75	62	560	700	1.062	15.5
CCD100151HT	88	75	150	1600	1.062	18

**2D Drawing**

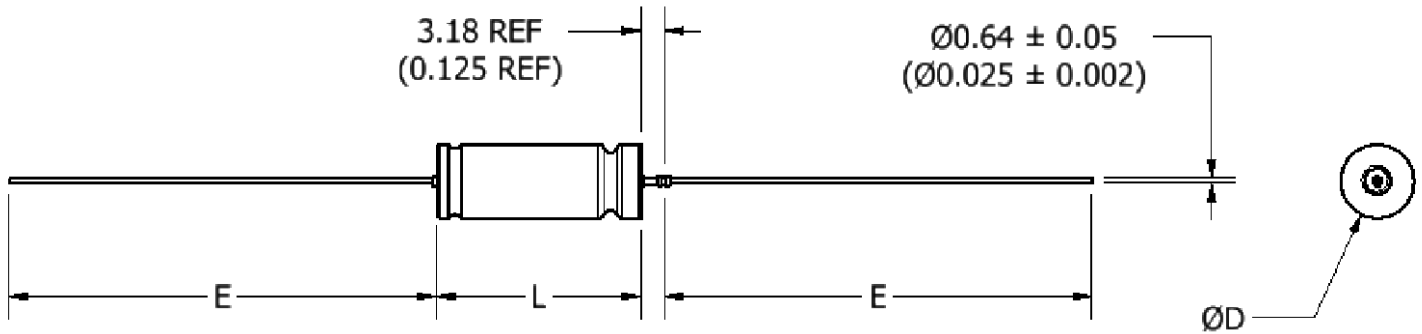

Case Size	Dimensions, mm (in)			
	Basic Case		Insulated Case	E ±6.35 (0.250)
	L +0.79 (0.031) -0.41 (0.016)	D ±0.41 (0.016)	D MAX	
A	11.51 (0.453)	4.78 (0.188)	5.56 (0.219)	38.10 (1.500)
B	16.28 (0.641)	7.14 (0.281)	7.92 (0.312)	57.15 (2.250)
D	26.97 (1.062)	9.52 (0.375)	10.31 (0.406)	57.15 (2.250)
A-LF	11.51 (0.453)	4.78 (0.188)	5.56 (0.219)	25.40 (1.000)
B-LF	16.28 (0.641)	7.14 (0.281)	7.92 (0.312)	25.40 (1.000)
D-LF	26.97 (1.062)	9.52 (0.375)	10.31 (0.406)	25.40 (1.000)