

Surface Mount Termination
45 Watts, 50Ω

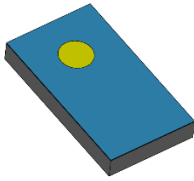

Features:

- RoHS Compliant
- 45 Watts
- DC – 6.0 GHz
- AIN Ceramic
- Non-Nichrome Resistive Element
- Low Return Loss
- 100% Tested
- Small Size

Description:

The C45N50Z4 is a high performance AIN surface mount termination. The termination is well suited to all cellular frequency bands such as; AMPS, GSM, DCS, PCS, PHS and UMTS. The high power handling makes the part ideal for terminating high power 90 degree couplers and for use in microstrip circuits. The termination is also RoHS compliant!

General Specifications:

Resistive Element	Thick film
Substrate	AIN Ceramic
Terminal Finish	Matte Tin over Nickel Barrier
Operating Temperature	-50 to +150°C (see de rating chart)

Electrical Specifications:

Power:	45 Watts
Frequency Range:	DC – 6.0 GHz
Return Loss:	>20 dB DC – 5.0 GHz >15 dB 5.0 – 6.0 GHz

Outline Drawing:

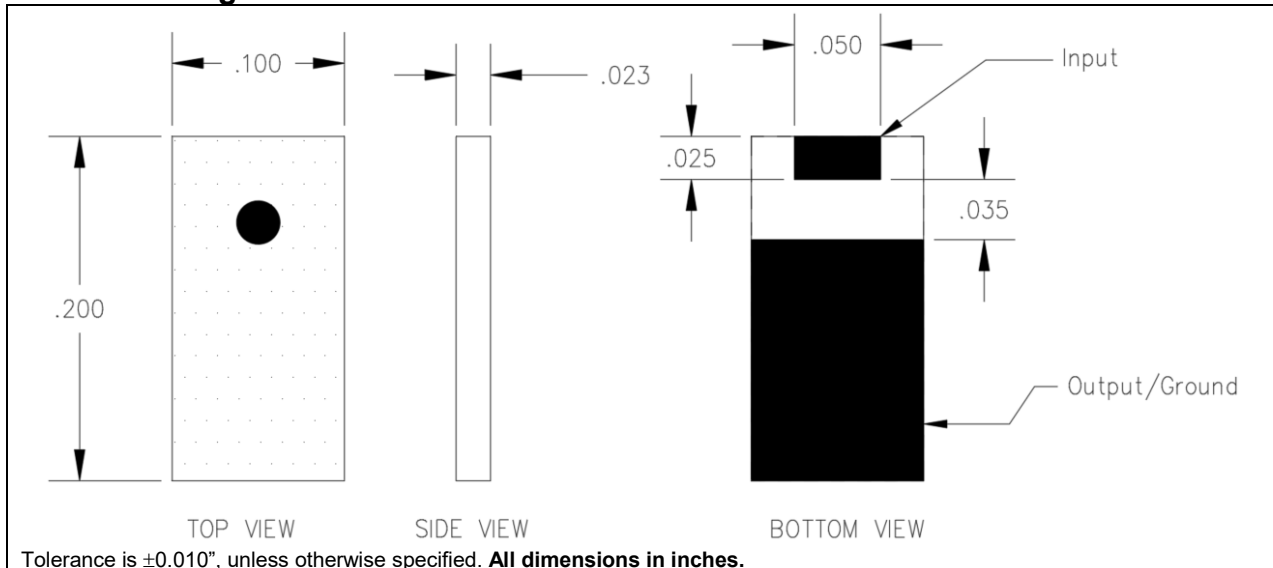

Typical Performance:

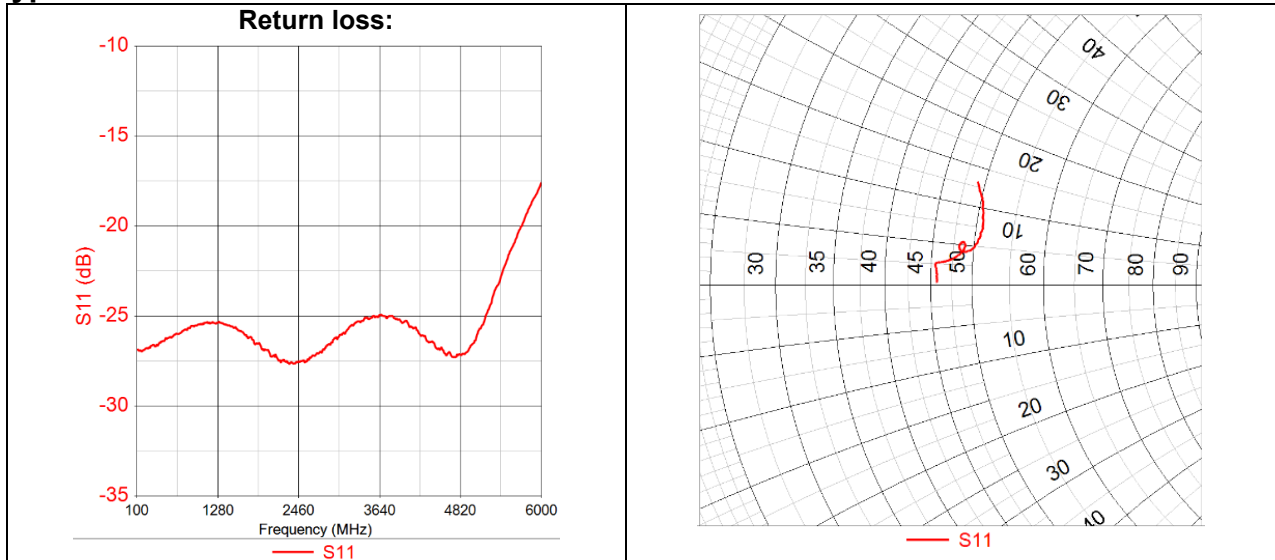

Power De-rating:

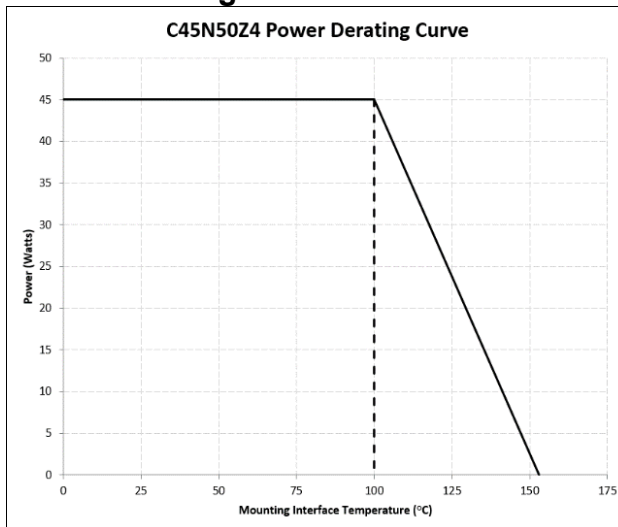

Mounting Footprint:

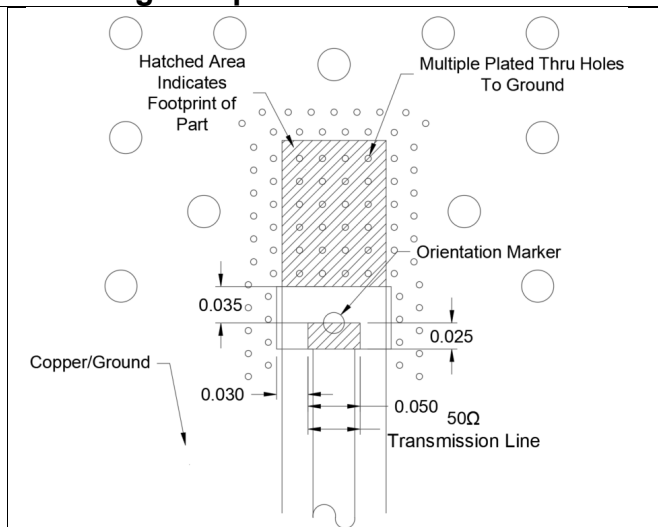

Tape & Reel:

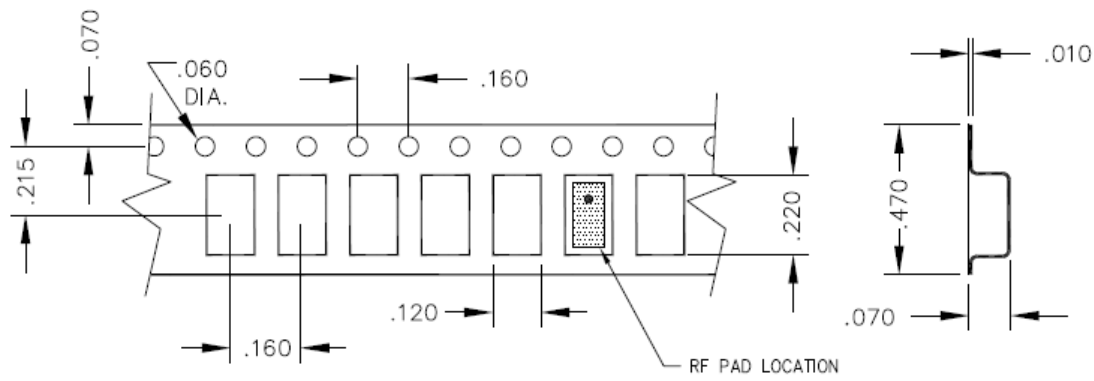

USER DIRECTION OF FEED →

Contact us:
rf&s_support@ttm.com