

ASSEMBLY INSTRUCTIONS:

- Apply gasket on either side .250 in from edge run gasket along entire edge from front to rear.
- Apply gasket along front and rear edges keep as close to radius of edge as possible.
- Cut and glue ends to the two side gasket strips.

TYPICAL GASKET APPLICATION

Caution: Do not disturb gasket after applying adhesive. Do not handle while packing units or bump into other objects

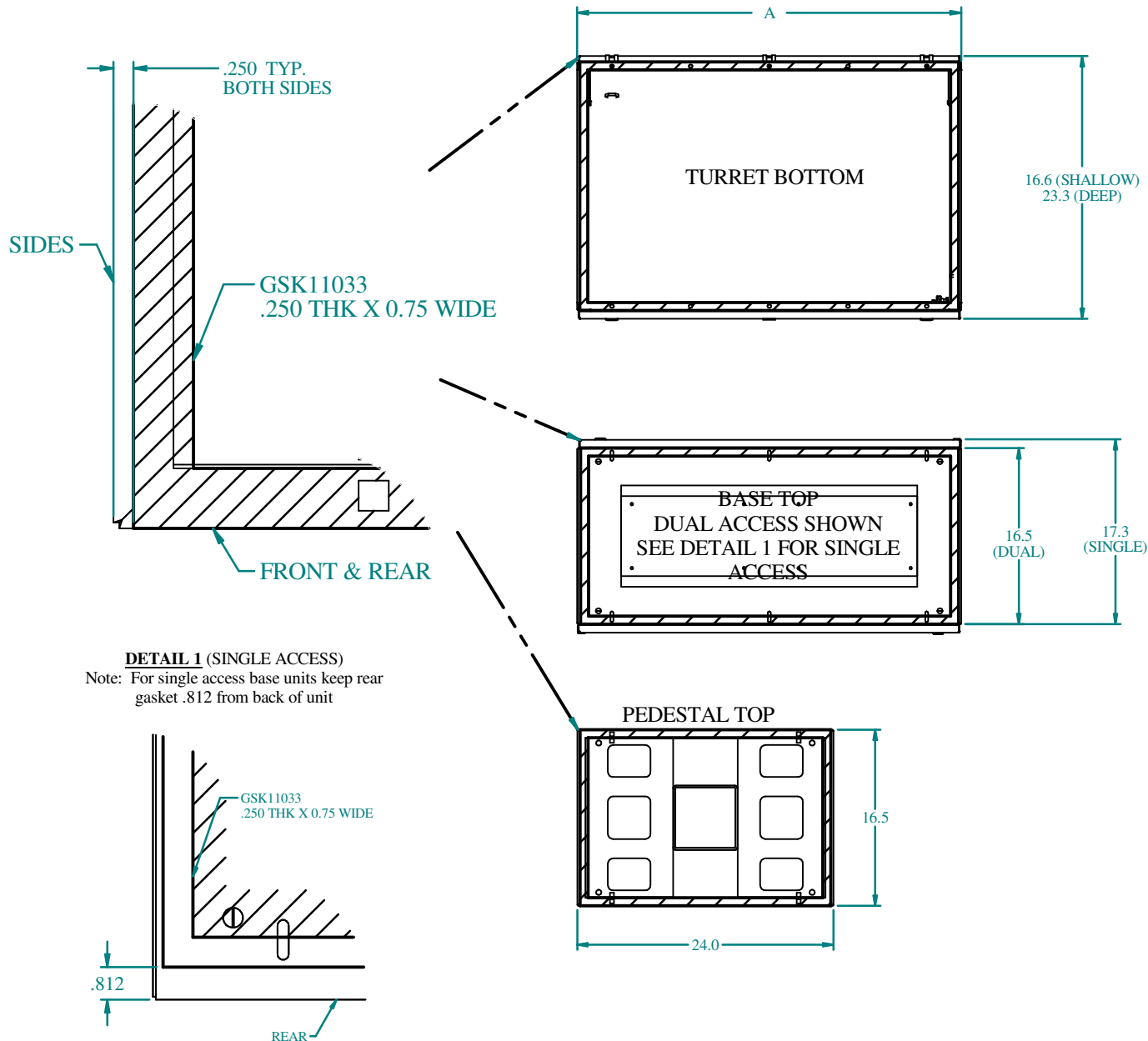

DETAIL 1 (SINGLE ACCESS)

Note: For single access base units keep rear gasket .812 from back of unit

