

Type BLC-20A Fuse Block For 1/4" x 1 1/4" (6.3 x 32mm) Fuses



www.optifuse.com

(619)-593-5050

Fuse Style: 1/4" x 1 1/4" (6.3 x 32mm) Fuses

Material:

Body: PBT (UL Flame: 94V-0)

Terminal: Nickel plated Brass

Mounting: by screws

Electrical: 15A 125VAC
10A 250VAC

Single Fuse Blocks can be snapped together for multi-pole applications.

Agency Standards and Listings:



Product Dimensions: Inches [mm]

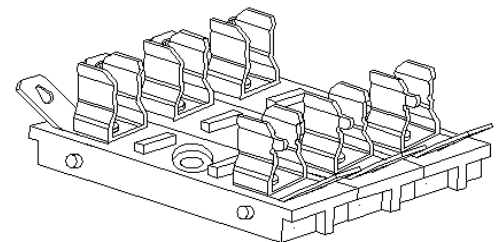
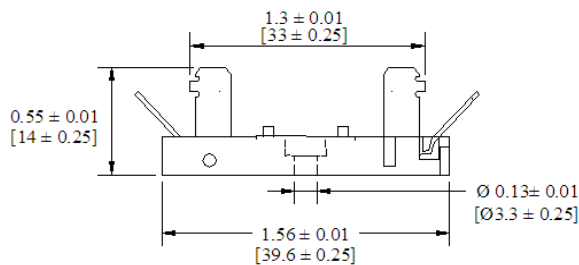
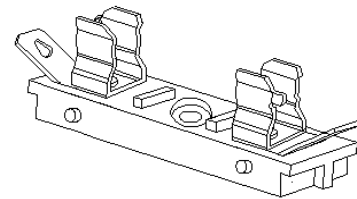
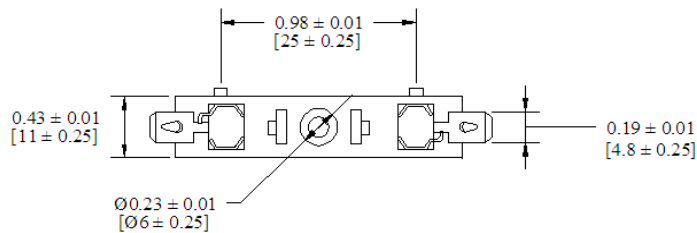

Warning:



-Operation beyond the specified maximum ratings or improper use may result in damage and possible electrical arcing and/or flame.

-Avoid contact of Fuse Block with chemical solvent. Prolonged contact may damage the device performance.