

B2C103A
2-56 THREAD NON-HERMETIC
10,000pF Cap. FEED-THRU

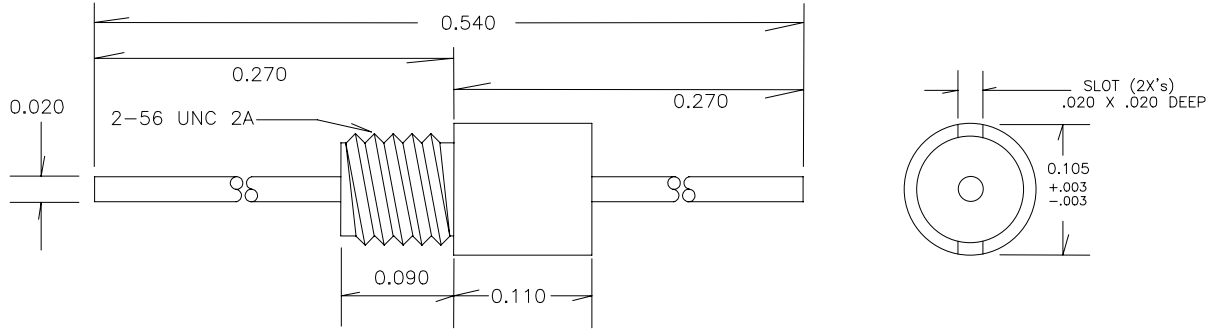
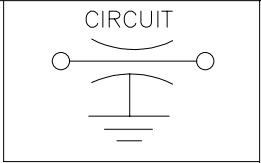

- * RoHS Compliant
- * Discoidal Capacitor Construction

| PART NUMBER | EMI P/N | CAP. (pF) | COLOR DOT(S)* | MAX. WVDC | DC AMPS | MINIMUM NO LOAD INSERTION LOSS | | | | |
|-------------|---------|-----------|---------------|-----------|---------|--------------------------------|--------|---------|-------|--------|
| | | | | | | 1 MHz | 10 MHz | 100 MHz | 1 GHz | 10 GHz |
| B2C103A | | 10,000 | 2 WHITE | 50 | 5 | 6 | 21 | 35 | 50 | 60 |

ELECTRICAL

CAPACITANCE TOLERANCE: +100/-0%
 DISSIPATION FACTOR: 3.5% MAX.
 INSULATION RESISTANCE:
 25° C=10,000 Mohm Min.
 125° C=1,000 Mohm Min.
 DIELECTRIC STRENGTH (DWV):
 250% of WVDC (5 seconds)
 TEMPERATURE CHARACTERISTIC:
 X7R or better

PHYSICAL

DIMENSION TOLERANCE:
 CASE LENGTH: +/- .005" (.123mm)
 LEAD LENGTH: +/- .030" (.762mm)
 LEAD DIAMETER: +/- .002" (.051mm)
 MATERIAL AND FINISH:
 CASE: Brass CASE FINISH: Gold
 LEAD: Brass, 3/4 Hard
 LEAD FINISH: Gold, Suitable For Wire Bond
 Per MIL-G-45204, Type III, Grade A, Class 1

IDENTIFICATION & LIMITS

*MARKING:
 NO MARKING STANDARD.
 Color dot marking option available.
 OPERATING TEMP: -55° C to +125° C
 INSTALLATION TEMP: N/A
 MAXIMUM MOUNTING TORQUE: 1.0 in*lbs

NOTE
 For a .024" diameter lead, append
 "24" to the end of the EMI P/N.

| | | | | |
|--|--------------|--|--|--|
| EMI Filter Company 12750 59th Way N. Clearwater, FL 33760 (727) 585-7990 (727) 586-5138 Fax www.emifiltercompany.com | | FILTER, EMI, MINIATURE, 2-56 THREADED BODY | | |
| FSCM NO. | DWG NO. | REV | | |
| | B2C103A REVD | D | | |