

1

2

3

4

5

6

7

A

B

C

D

E

F

A

B

C

D

E

F

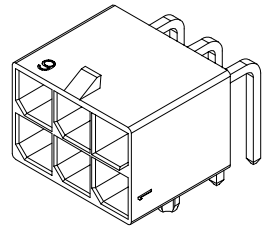
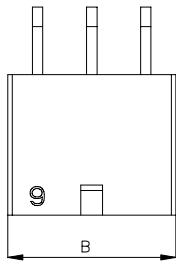

2 CKTS

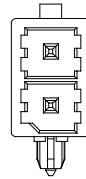

12 CKTS

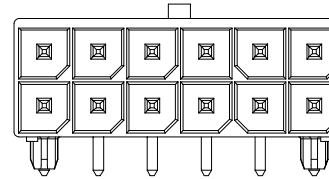

NOTE:

1.MATERIAL

- 1.1 Insulator:LCP,UL94V-0,Black
- 1.2 Contact:High contactivity copper alloy,Tin-plated

2.ELECTRIC

- 2.1 Current Rating:23A AC/DC
- 2.2 Voltage Rating:600V AC/DC
- 2.3 Contact Resistance:10mΩ Max
- 2.4 Insulation Resistance:1000MΩ Min
- 2.5 Withstanding Voltage:2200V AC/minute

4 CKTS

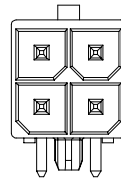

10 CKTS

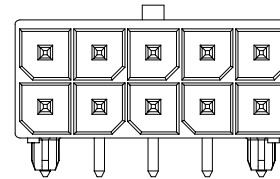

3.Temperature Range:-40°C To +105°C

- 4.Pin:1.08mm Square Pin
- 5.Packing:PE bag

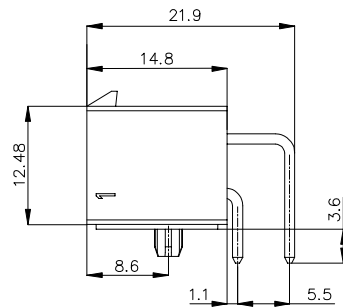
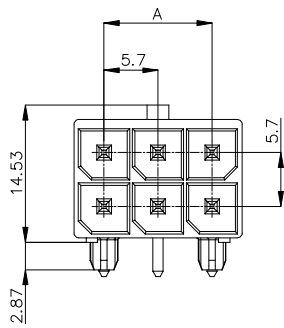

6 CKTS

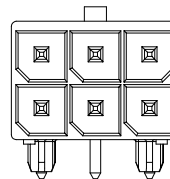

8 CKTS

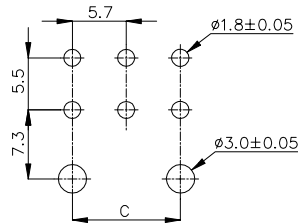
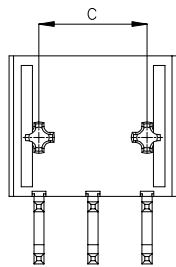
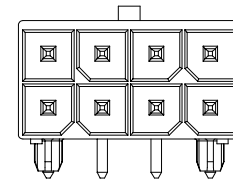

Current rating:With tinned AWG copper wire

Wire Size		N			
AWG	Max.Ins.Dia	2	4	6	8~12
#12,4.0mm ²	4.11mm	23	20	18	16
#14,2.5mm ²	3.75mm	21	17	15	13
#16,1.5mm ²	3.18mm	17	15	13	12

Circuits	2	4	N
Dim.A	N/A	2.85×N-5.7	
Dim.B	8.35	2.85×N+0.65	
Dim.C	N/A	2.85×N-5.7	
& N=6~12			

G

RoHS compliant

unit:mm

Scale	Free
TOLERANCE	
X.	±0.35
X.X	±0.25
X.XX	±0.20
X.XXX	±0.15
DIM	TOL
Angle	TOL

Drawn	05.10.2022	Peter	ASSMANN WSW components
Approved	05.10.2022	Peter	
①	Drawn	05.10.2022	Peter
Id.	modification	Date	Name

Description: Wire to Board Wafer Pitch 5.70mm 90° THT	
ASSMANN WSW-NO. A-WBP-V001EA-xxTB01	
Drawing-No. ASS 9378 CO	rev00
Customer-No.	SHEET 2 / 4

G

H

H

1

2

3

4

5

6

7

1

2

3

4

5

6

7

A

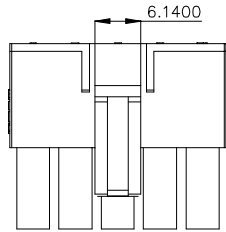

2 CKTS

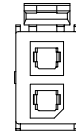

12 CKTS

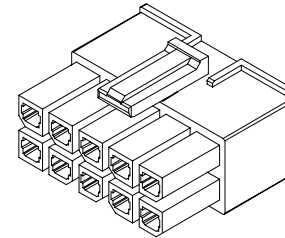
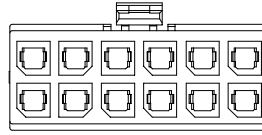

NOTE:

- 1.MATERIAL
 - 1.1 Insulator:Nylon 66,UL94V-2,Black
- 2.ELECTRIC
 - 2.1 Current Rating:23A AC/DC
 - 2.2 Voltage Rating:600V AC/DC
 - 2.3 Insulation Resistance:1000MΩ Min
 - 2.3 Withstanding Voltage:2200V AC/minute
- 3.Temperature Range:-40°C To +105°C
- 4.Packing:PE bag

A

B

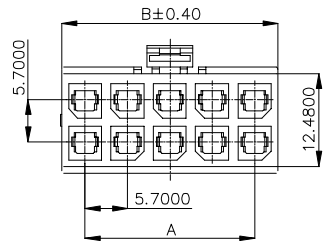

4 CKTS

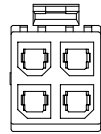

10 CKTS

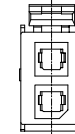
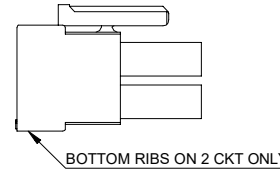
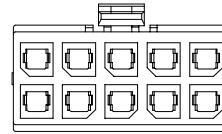

B

C

D

E

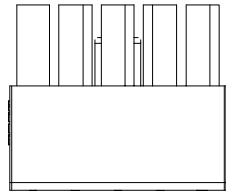

6 CKTS

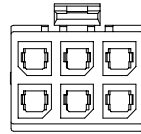

8 CKTS

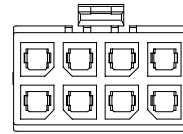

Current rating:With tinned AWG copper wire

Dimensional Information (mm)

Circuits	Dim.A	Dim.B	Wire Size		N			
			AWG	Max.Ins.Dia	2	4	6	8~12
2	N / A	N / A	#12,4.0mm ²	4.11mm	23	20	18	16
N	2.85×N-5.7	2.85×N+0.65	#14,2.5mm ²	3.75mm	21	17	15	13
&& N=4~12			#16,1.5mm ²	3.18mm	17	15	13	12

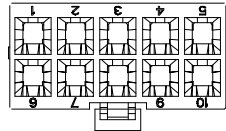

F

G

RoHS compliant

unit:mm

Scale	Free
TOLERANCE	
X.	±0.35
X.X	±0.25
X.XX	±0.20
X.XXX	±0.15
DIM	TOL
Angle	TOL

Drawn	05.10.2022	Peter	ASSMANN WSW components
Approved	05.10.2022	Peter	
①	Drawn	05.10.2022	Peter
Id.	modification	Date	Name

Description: Wire to Board Housing
Pitch 5.70mm

ASSMANN WSW-NO.
A-WBH-V001EG-xxCB01

Drawing-No.
ASS 9378 CO rev00

Customer-No. SHEET 3 / 4

G

H

H

1

2

3

4

5

6

7

1

2

3

4

5

6

7

A

B

C

D

E

F

G

H

A

B

C

D

E

F

G

H

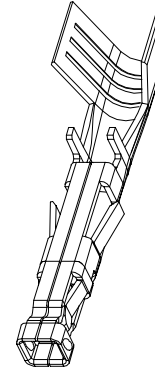
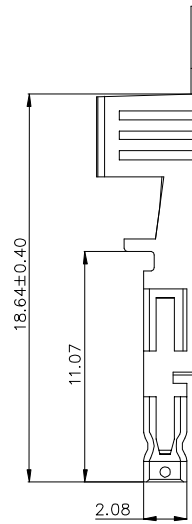
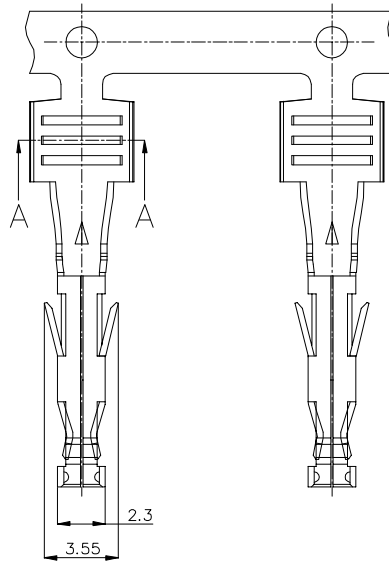
**NOTE:****1.MATERIAL**

1.1 Contact:High contactivity copper alloy,Tin-plated

2.ELECTRIC

2.1 Current Rating:23A AC/DC

2.2 Voltage Rating:600 AC/DC

2.3 Contact Resistance:10mΩ Max

2.4 Insulation Resistance:1000MΩ Min

2.5 Withstanding Voltage:2200V AC/minute

3.Temperature Range:-40°C To +105°C

4.Packing:Reel

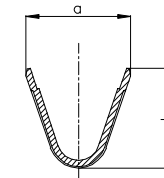

SEC:A-A

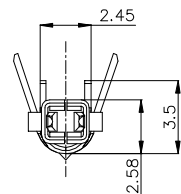

Current rating:With tinned AWG copper wire

Dimensional Information (mm)

Part No.	Wire Range	Dim.a	Dim.b	Wire Size		N			
				AWG	Max.Ins.Dia	2	4	6	8~12
A-WBT-V001EG-01CR01	#14-#16	3.4	3.55	#12,4.0mm ²	4.11mm	23	20	18	16
A-WBT-V001EG-01CR02	#12	5.0	4.8	#14,2.5mm ²	3.75mm	21	17	15	13
				#16,1.5mm ²	3.18mm	17	15	13	12

Scale	Free
TOLERANCE	
X.	±0.35
X.X	±0.25
X.XX	±0.20
X.XXX	±0.15
DIM	TOL
Angle	TOL

①	Drawn	Date	Name
	Drawn	05.10.2022	Peter
	modification	Date	Name

Date	Name
05.10.2022	Peter
05.10.2022	Peter

ASSMANN
WSW components

Description: Wire to Board Terminal	
ASSMANN WSW-NO. A-WBT-V001EG-01CB0x	
Drawing-No. ASS 9378 CO	rev00
Customer-No.	SHEET 4 / 4

RoHS compliant

unit:mm

1

2

3

4

5

6

7

SV5237