

1

2

3

4

5

6

7

A

A

**NOTE:**

- 1.MATERIAL
  - 1.1 Insulator:Nylon 66,UL94V-2,Black
- 2.ELECTRIC
  - 2.1 Voltage Rating:250V AC. Max
  - 2.2 Current Rating:5A AC.DC
  - 2.3 Withstanding Voltage:1500V AC/minute
  - 2.4 Insulation Resistance:1000MQ Min
- 3.Temperature Range:-25°C To +85°C
- 4.Packing:PE bag

B

B

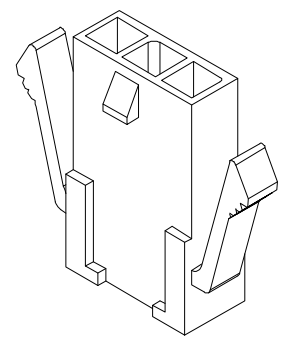
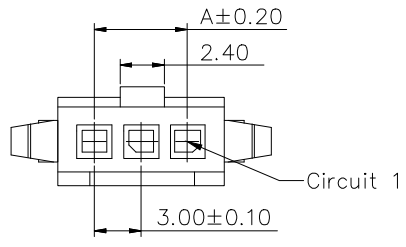

C

C

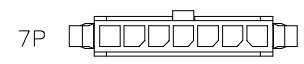

D

D

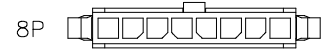
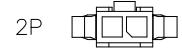
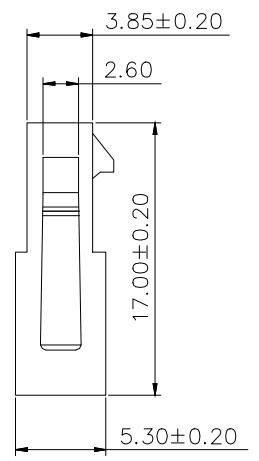
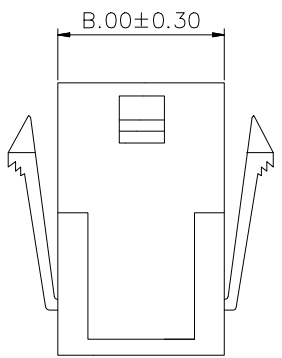

E

E

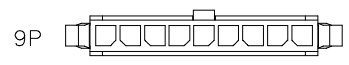
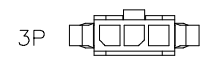

Poles	Part No.	Dimensions (mm)	
		A	B
02	A-WBH-O002EG-02CB01	3.00	6.85
03	A-WBH-O002EG-03CB01	6.00	9.85
04	A-WBH-O002EG-04CB01	9.00	12.85
05	A-WBH-O002EG-05CB01	12.00	15.85
06	A-WBH-O002EG-06CB01	15.00	18.85
07	A-WBH-O002EG-07CB01	18.00	21.85
08	A-WBH-O002EG-08CB01	21.00	24.85
09	A-WBH-O002EG-09CB01	24.00	27.85
10	A-WBH-O002EG-10CB01	27.00	30.85
11	A-WBH-O002EG-11CB01	30.00	33.85
12	A-WBH-O002EG-12CB01	33.00	36.85

F

F

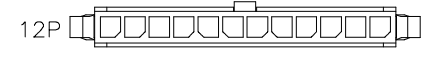
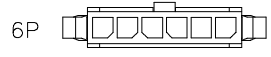
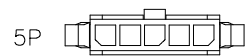
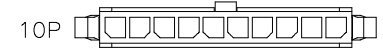
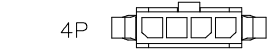

**CIRCUIT SIZE LAYOUT**

G

G

**RoHS compliant**  
unit:mm

Scale	Free
TOLERANCE	
X.	±0.35
X.X	±0.25
X.XX	±0.20
X.XXX	±0.15
DIM	TOL
Angle	TOL

				Date	Name	Description: Wire to Board Housing Pitch 3.00mm	
				Drawn	01.12.2022		Peter
				Approved	03.14.2023		Peter
						ASSMANN WSW-NO. <b>A-WBH-O002EG-xxCB01</b>	
		①	Add UL E-No. on page 5,6	03.14.2023	Peter	Drawing-No. <b>ASS 9206 CO</b>	
		②	Drawn	01.12.2022	Peter		rev01
			modification	Date	Name	Customer-No.	
						SHEET 1 / 6	



H

H

1

2

3

4

5

6

7

1

2

3

4

5

6

7

A

A

B

B

C

C

D

D

E

E

F

F

G

G

H

H

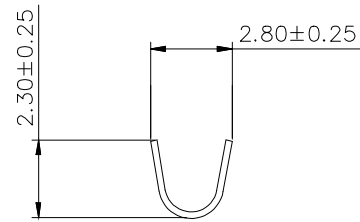
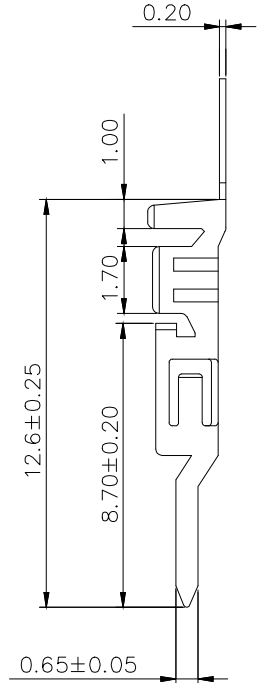
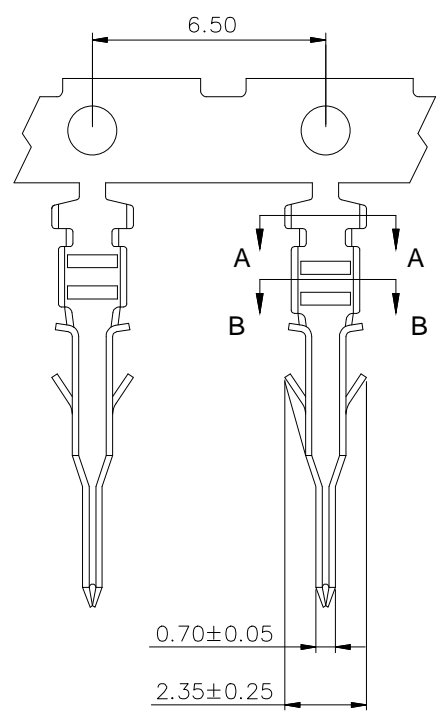

SEC:A-A

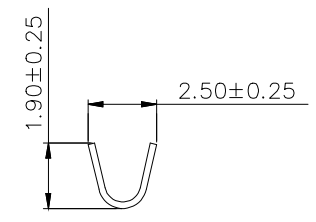

SEC:B-B

NOTE:

- 1.MATERIAL
  - 1.1 Contact:Phosphor Bronze,Tin over Nickel
- 2.ELECTRIC
  - 2.1 Voltage Rating:250V AC.DC
  - 2.2 Current Rating:5A AC.DC
  - 2.3 Withstanding Voltage:1500V AC/minute
  - 2.4 Insulation Resistance:1000MΩ Min
  - 2.5 Contact Resistance:20mΩ Max
- 3.Temperature Range:-25°C To +85°C
- 4.Applicable Wire:AWG#24-#28
- 5.Packing:Reel

RoHS compliant  
unit:mm

Scale	Free
TOLERANCE	
X.	±0.35
X.X	±0.25
X.XX	±0.20
X.XXX	±0.15
DIM	TOL
Angle	TOL

				Date	Name	Description: Wire to Board Terminal Male / Pitch 3.00mm
			Drawn	01.12.2022	Peter	
			Approved	03.14.2023	Peter	
						ASSMANN WSW-NO. <b>A-WBT-O002EG-01CR01</b>
		①	Add UL E-No. on page 5,6	03.14.2023	Peter	Drawing-No. <b>ASS 9206 CO</b>
		②	Drawn	01.12.2022	Peter	
		Id.	modification	Date	Name	Customer-No.



rev01

SHEET 2 / 6

1

2

3

4

5

6

7

1

2

3

4

5

6

7

A

A

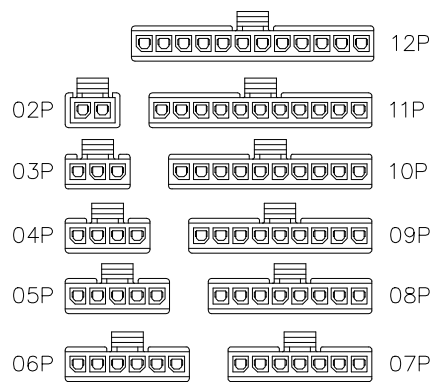
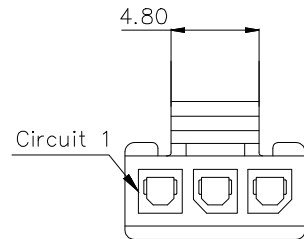
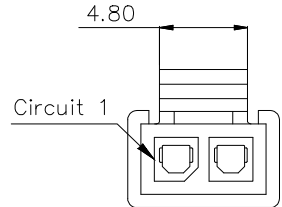

**NOTE:**

1.MATERIAL  
1.1 Insulator:Nylon 66,UL94V-2,Black

2.ELECTRIC  
2.1 Voltage Rating:250V AC/DC  
2.2 Current Rating:5A AC/DC  
2.3 Withstanding Voltage:1500V AC/minute  
2.4 Insulation Resistance:1000MΩ Min

3.Temperature Range:-25°C To +85°C  
4.Packing:PE bag

CIRCUIT SIZE LAYOUT

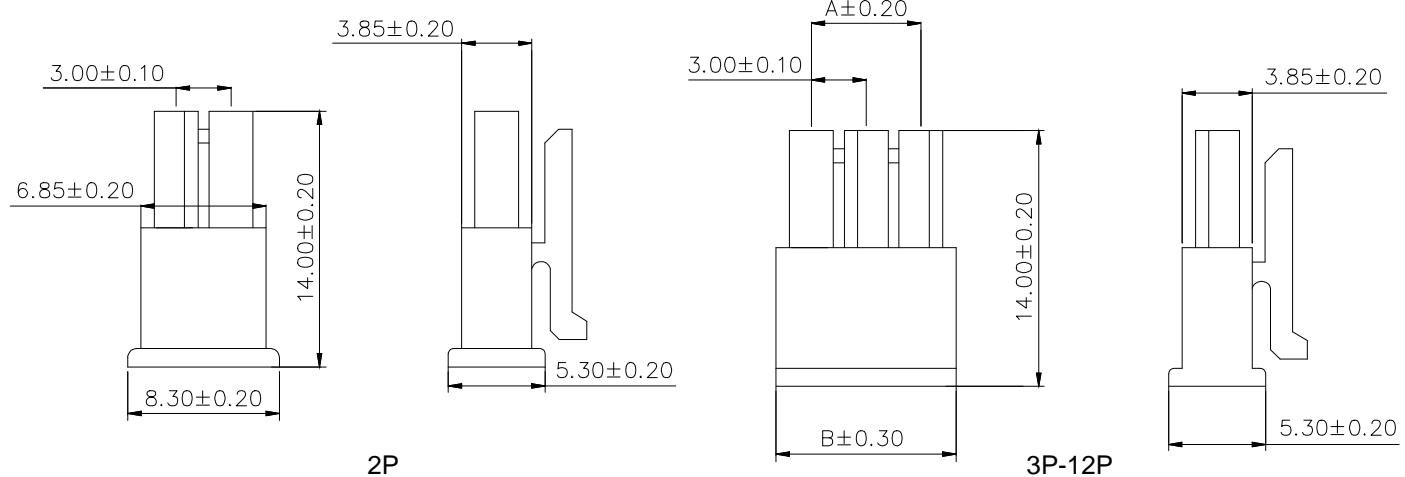
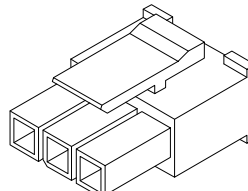

Poles	Part No.	Dimensions (mm)	
		A	B
02	A-WBH-O002EG-02CB02	3.00	6.85
03	A-WBH-O002EG-03CB02	6.00	9.85
04	A-WBH-O002EG-04CB02	9.00	12.85
05	A-WBH-O002EG-05CB02	12.00	15.85
06	A-WBH-O002EG-06CB02	15.00	18.85
07	A-WBH-O002EG-07CB02	18.00	21.85
08	A-WBH-O002EG-08CB02	21.00	24.85
09	A-WBH-O002EG-09CB02	24.00	27.85
10	A-WBH-O002EG-10CB02	27.00	30.85
11	A-WBH-O002EG-11CB02	30.00	33.85
12	A-WBH-O002EG-12CB02	33.00	36.85

G

G

RoHS compliant  
unit:mm

Scale	Free						Date	Name	Description: Wire to Board Housing Pitch 3.00mm
TOLERANCE							Drawn	Peter	
X.	±0.35						Approved	Peter	ASSMANN WSW-NO. <b>A-WBH-O002EG-xxCB02</b>
X.X	±0.25								
X.XX	±0.20								Drawing-No. <b>ASS 9206 CO</b> rev01
X.XXX	±0.15	①	Add UL E-No. on page 5,6	03.14.2023	Peter	<b>ASSMANN</b> WSW components			
DIM	TOL	②	Drawn	01.12.2022	Peter		Customer-No.	SHEET 3 / 6	
Angle	TOL	Id.	modification	Date	Name				

1

2

3

4

5

6

7

H

H

1

2

3

4

5

6

7

A

A

B

B

C

C

D

D

E

E

F

F

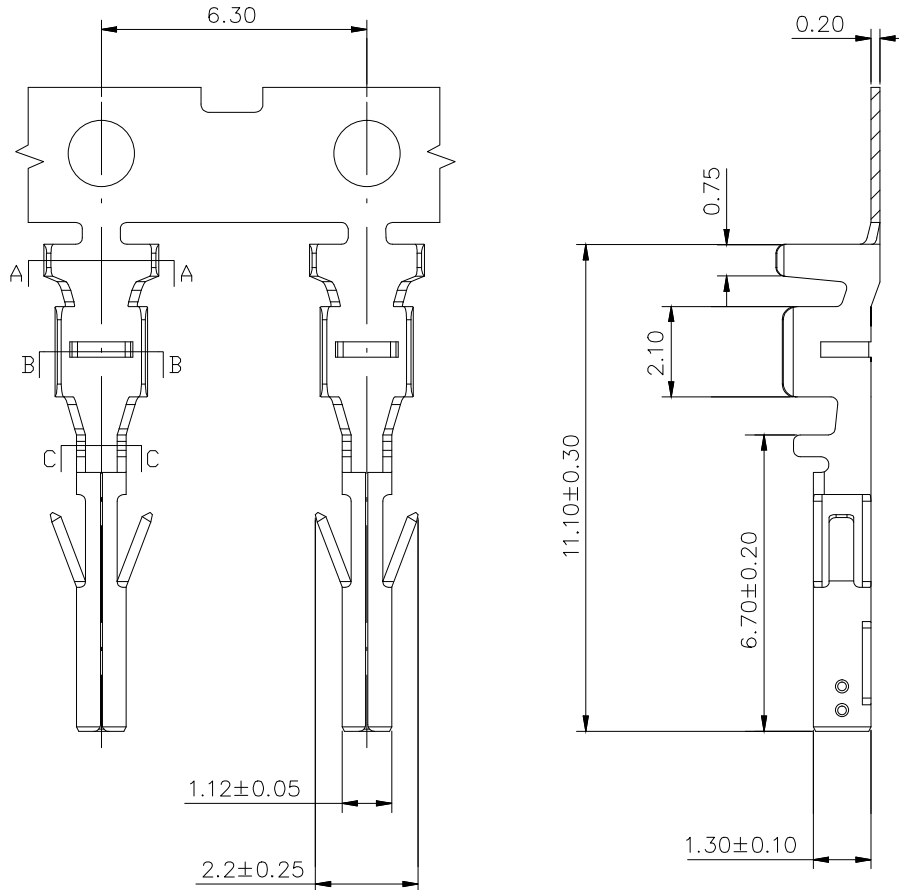

**NOTE:**

- MATERIAL**  
1.1 Contact: Phosphor Bronze, Tin over Nickel
- ELECTRIC**  
2.1 Voltage Rating: 250V AC/DC  
2.2 Current Rating: 5A AC/DC  
2.3 Withstanding Voltage: 1500V AC/minute  
2.4 Insulation Resistance: 1000MΩ Min  
2.5 Contact Resistance: 20mΩ Max
- Temperature Range: -25°C To +85°C
- Applicable Wire: AWG#24-#28
- Packing: Reel

SEC:A-A

SEC:B-B

G

G

**RoHS compliant**  
unit:mm

Scale	Free						Date	Name	Description: Wire to Board Terminal Female / Pitch 3.00mm	
TOLERANCE							Drawn	01.12.2022	Peter	ASSMANN WSW-NO. <b>A-WBT-O002EG-01CR02</b>
X.	±0.35					Approved	03.14.2023	Peter		
X.X	±0.25									
X.XX	±0.20									
X.XXX	±0.15	①	Add UL E-No. on page 5,6	03.14.2023	Peter	<b>ASSMANN</b> WSW components		Drawing-No.	ASS 9206 CO	rev01
DIM	TOL	②	Drawn	01.12.2022	Peter			Customer-No.	SHEET	
Angle	TOL	Id.	modification	Date	Name			4 / 6		

H

H

1

2

3

4

5

6

7

1

2

3

4

5

6

7

A

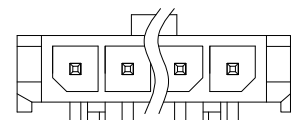

3.00±0.10      0.64±0.05

A±0.20

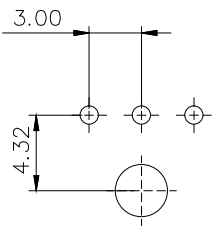

PCB.LAYOUT:3 CKT

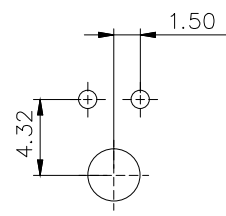

PCB.LAYOUT:2 CKT

**NOTE:**

**1.MATERIAL**  
 1.1 Insulator:Nylon 66 15%GF,UL94V-0,Black  
 1.2 Contact:Brass,Tin over Nickel

**2.ELECTRIC**  
 2.1 Voltage Rating:250V AC. Max  
 2.2 Current Rating:5A AC.DC  
 2.3 Withstanding Voltage:1500V AC/minute  
 2.4 Insulation Resistance:1000MΩ Min  
 2.5 Contact Resistance:20mΩ Max

**3.Temperature Range:-25°C To +85°C**  
 4.Packing:PE bag

A

B

B

C

C

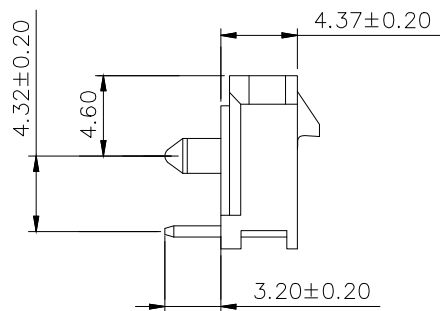
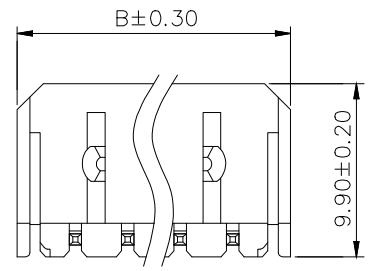

D

D

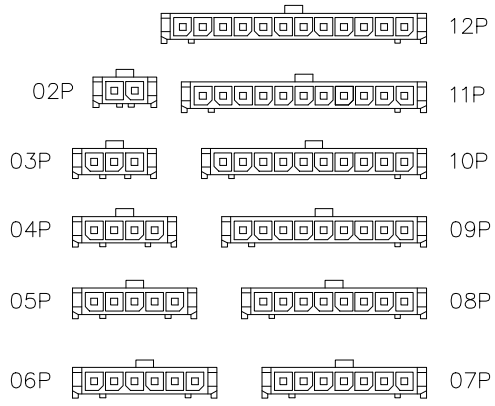

CIRCUIT SIZE LAYOUT

E

E

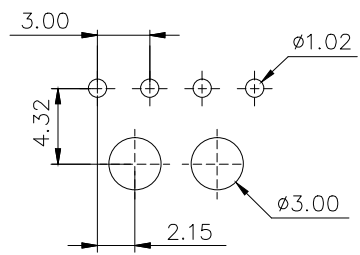

PCB.LAYOUT:04P-12P

Poles	Part No.	Dimensions (mm)	
		A	B
02	A-WBP-O002EA-02TB01	3.00	9.65
03	A-WBP-O002EA-03TB01	6.00	12.65
04	A-WBP-O002EA-04TB01	9.00	15.65
05	A-WBP-O002EA-05TB01	12.00	18.65
06	A-WBP-O002EA-06TB01	15.00	21.65
07	A-WBP-O002EA-07TB01	18.00	24.65
08	A-WBP-O002EA-08TB01	21.00	27.65
09	A-WBP-O002EA-09TB01	24.00	30.65
10	A-WBP-O002EA-10TB01	27.00	33.65
11	A-WBP-O002EA-11TB01	30.00	36.65
12	A-WBP-O002EA-12TB01	33.00	39.65

F

F

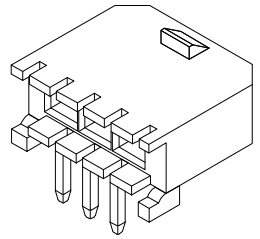

G

G

RoHS compliant  
unit:mm



① File No.: E198287

Scale	Free
TOLERANCE	
X.	±0.35
X.X	±0.25
X.XX	±0.20
X.XXX	±0.15
DIM	TOL
Angle	TOL

①	Add UL E-No. on page 5,6	03.14.2023	Peter
②	Drawn	01.12.2022	Peter
Id.	modification	Date	Name

Date: 01.12.2022 Name: Peter  
 Drawn  
 Date: 03.14.2023 Name: Peter  
 Approved  
**ASSMANN**  
 WSW components

Description: Wire to Board Wafer Pitch 3.00mm 90° THT	
ASSMANN WSW-NO. <b>A-WBP-O002EA-xxTB01</b>	
Drawing-No.	rev01
ASS 9206 CO	
Customer-No.	SHEET 5 / 6

H

H

1

2

3

4

5

6

7

1

2

3

4

5

6

7

A

A

**NOTE:**

**1.MATERIAL**

- 1.1 Insulator:LCP,UL94V-0,Black
- 1.2 Contact:Brass,Tin over Nickel

**2.ELECTRIC**

- 2.1 Voltage Rating:250V AC, DC
- 2.2 Current Rating:5A AC,DC
- 2.3 Withstanding Voltage:1500V AC/minute
- 2.4 Insulation Resistance:1000MΩ Min
- 2.5 Contact Resistance:20mΩ Max

- 3.Temperature Range:-25°C To +85°C
- 4.Packing:PE bag

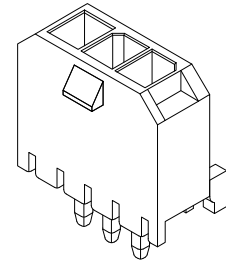
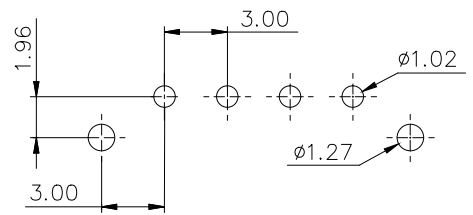
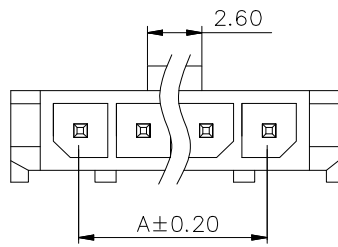

B

B

C

C

D

D

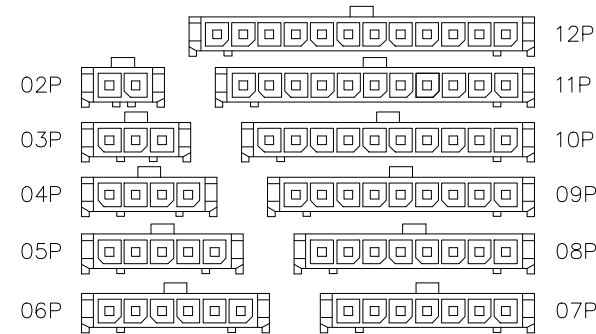
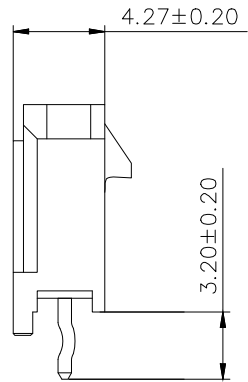
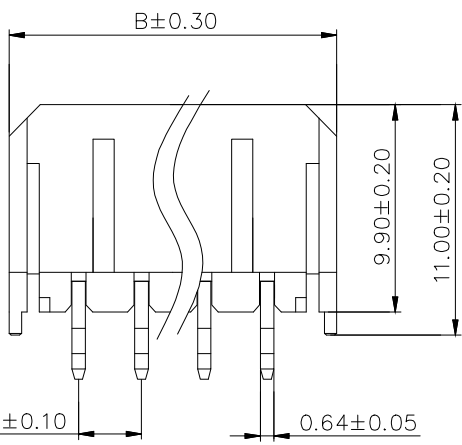

**CIRCUIT SIZE LAYOUT**

Poles	Part No.	Dimensions (mm)	
		A	B
02	A-WBP-O002EG-02TB01	3.00	9.65
03	A-WBP-O002EG-03TB01	6.00	12.65
04	A-WBP-O002EG-04TB01	9.00	15.65
05	A-WBP-O002EG-05TB01	12.00	18.65
06	A-WBP-O002EG-06TB01	15.00	21.65
07	A-WBP-O002EG-07TB01	18.00	24.65
08	A-WBP-O002EG-08TB01	21.00	27.65
09	A-WBP-O002EG-09TB01	24.00	30.65
10	A-WBP-O002EG-10TB01	27.00	33.65
11	A-WBP-O002EG-11TB01	30.00	36.65
12	A-WBP-O002EG-12TB01	33.00	39.65

E

E

F

F

G

G

**RoHS compliant**  
unit:mm



① File No.: E198287

Scale	Free
TOLERANCE	
X.	±0.35
X.X	±0.25
X.XX	±0.20
X.XXX	±0.15
DIM	TOL
Angle	TOL

①	Add UL E-No. on page 5,6	03.14.2023	Peter
②	Drawn	01.12.2022	Peter
Id.	modification	Date	Name

Date: 01.12.2022  
Name: Peter  
Drawn

Date: 03.14.2023  
Name: Peter  
Approved

Description: Wire to Board Wafer Pitch 3.00mm 180° THT	
ASSMANN WSW-NO. <b>A-WBP-O002EG-xxTB01</b>	
Drawing-No. <b>ASS 9206 CO</b>	rev01
Customer-No.	SHEET 6 / 6

H

H

1

2

3

4

5

6

7