

1

2

3

4

5

6

7

A

A

B

B

C

C

D

D

E

E

F

F

## NOTES:

## ELECTRICAL:

- VOLTAGE RATING : 125 VAC.
- CURRENT RATING : 1.5 AMP.
- CONTACT RESISTANCE : 35 MILLIOHMS MAX.
- INSULATION RESISTANCE: 1000 MEGOHMS MIN @ 500 VDC.
- DIELECTRIC STRENGTH : 1000 VAC 60Hz, 1MIN.

## MECHANICAL:

- HOUSING MATERIAL : HIGHT TEMP UL94V-0 PA9T BK.
- INSERT : HIGHT TEMP UL94V-0 PA9T BK.
- CONTACT MATERIAL : PHOSPHOR BRONZE C5210EH t=0.35 mm
- SHIELD MATERIAL : BRASS C2680 H.
- PLATING : GOLD PLATING OVER NICKEL.
- OPERATING LIFE : 750 CYCLES MIN.
- PCB RETENTION POST-SOLDER: 10 LBS MIN.

## ENVIRONMENTAL:

- STORAGE : -40°C TO +85°C.
  - OPERATION: -40°C TO +85°C.
- MATES WITH MODULAR PLUG CONFORMING TO TIA-1096-A.

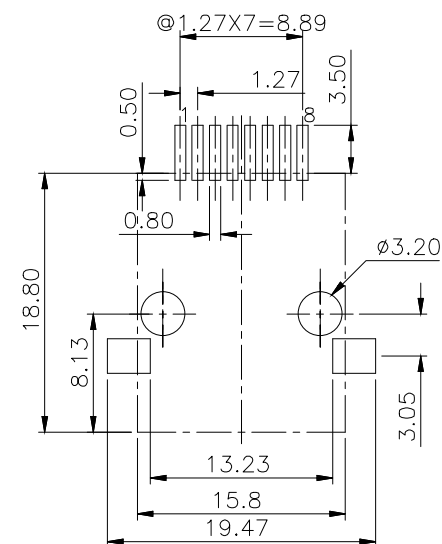
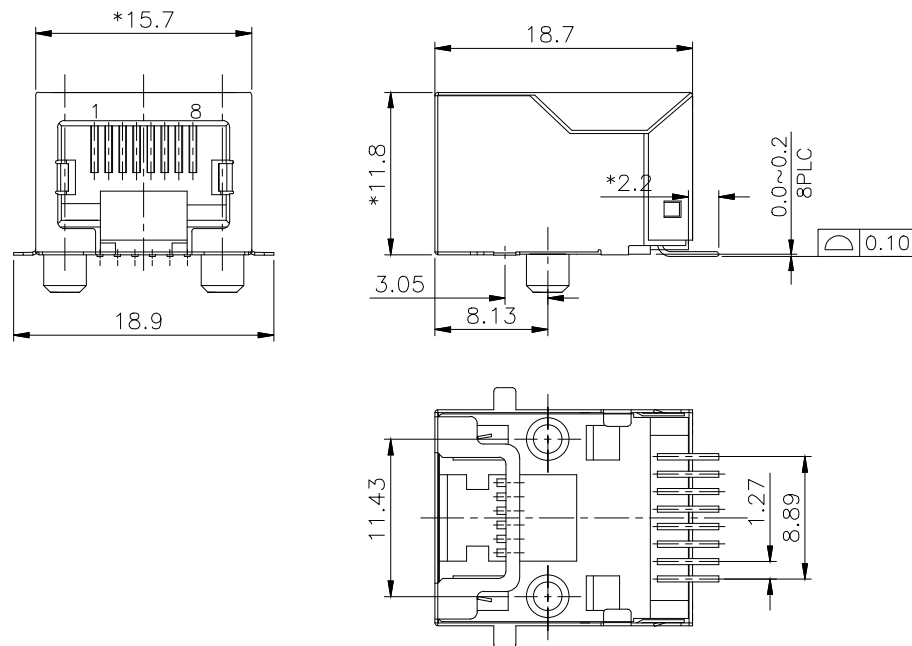

PC BOARD LAYOUT COMPONENT SIDE SHOWN

G

G

H

H

RoHS compliant

Unit:mm

Scale Free

TOLERANCE

X.X ±0.20

X.XX ±0.15

X.XXX ±0.10

DIM TOL

X.° ±5°

Angle TOL

①

Drawn

21.06.2021

Luca

Id.

Modification

Date

Name

Date

Name

Description: Modular Connector

RJ45 / SMT / SIDE ENTRY / SHIELDED

ASSMANN WSW-No.

A-MJH-8-EA-GSP-S3

Drawing-No.

ASS 8975 CO

rev00

Customer-No.

SHEET  
1 / 1

1

2

3

4

5

6

7

SV4832