

| REVISIONS | | | | | |
|-----------|-----|-------------------------|-----------|-------|-------|
| REV | ECO | DESCRIPTION | DATE | BY | APPR |
| A1 | -- | RELEASE NEW DRAWING | 02JAN19 | BROOK | TOMMY |
| A2 | -- | REVISED MATING P/N NOTE | 08/APR/20 | JAH | DH |

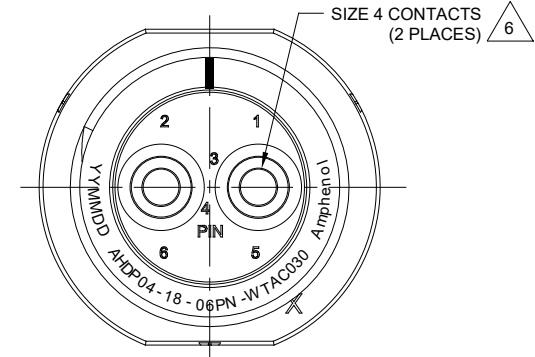

NOTES: UNLESS OTHERWISE SPECIFIED

- MATERIAL:
HOUSING: THERMOPLASTIC; BLACK
SEAL: SILICONE RUBBER
- MODIFICATIONS: THREADED ADAPTER;
- SPECIFICATIONS:
3.1 OPERATING TEMPERATURE: -55°C TO +125°C.
3.2 DIELECTRIC WITHSTANDING VOLTAGE: LESS THAN 2 MILLIAMPS CURRENT LEAKAGE @ 1500 VOLTS AC.
3.3 INSULATION RESISTANCE: 1000 MEGOHM MIN @ 25°C.
3.4 MOISTURE RESISTANCE: IP67&IP69K (MATED CONDITION).
3.5 MATING CYCLE DURABILITY: 100 CYCLES
3.6 RoHS COMPLIANT
- MATING PART: AHDP06-18-06S* (* = SEAL TYPE) (C030 OPTION)
- ALL DIMENSIONS ARE FOR REFERENCE USE ONLY.

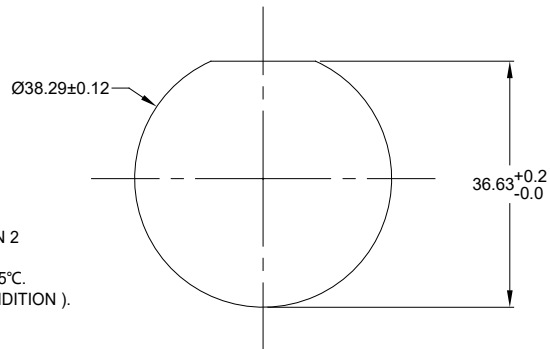

RECOMMENDED PANEL MOUNTING HOLE

RECOMMENDED PANEL THICKNESS: 1.6 TO 4.7MM

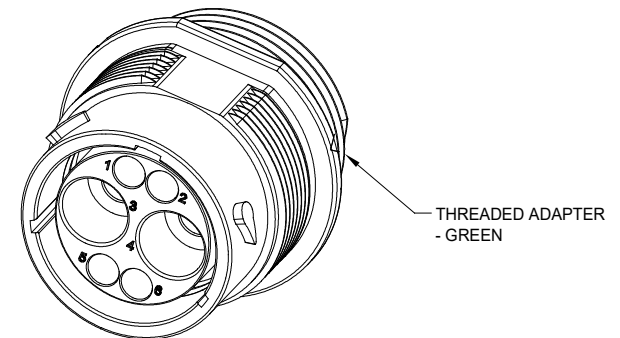

△ CONTACT SIZE AND WIRE RANGE:





| CONTACT SIZE | MIN. INSUL O.D. | MAX. INSUL O.D. | TYPICAL WIRE RANGE | CURRENT RATING |
|--------------|------------------|-------------------|--------------------|----------------|
| 4 | 6.63 mm (.261in) | 7.42 mm (.292 in) | 6 AWG | 100 AMPS |

| | | | | |
|--|--|--|------|-----------------------|
| AHP04-18-06PN-WTAC030 | | DESCRIPTION | | ITEM |
| PART NUMBER | | DESCRIPTION | | |
| QUANTITY | | | | |
| MATERIALS LIST | | | | |
| UNLESS OTHERWISE SPECIFIED: 1) All dimensions are in metric (mm). 2) Tolerances are as follows: 1 PL DEC ±0.30 2 PL DEC ±0.15 3 PL DEC ±0.08 Fractions ±1/64 Angles ±1° | | SIGNATURES | | |
| MATERIAL SPECIFICATIONS: | | DATE | | |
| PROCESS SPECIFICATIONS: | | DRAWN: JONY.XIE 02JAN19 | | |
| NEXT ASSY: | | CHECKED: ORION.LI 02JAN19 | | |
| | | ENGINEER: | | |
| | | APPROVAL: TOMMY.XIE 02JAN19 | | |
| | | CUSTOMER: | | |
| | | THIS DRAWING IS SUPPLIED FOR INFORMATION ONLY. DESIGN FEATURES, SPECIFICATIONS AND PERFORMANCE DATA SHOWN HEREON ARE THE PROPERTY OF THE AMPHENOL CORPORATION. NO RIGHTS OF REPRODUCTION ARE IMPLIED. ALL DIMENSIONS ARE SUBJECT TO NORMAL MANUFACTURING VARIATIONS. | | |
| | | Amphenol | | |
| | | Sine Systems - www.amphenol-sine.com 44724 Morley Drive Clinton Township, MI 48036 | | |
| | | RECEPTACLE, 18-02POS, PIN CONTACT STANDARD DIA. SEAL, AHDP SERIES | | |
| | | SIZE | TYPE | DWG NO. |
| | | B | C- | AHP04-18-06PN-WTAC030 |
| | | SCALE | NONE | REVISION A2 |
| | | SHEET 1 OF 1 | | |

TITLE: RECEPTACLE, 18-02POS, PIN CONTACT, STANDARD DIA. SEAL, AHDP
DWG NO: AHP04-18-06PN-WTAC030
REV: A2
SH: 1
OF: 1

DuraMate™ ATHD Series™ - Contact Size 4 Options

| Machined Contacts, Pins and Sockets | | | | | |
|-------------------------------------|--|------|-----|----------|------|
| Part Number | Description | Size | AWG | Type | Amps |
| AT60-203-04141-4 | Male Contact - Pin, Copper Alloy, Nickel-Plated | 4 | 4 | Machined | 100A |
| AT60-204-0490 | Male Contact - Pin, Copper Alloy, Nickel-Plated | 4 | 6 | Machined | 100A |
| AT62-203-04141-4 | Female Contact - Socket, Copper Alloy, Nickel-Plated | 4 | 4 | Machined | 100A |
| AT62-203-04141 | Female Contact - Socket, Copper Alloy, Nickel-Plated | 4 | 6 | Machined | 100A |

| Tooling - Machined Contacts | | |
|---|-------------|--|
| Part | Part Number | Description |
|  | WA23 | Heavy Duty Pneumatic Crimp Tool -Uses Universal Positioner Part No. WA23-101DA and Crimp Locator MFX-3961 |
|  | WA23-138DA | Die Assembly -for Heavy Duty Pneumatic Crimp Tool, Size 4 |
|  | WA23-11 | Contact Locator, Size 4 |
|  | 96-978-22 | Crimper and Dies -for Size 10mm ² -185mm ² Wires |

| Contact Removal Tools | | |
|---|---------------|---|
| Part | Part Number | Description |
|  | AT11-027-0405 | Contact Removal Tool, Plastic, Size 4, 4AWG |