

**MATERIALS & SPECIFICATIONS**

PART NO.	A 79025-001	REV	ECO	DATE	APP
		D	100016	11-07-13	TLM

**INSULATOR:**  
 THERMOPLASTIC PER MIL-M-24519, TYPE GLCP-30F OR GST-40F NATURAL

**CONTACT:**  
 COPPER ALLOY PER MIL-DTL-32139. GOLD PLATED PER ASTM B488, (HARD GOLD) TYPE II CODE C CLASS 1.27

**TERMINATION:**  
 SOLDER COATED PER J-STD-006 OR PLATED PER AMS-P-81728

**GUIDE POST:**  
 BERYLLIUM COPPER ALLOY PER ASTM B196. ELECTROLESS NICKEL PER SAE-AMS-2404

**CURRENT CAPACITY:**  
 1 AMP MAX PER MIL-DTL-32139

**CONTACT RESISTANCE:**  
 71 MILLIOHMS (71mV) MAX @ 1.0 AMPS PER MIL-DTL-32139

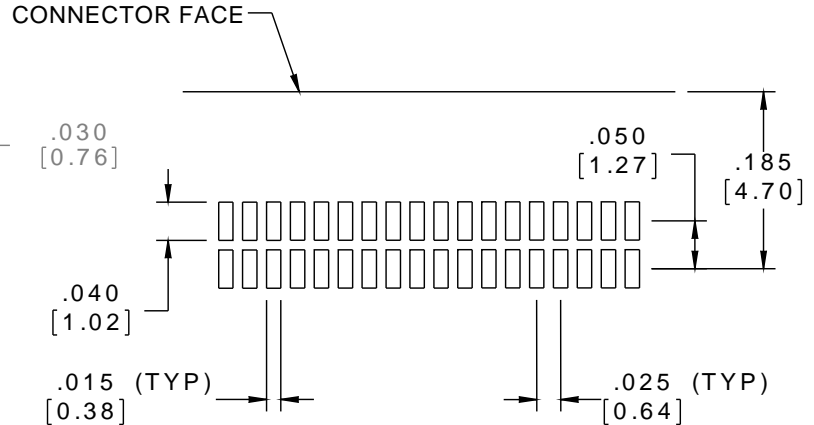
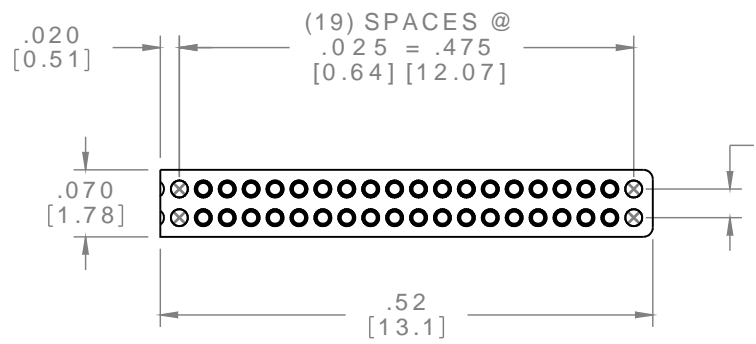

SUGGESTED PAD LAYOUT

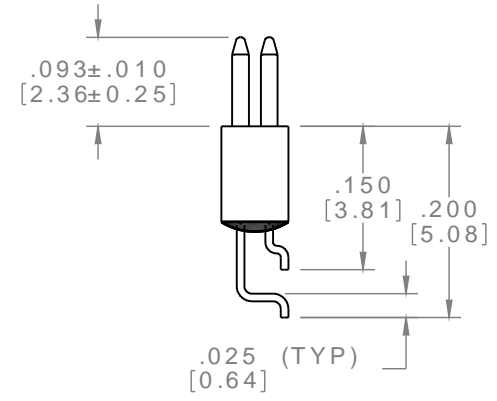
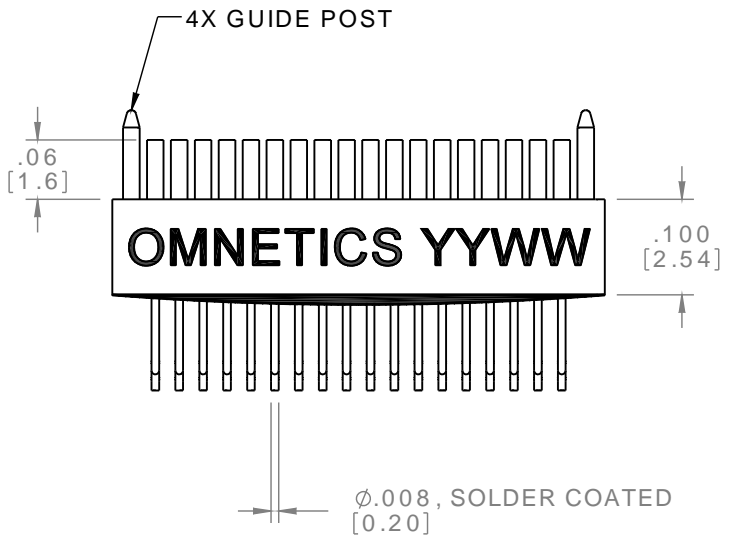

ACTUAL SIZE

**NOTE:**  
 DIMENSIONS IN [ ] ARE IN MILLIMETERS UNLESS OTHERWISE NOTED AND ARE FOR REFERENCE ONLY

NSD SLDW	THIRD ANGLE
	-TOLERANCES- UNLESS OTHERWISE NOTED
	DIMENSIONS IN INCHES
	2 PL DEC± .01 3 PL DEC± .005 4 PL DEC± .0005 ANGLES ± 1°

THIS DRAWING CONTAINS CONFIDENTIAL AND PROPRIETARY INFORMATION WHICH IS THE PROPERTY OF OMNETICS CONNECTOR CORP. THIS DOCUMENT MAY NOT, IN WHOLE OR IN PART, BE DUPLICATED, OR DISCLOSED FOR ANY PURPOSE, WITHOUT WRITTEN PERMISSION FROM OMNETICS CONNECTOR CORP.	
DFTM. TLM	DATE 09-18-08
CHK'D.	DATE
APP'D.	DATE

**TITLE:**  
 (36) SOCKET FEMALE DUAL ROW NANO CONNECTOR W/GUIDE POSTS

**OMNETICS**  
 CONNECTOR CORPORATION  
 7260 COMMERCE CIRCLE EAST  
 MINNEAPOLIS, MN 55432  
 WWW.OMNETICS.COM

CAGE CODE 61873	
DWG NO. A79025-001	
SHEET 1 OF 1	REV D
SCALE: 5:1	