

### BACKSHELL KIT INCLUDES:

- (2) BACKSHELL HALVES
- (2) HOUSING SCREWS
- (2) HOUSING NUTS
- (2) 4-40 MOUNTING SCREWS
- (2) SADDLE WASHERS
- (2) STRAIN RELIEF CLAMPS
- (2) STRAIN RELIEF SCREWS

### METALIZED PLASTIC:

MATERIAL: ABS HIGH TEMPERATURE PLASTIC UL94HB  
 METALIZED PLATING: NICKEL OVER COPPER  
 OPERATING TEMP: 0°C TO 85°C

### PLASTIC:

MATERIAL: ABS HIGH TEMPERATURE PLASTIC UL94HB  
 OPERATING TEMP: 0°C TO 85°C

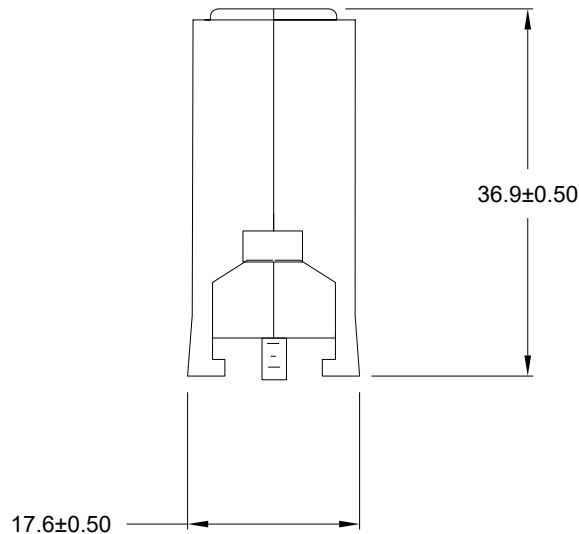
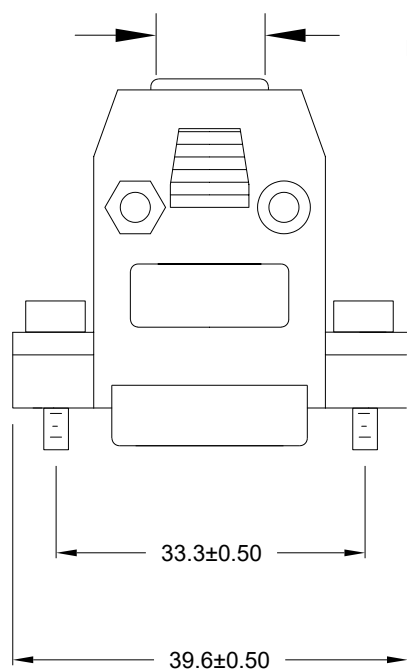

**977-015-0Y0 R YY 1**

SERIES \_\_\_\_\_  
 POSITIONS \_\_\_\_\_  
 015 \_\_\_\_\_  
 MATERIAL \_\_\_\_\_  
 010 = PLASTIC  
 020 = METALIZED PLASTIC  
 RoHS COMPLIANT \_\_\_\_\_  
 COLOR \_\_\_\_\_  
 03 = GREY (ONLY USE WITH 010 OPTION ABOVE)  
 12 = METALIZED (ONLY USE WITH 020 OPTION ABOVE)  
 PUT-UP \_\_\_\_\_  
 1 = KIT

RoHS COMPLIANT

UNITS = mm

DO NOT SCALE FROM DRAWING



THESE DRAWINGS AND SPECIFICATIONS ARE THE PROPERTY OF NorComp AND SHALL NOT BE REPRODUCED, COPIED OR USED AS THE BASIS FOR THE MANUFACTURE OR SALE OF APPARATUS WITHOUT WRITTEN PERMISSION.

DRAWN:

J. KADEL

DATE:

08/22/2019

NorComp

SCALE:

NTS

SHEET

OF

1

1

REV

2

DWG NO.

977-015-0Y0RYY1