

HONEYWELL PART NUMBER
89638

REV	DOCUMENT	CHANGED BY	CHECK
A	0010794	DVM 31JAN05	AK

SERVICE PART:
1 - KEY, DOUBLE SIDED KEY CUT (KEY CODE 6896)

NOTE
1 - SERVICE KIT TO BE PACKAGED PER PACK OP: 994400

DESIGN UNITS: INCH		DRAWN	DVM	31JAN05
TOLERANCES UNLESS NOTED:		CHECK	AK	31JAN05
NO PLACE	X ±	THIS DRAWING COVERS A PROPRIETARY ITEM AND IS THE PROPERTY OF HONEYWELL. THIS DRAWING IS NOT TO BE COPIED OR USED WITHOUT THE PERMISSION OF HONEYWELL.		
ONE PLACE	.X ±			
TWO PLACE	.XX ±			
THREE PLACE	.XXX ±			
FOUR PLACE	.XXXX ±			
ANGLES	X ±	INTERPRET PER ASME Y14.5M-1994 OTHER HONEYWELL ENGINEERING STANDARDS MAY APPLY		
THIRD ANGLE PROJECTION		Pro/ENGINEER		2D

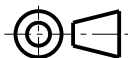

Honeywell			
TITLE SERVICE KIT KEY SWITCH			
SIZE	TYPE	DRAWING NAME	REV
A	E	89638	A
SCALE	-	SHEET 1 OF 1	

Downloaded By: Heckman, Steven - 08 December 2022 21:23:01 UTC
HEC: EAR99 TEC: EAR99 GOV: ESO1.0

89638 A Released Honeywell proprietary & Confidential