



Main

| | |
|---------------------------------------|--|
| Range of Product | Harmony 9001K |
| Accessory / Separate Part Type | Legend plate |
| Accessory / separate part category | Marking accessory |
| Accessory / separate part destination | Control and signalling units Ø 30 mm (metal range) |
| Label dimensions | 40 x 43 mm |
| Marking | White PULL TO START/PUSH TO STOP black |
| User Language | English |

Complementary

| | |
|-------------------|------------------------|
| Mounting diameter | 1.18 in (30 mm) |
| Material | Aluminium |
| Net Weight | 0.01 lb(US) (0.005 kg) |

Ordering and shipping details

| | |
|-----------------------|---------------------------------|
| Category | 21433 - 9001 ACCESS FOR K,KX,SK |
| Discount Schedule | CS1 |
| GTIN | 3389110946277 |
| Nbr. of units in pkg. | 1 |
| Package weight(Lbs) | 0.16 oz (4.536 g) |
| Returnability | No |
| Country of origin | MX |

Packing Units

| | |
|------------------------|------------------|
| Unit Type of Package 1 | PCE |
| Package 1 Height | 0.12 in (0.3 cm) |
| Package 1 width | 1.77 in (4.5 cm) |
| Package 1 Length | 1.77 in (4.5 cm) |

Offer Sustainability

| | |
|----------------------------|--|
| Sustainable offer status | Green Premium product |
| California proposition 65 | WARNING: This product can expose you to chemicals including: Nickel compounds, which is known to the State of California to cause cancer, and Di-isodecyl phthalate (DIDP), which is known to the State of California to cause birth defects or other reproductive harm. For more information go to www.P65Warnings.ca.gov |
| REACH Regulation | REACH Declaration |
| EU RoHS Directive | Pro-active compliance (Product out of EU RoHS legal scope) EU RoHS Declaration |
| Mercury free | Yes |
| RoHS exemption information | Yes |
| China RoHS Regulation | China RoHS Declaration |
| Environmental Disclosure | Product Environmental Profile |

Contractual warranty

| | |
|----------|-----------|
| Warranty | 18 months |
|----------|-----------|

Dimensions

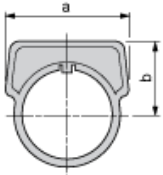

| a | | b | |
|------|------|------|------|
| mm | in. | mm | in. |
| 41.3 | 1.62 | 24.6 | 0.97 |