

**2216 AWG Nylon Insulated Spade Terminals with Support Sleeve**

**Material:** Tin Plated Copper with Butted Seam

**Insulation Material:** Red 6/6 Nylon with Funnel Entry Copper Support Sleeve

**Maximum Electrical Current:** 18 Amps

**Barrel ID (d1):** .067

**Maximum Electrical Rating:** 75°C, 600V

**Barrel OD (D):** .177

**Material Thickness (T):** .030

**Barrel Length (E):** .433

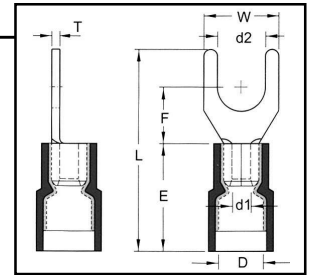

HOFFMAN PART NO.	STUD SIZE	DIMENSIONS (INCHES)				UL	TAPE MOUNTED REEL QT	DIE FOR TAPE MOUNTED	HAND TOOL
		STUD DIAMETER	TONGUE WIDTH	STUD CLEARANCE	LENGTH				
		d2	W	F	L				
FND2216M3A	4	0.126	0.224	0.256	0.866	Y	1000	3V2216	YNM2210D
FND2216YS3A	6	0.146	0.252	0.256	0.866	Y	1000	3V2216	YNM2210D
FND2216S3A	6	0.146	0.283	0.256	0.866	Y	1000	3V2216	YNM2210D
FND2216S4A	8	0.169	0.283	0.256	0.866	Y	1000	3V2216	YNM2210D
FND2216M5A	10	0.209	0.319	0.256	0.866	Y	1000	3V2216	YNM2210D
FND22166A	1/4	0.252	0.472	0.433	1.102	Y	1000	3V2216	YNM2210D

**1614 AWG Nylon Insulated Spade Terminals with Support Sleeve**

**Material:** Tin Plated Copper with Butted Seam

**Insulation Material:** Blue PVC Vinyl with Funnel Entry Copper Support Sleeve

**Maximum Electrical Current:** 30 Amps

**Barrel ID (d1):** .091

**Maximum Electrical Rating:** 75°C, 600V

**Barrel OD (D):** .205

**Material Thickness (T):** .031

**Barrel Length (E):** .433

HOFFMAN PART NO.	STUD SIZE	DIMENSIONS (INCHES)				UL	TAPE MOUNTED REEL QT	DIE FOR TAPE MOUNTED	HAND TOOL
		STUD DIAMETER	TONGUE WIDTH	STUD CLEARANCE	LENGTH				
		d2	W	F	L				
FND1614YS3A	6	0.146	0.236	0.256	0.866	Y	1000	3V1614	YNM2210D
FND1614S3A	6	0.146	0.283	0.256	0.866	Y	1000	3V1614	YNM2210D
FND1614YS4A	8	0.169	0.252	0.256	0.866	Y	1000	3V1614	YNM2210D
FND1614S4A	8	0.169	0.283	0.256	0.866	Y	1000	3V1614	YNM2210D
FND16144A	8	0.169	0.311	0.256	0.866	Y	1000	3V1614	YNM2210D
FND1614M5A	10	0.209	0.311	0.256	0.866	Y	1000	3V1614	YNM2210D
FND16145A	10	0.209	0.366	0.256	0.866	Y	1000	3V1614	YNM2210D
FND16146A	1/4	0.252	0.472	0.433	1.102	Y	1000	3V1614	YNM2210D

