

1592 CLOSED

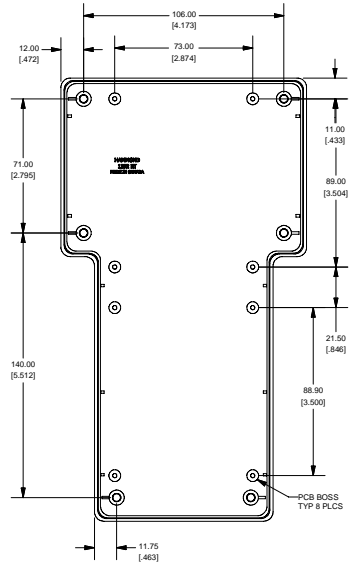

FRONT VIEW OF BOX

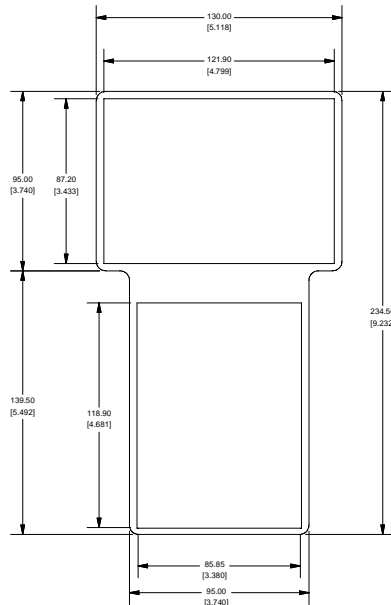
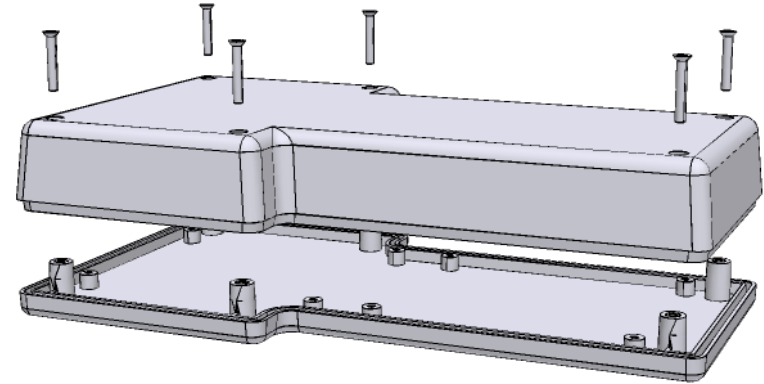
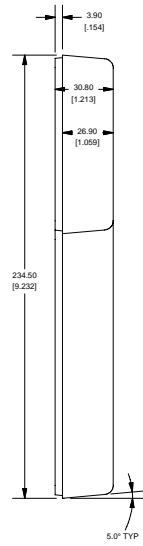

FRONT VIEW OF LID

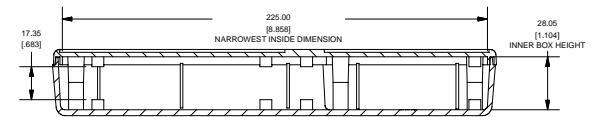
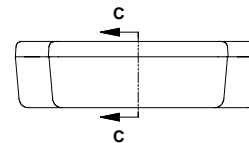
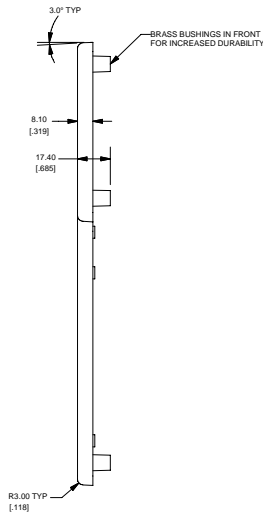

SECTION C-C

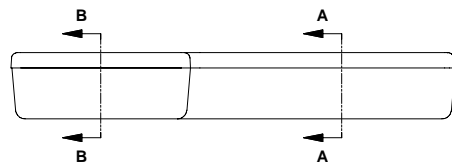

SIDE VIEW OF ASSEMBLY

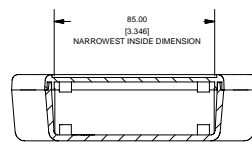

SECTION A-A

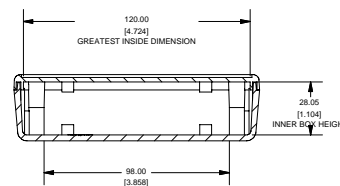

SECTION B-B



www.hammondmfg.com

PART NUMBERS	
1592 Enclosure	
Grey case with solid display area	1592ETSDGY
Black case with solid display area	1592ETSDBK
Accessories	
Gasket kit with 76 cm (30") of gasket (for one unit)	1592ETG
Rubber Feet (package of 6)	1592ETRF
Magnetic Strip 7.62 cm (3") square	1592ETM
Velcro Mounting Tab	1592ETV
M3 - 0.5 x 20mm countersunk flat head replacement screws	1594MS100