

THIS IS A C.A.D. GENERATED DRAWING
DO NOT MAKE MANUAL REVISIONS TO MASTER.

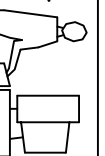

ISSUE NUMBER
ORIGINAL

①

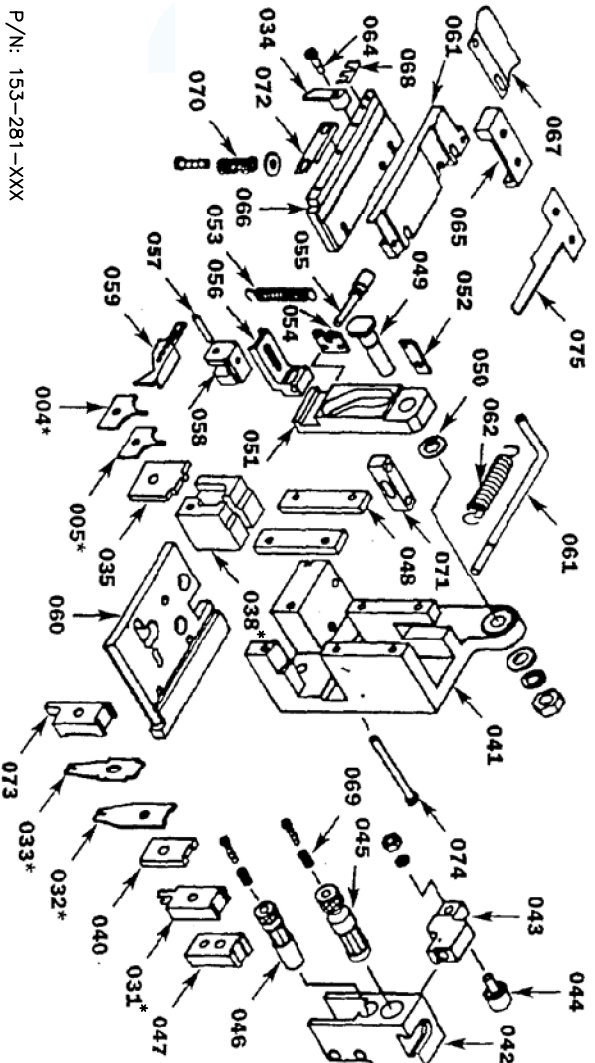
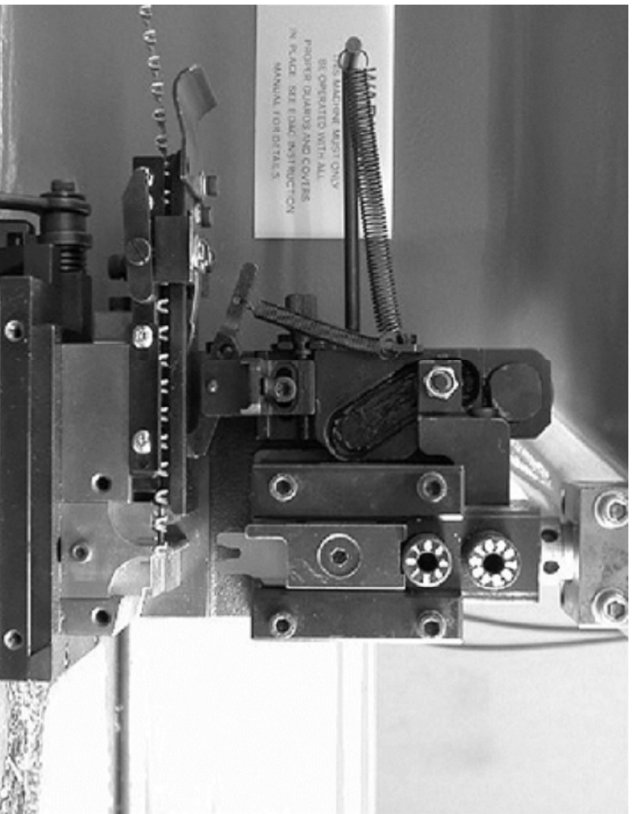

P/N: 153-281-XXX

| | |
|---------------|------------|
| PRESS TYPE | EDAC PRESS |
| STROKE LENGTH | 30.00 MM |
| SHUT HEIGHT | 119.55 MM |
| AWG | 22-26 |

| REPLACEMENT PUNCH & DIE PARTS | | | | | |
|-------------------------------|-------------|--------------|-------------------|---------------|--------------|
| INSULATOR ANVIL | WIRE ANVIL | WIRE CRIMPER | INSULATOR CRIMPER | CUT OFF PUNCH | ANVIL HOLDER |
| 153-281-004 | 153-281-005 | 153-281-032 | 153-281-033 | 153-281-031 | 153-281-038 |

NOTES:

- 1- THIS APPLICATOR IS DESIGNED TO BE USED ON EDAC CRIMPING MACHINE 516-280-700.
- 2- THIS APPLICATOR IS DESIGNED FOR CRIMPING EDAC CONTACT P/N 153-290-291.
- 3- FOR THE DEFINITION OF STROKE LENGTH AND SHUT HEIGHT, APPLICATOR SETUP AND OPERATING INSTRUCTION, PLEASE REFER TO DOCUMENT "APPLICATOR INSTRUCTION MANUAL EDAC PRESS".

153 SERIES APPLICATOR FOR EDAC PRESS

ACAD REFERENCE NO. 153-280-750

DRAWN: K.L. DATE: OCT.28/2020

CHECKED: R.S.M. DATE: OCT.28/2020

SCALE: N.T.S. SHEET 1 OF 1

DRAWING NUMBER

153-280-750

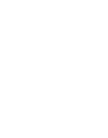

EDAC INC
TORONTO, ONTARIO
CANADA

YOUR CONNECTION TO QUALITY & SERVICE

THESE DRAWINGS AND SPECIFICATIONS ARE THE PROPERTY OF EDAC INC. AND SHALL NOT BE REPRODUCED, OR COPIED OR USED AS THE BASIS FOR THE MANUFACTURE OR SALE OF APPARATUS WITHOUT WRITTEN PERMISSION.

ISSUE

1