

# LIGHTOWL PASSIVE INFRARED SENSOR

CEILING AND WALL MOUNT OCCUPANCY SENSORS

## LIGHTOWL



### FEATURES

- IntelliDAPT™ self-adaptive technology-no manual adjustment required
- All-digital passive infrared (PIR) sensor
- Non-volatile memory for sensor settings
- Relay and photocell control
- Low voltage device: 24VDC
- 5 year limited warranty



### SPECIFICATIONS

#### CONSTRUCTION

- Casing - Rugged, high-impact, injection-molded plastic KJB ABS Cycolac (UL-945VA)
- Color-coded leads are 6" long (154.4mm)
- 5.0 oz (142g)
- Off-white
- Red - infrared motion

#### INSTALLATION - MOUNTING

- LOIRWVRP - Max mounting height: 12ft
- LOIRHBRP - Max mounting height: 30ft

#### ELECTRICAL

- 24VDC, 33 mA (uses UVPP and MP-Series power pack-not included)
- 24VDC active high-logic control signal with short circuit protection and dry contact (See: RP Option)

#### OPERATION

- Auto reset from test setting
- Self-adjusting timer

#### OPERATION CONTINUED

- Self-adjusting passive infrared and acoustic thresholds
- Automatic false-on/false-off corrections
- Dual-element pyrometer and 12-element cylindrical rugged lens

#### OPERATION CONTINUED

- Automatic mode: 8–30 minutes (self-adjusts based on occupancy)
- Test mode: 8 seconds (for an easy check at installation)

#### OPERATING ENVIRONMENT

- Indoor use only
- Operating temperature: 32°F to 104°F (0°C to 40°C)
- Relative humidity (non-condensing): 0% to 95%

#### COVERAGE

- LOIRWVRP (Wide View): 1,600 square feet (487.68 square meters)

#### COVERAGE CONTINUED

- LOIRHBRP (High Bay): 120 linear feet

#### RP OPTION

- Relay and photocell included
- Relay: N/O + N/C contacts; SPDT; 500 mA rated @ 24 VDC; three-wire isolated relay
- Photocell: adjustable natural-light override ranges from 0 to 100 foot-candles (0–1,000 lux)
- Factory set at 3,000 lux (disable photocell)

#### CERTIFICATIONS

- UL and cUL listed

#### WARRANTY

- 5 year warranty

### ORDERING GUIDE

Example: LOIRWVRP

CATALOG #

Model	Technology	Relay/Photocell Option
LO LightOWL Sensor	IRWV Passive Infrared Wide View IRHB Passive Infrared High Bay	RP Relay Photocell

# LIGHTOWL PASSIVE INFRARED SENSOR

CEILING AND WALL MOUNT OCCUPANCY SENSORS

## DIMENSIONS

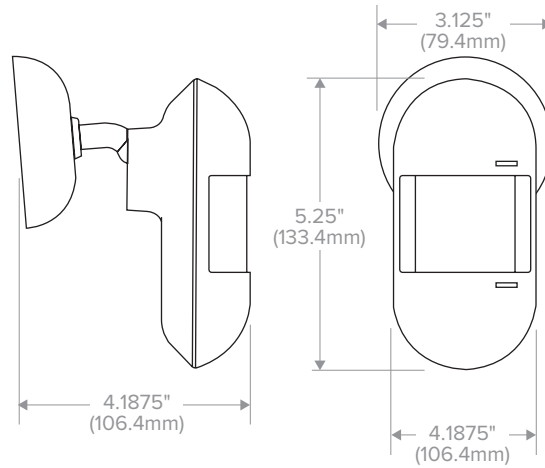

## ADDITIONAL INFORMATION

### Coverage Patterns

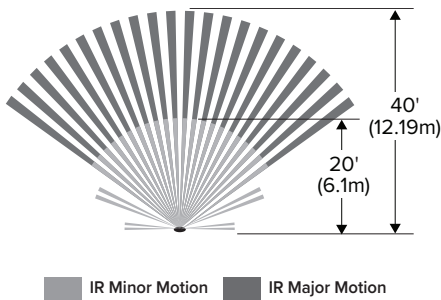

LOIRWVRP - Coverage Range (Top View)

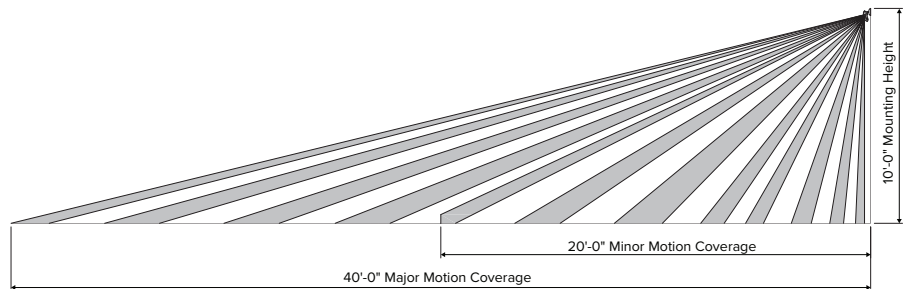

LOIRWVRP - Coverage Range (Side View)

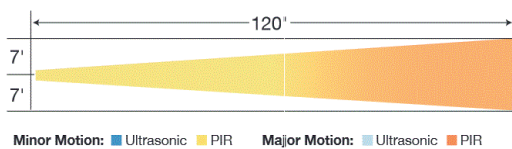

LOIRHBRP - Coverage Range (Top View)

# LIGHTOWL PASSIVE INFRARED SENSOR

CEILING AND WALL MOUNT OCCUPANCY SENSORS

## ADDITIONAL INFORMATION (CONTINUED)

### Wiring Diagrams

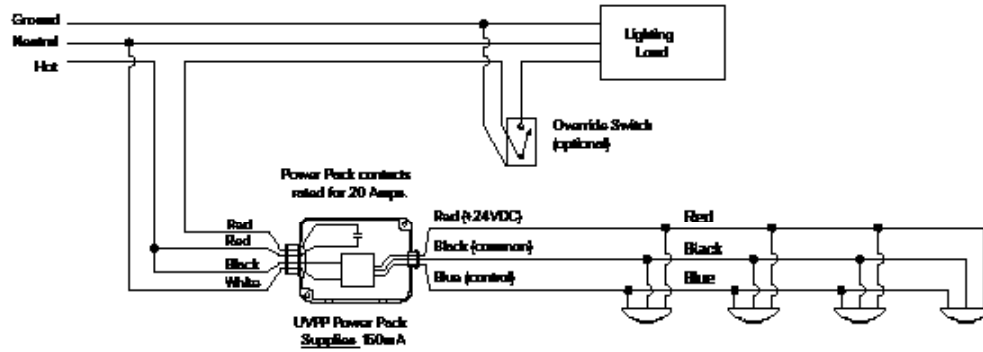

**NOTE:**

1 DO NOT attempt to power more than 4 devices, be it sensors or other packs, from a single power pack.

1 Circuit with up to 4 Sensors and UVPP

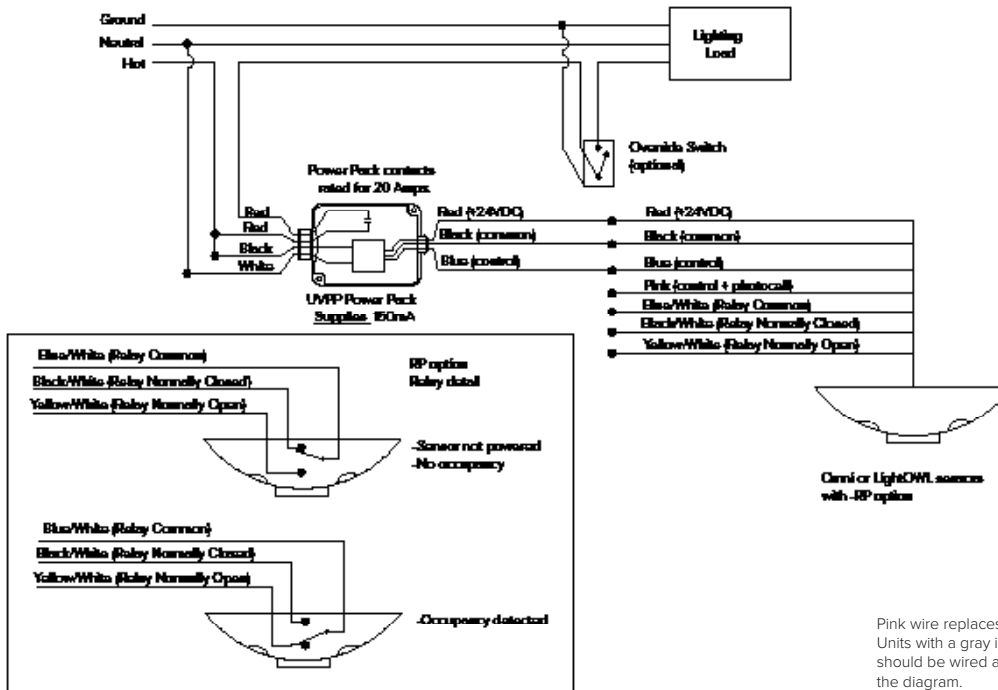

1 Circuit with RP Option Wiring

# LIGHTOWL PASSIVE INFRARED SENSOR

CEILING AND WALL MOUNT OCCUPANCY SENSORS

## ADDITIONAL INFORMATION (CONTINUED)

### Wiring Diagrams

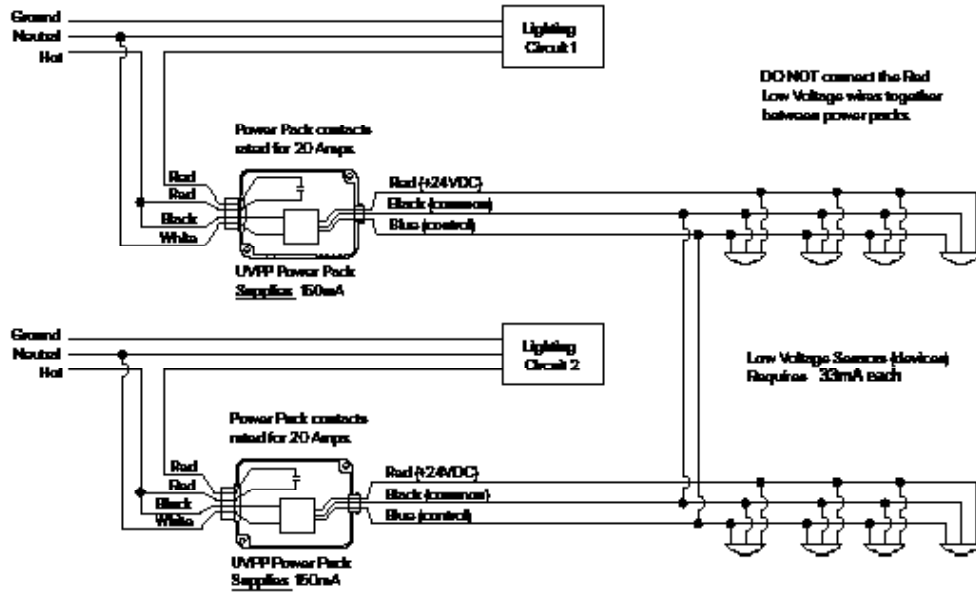

**NOTES:**

1. Lighting load turns on when at least one sensor detects motion
2. DO NOT attempt to power more than 4 devices, be it sensors or slave packs, from a single power pack
3. No more than 4 power packs should be connected in this way

2 Circuits with 5 to 8 Sensors