

Panel mounting frames - CUC-V04-F-POBK-90 - 1407411

Please be informed that the data shown in this PDF Document is generated from our Online Catalog. Please find the complete data in the user's documentation. Our General Terms of Use for Downloads are valid (<http://phoenixcontact.com/download>)



Panel mounting frames, Degree of protection: IP65/67, Material: Plastic



Key Commercial Data

Packing unit	1 STK
Weight per Piece (excluding packing)	20.000 g
Custom tariff number	85389099
Country of origin	Germany

Technical data

Mechanical characteristics

Standards/specifications	IEC 61076-3-106
Locking type	Push Pull
Insertion/withdrawal cycles	≥ 750
Color	black

Ambient conditions

Ambient temperature (operation)	-40 °C ... 70 °C
Ambient temperature (storage/transport)	-40 °C ... 70 °C
Degree of protection	IP65

Material data

Flammability rating according to UL 94	V0
Housing material	Plastic

Standards and Regulations

Standards/regulations	IEC 61076-3-106
-----------------------	-----------------

Panel mounting frames - CUC-V04-F-POBK-90 - 1407411

Technical data

Standards and Regulations

Flammability rating according to UL 94	V0
--	----

Drawings

Dimensional drawing

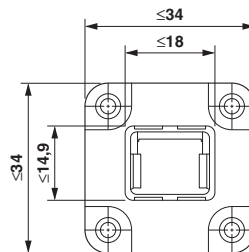

Panel mounting frame dimensional drawing

Classifications

eCl@ss

eCl@ss 4.0	272607xx
eCl@ss 4.1	27260701
eCl@ss 5.0	27260701
eCl@ss 5.1	27260701
eCl@ss 6.0	27261207
eCl@ss 7.0	27440210
eCl@ss 8.0	27440210
eCl@ss 9.0	27440210

ETIM

ETIM 3.0	EC002310
ETIM 4.0	EC002310
ETIM 5.0	EC002310

UNSPSC

UNSPSC 6.01	31261501
UNSPSC 7.0901	31261501
UNSPSC 11	31261501
UNSPSC 12.01	31261501
UNSPSC 13.2	31261501

Panel mounting frames - CUC-V04-F-POBK-90 - 1407411

Accessories

Accessories

Female insert

RJ45 socket insert - CUC-V04-BU-90 - 1407408



RJ45 socket insert, Type: RJ45, IP20, Degree of protection: IP20, Number of positions: 8, CAT5, Material: Copper alloy, Connection method: Solder connection