

Specification for:

0R49938EC

110 Delta Drive
Pittsburgh, PA 15238
Phone: 412/696-1333
Fax: 412/696-0333
Email: magnetics@spang.com

DIMENSIONS

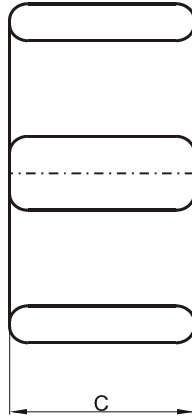
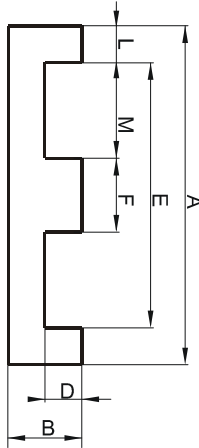

(mm)	Nominal:	Tol. min.:	Tol. max.:
A	102.0	-1.0	+ 1.0
B	20.3	-0.25	+ 0.25
C	37.5	-0.4	+ 0.4
D	13.3	-0.25	+ 0.25
E	86.0	-1.0	+ 1.0
F	14.0	-0.25	+ 0.25
L	8.0 Ref.		
M	36.0 Ref.		
Eff. Parameters			
Ae mm ²	Amin mm ²	le mm	Ve mm ³
540	525	148	79800

INDUCTANCE

AL value (nH)	Test conditions
Nom: 9810 Min.: 7358	10 kHz, < 0.5 mT, 25 °C

MARKING

0R49938EC PXXXXX

CORE LOSSES

P _i max	Test conditions
112 mW/cm ³ (8.94 W/set)	100 kHz, 100 mT, 100 °C

NOTE

Spec. modifications	Previous	Revised
2005-06-22	L=8.0±0.25 M=35.94±0.51 Losses: General R material	L=8.0 Ref. M=36.0 Ref. Losses: Detail as indicated