

# 2-Port IP67 802.3bt to 802.3at PoE Gigabit Switch

# CyberData

The IP Endpoint Company

The CyberData industrial IP67 rated Gigabit switch supports a PoE 802.3bt Type 4 (90W) input with two 802.3at (29.5W) outputs. This product can be used to split a single PoE network cable into two separate 802.3at PoE drops for devices in an outdoor or hazardous environment. Ideal for large installations, the device can support data transmission and PoE power supply up to 100m from the switch output ports.

In one outdoor example configuration, one of the Gigabit output ports can drive an 802.3at security camera and the other Gigabit port can be connected to a [CyberData SIP IP66 Outdoor Horn](#). Please contact our [Design Services](#) department if you have questions about your devices and power requirements.

The unit is complete and no external power supplies would be required.

## Technical Features

### Power

- Fully compliant to IEEE 802.3af/at/bt standard
- 1 Power Device (PD) input port 802.3bt Type 4 and Type 3, or 802.3at
- 2 Power Source Equipment (PSE) output ports 802.3at

### Data

- Power and data carried over the same cable up to 100m from PSE
- All ports are 10/100/1000Mbps (10BASE-T, 100BASE-TX, 1000BASE-T) auto sensing based upon the port's individual connection
- Each port has auto MDI-X
- 802.11q VLAN tagging
- Automatic address learning, address aging and address migration
- Supports 9216-byte jumbo frame length

### Notification

- Link/Status LEDs



### Specifications

Ethernet I/F	10/100/1000 Mbps, Auto MDI-X, RJ45
Power Distribution*	
Input:	Corresponding Output:
• 802.3bt Type 4 (90W)	each 802.3at output port supports up to 29.5W
• 802.3bt Type 3 (60W)	802.3at output port 1 supports 29.5W and 802.3at output port 2 supports 25W
• 802.3at (25.5W)	each 802.3at output port supports 10W
IP Rating	IP67
Impact Rating	IK10
Operating Range	Temperature: -20 C to 60 C (-4 F to 140 F) Humidity: 10-90%, non-condensing
Storage Temperature	Temperature: -40 C to 80 C (-40 F to 176 F)
Storage Altitude	Up to 15,000 ft. (4573 m)
Dimensions**	6.69 in. [169.8 mm] Length (with cable glands) 5.93 in. [150.5 mm] Length (base plate) 2.87 in. [72.9 mm] Width 1.72 in. [43.8 mm] Height
Weight	0.85 lbs [0.39 kg]
Boxed Weight	1.37 lbs [0.62 kg]
Compliance	CE: EMC Directive – Class A EN 55032, EN 55035, & EN 61000, Safety Directive 2001/95/EC; CISPR 32; FCC Part 15 Subpart B; ICES-003; RoHS Compliant
Warranty	2 Years Limited
Part Number	011539

\* If you have questions about your devices and power requirements, please contact us.

\*\*Dimensions are measured from the perspective of the product being upright with the front of the product facing you.

## 2-Port IP67 802.3bt to 802.3at PoE Gigabit Switch

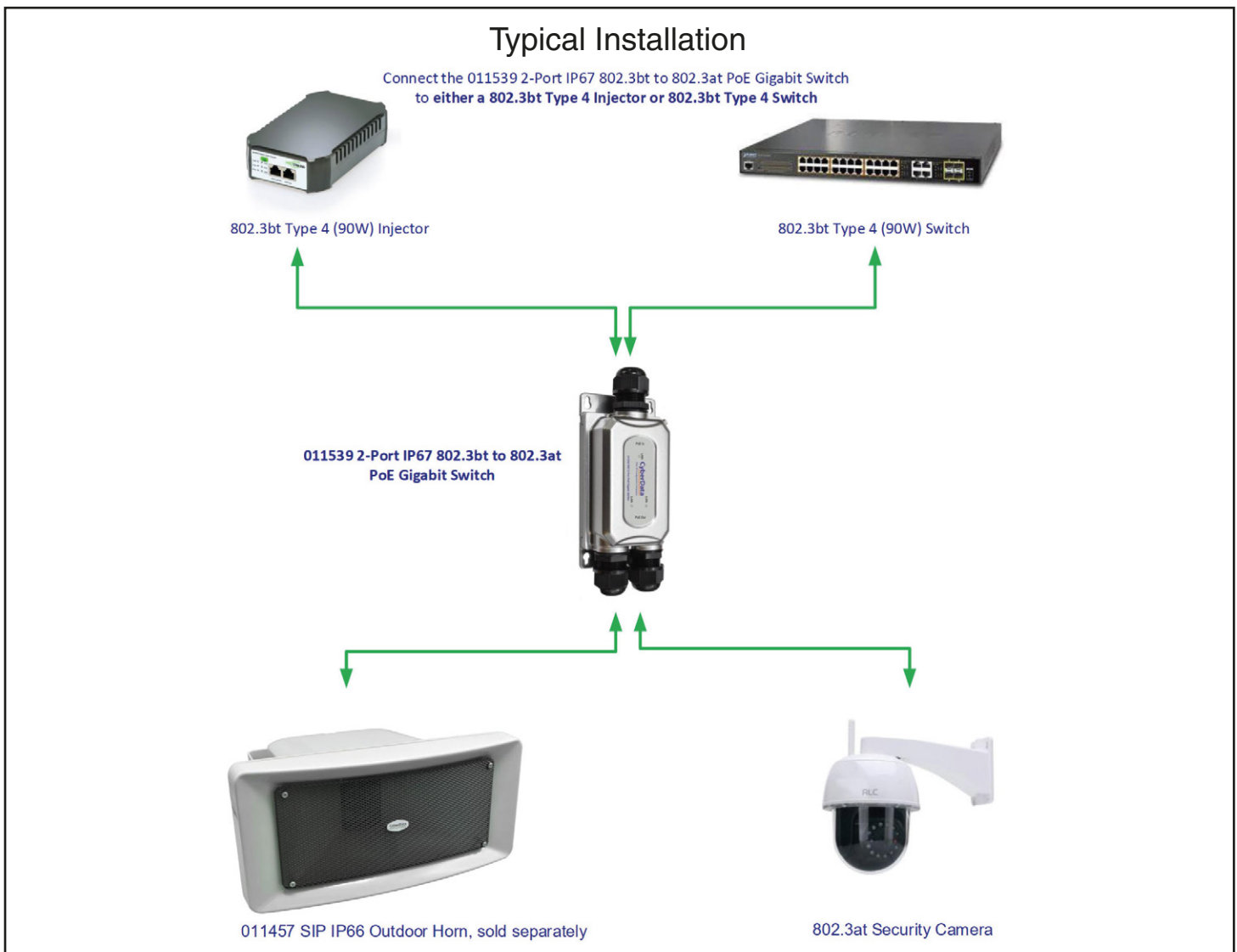
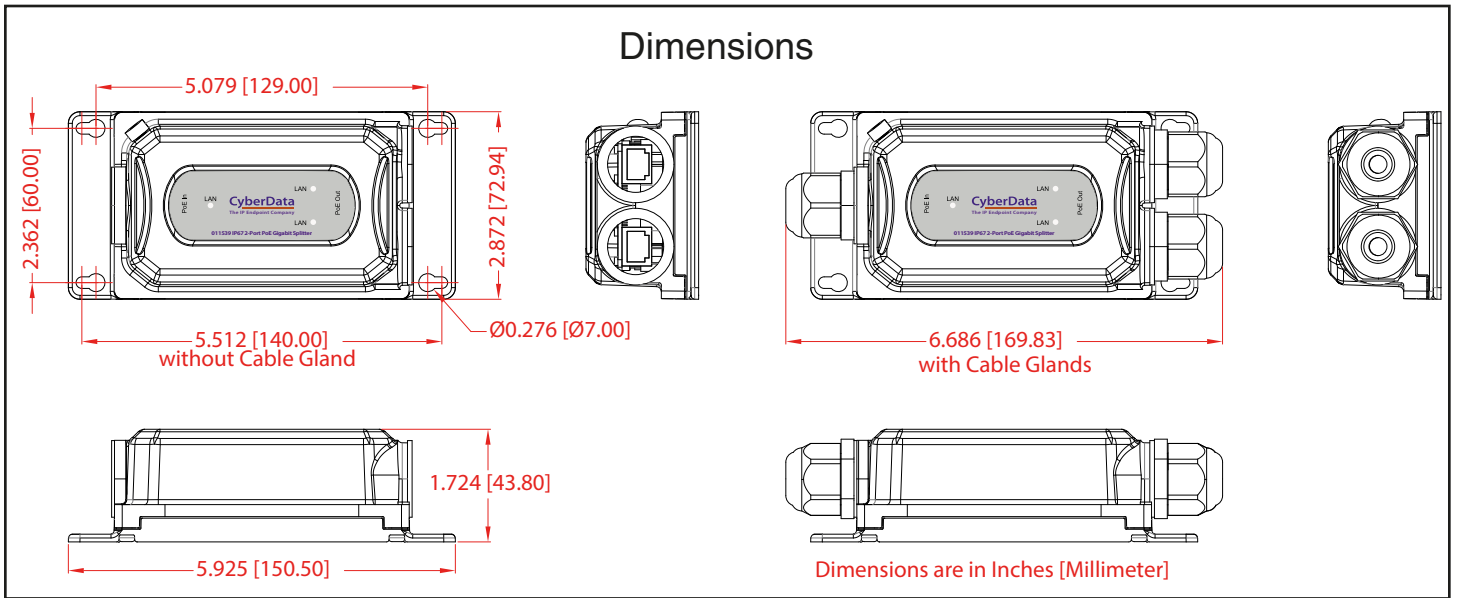

# 2-Port IP67 802.3bt to 802.3at PoE Gigabit Switch

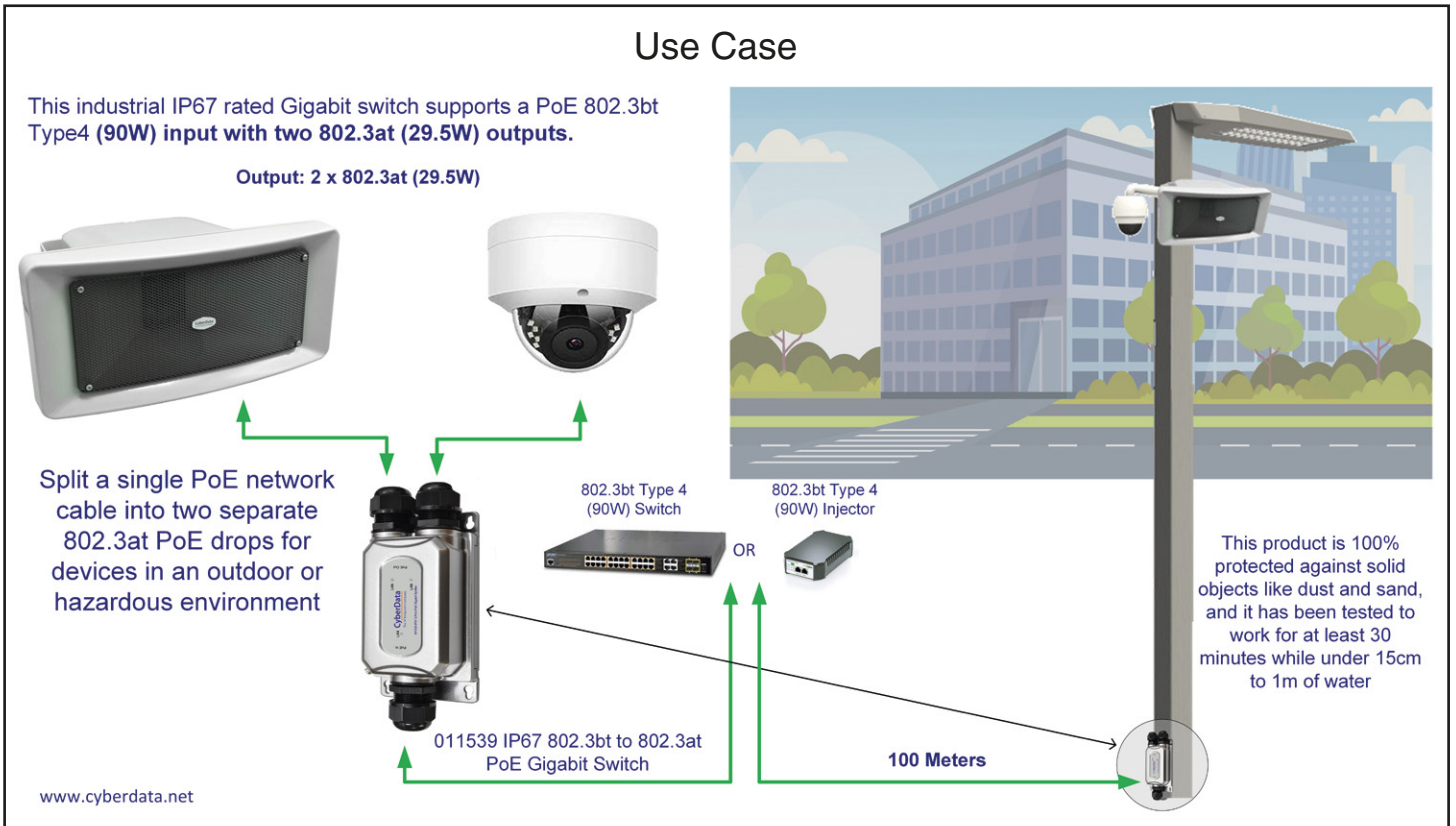

## Related Products:

### SIP Enabled



011457 SIP IP66 Outdoor Horn



011479 SIP Outdoor RGB (Multi-Color) Strobe



011491 SIP Outdoor Call Button



011405 SIP Loudspeaker Amplifier (PoE)



011471 IP66 Analog Horn

### InformaCast Enabled



011472 InformaCast Enabled IP66 Outdoor Horn



011489 InformaCast Enabled Outdoor RGB (Multi-Color) Strobe



011407 InformaCast Enabled Loudspeaker Amplifier (PoE)



011471 IP66 Analog Horn