

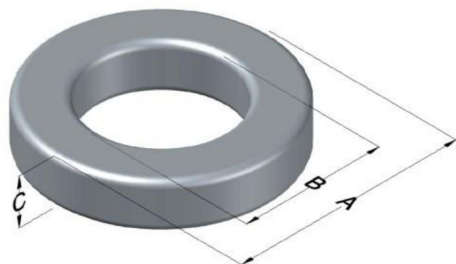

**0076121A7**

110 Delta Drive  
 Pittsburgh, PA 15238  
 NAFTA Sales: (1)800-245-3984  
 HK Sales : (852)3102-9337  
 magnetics@spang.com  
 www.mag-inc.com



Kool M $\mu$ Hf Permeability ( $\mu$ )	A <sub>L</sub> (nH/T <sup>2</sup> )	Core Marking			Coating Color
		Lot Number	Part Number	Inductance Grade	
60	35 $\pm$ 8%	XXXXXX	76121A7	N/A	Black

Dimensions					Packaging	
Uncoated			Coated Limits			
	(mm)	(in)	(mm)	(in)		
OD (A)	16.59	0.653	17.27	0.680	max	Cardboard cut-outs Box Qty = 2000 Pcs
ID (B)	10.16	0.400	9.53	0.375	min	
HT (C)	6.35	0.250	7.11	0.280	max	

Electrical Characteristics			Physical Characteristics						
Watt Loss @ 100kHz, 100mT (max, mW/cm <sup>3</sup> )	DC Bias min (Oersteds)		Voltage Breakdown wire-to-wire min (V <sub>AC</sub> )	Break Strength (min, kg)	Window Area, W <sub>A</sub> (mm <sup>2</sup> )	Cross Section, A <sub>e</sub> (mm <sup>2</sup> )	Path Length, L <sub>e</sub> (mm)	Volume V <sub>e</sub> (mm <sup>3</sup> )	Weight (g)
	80%	50%							
450	45.0	100	1250	23.1	71.2	19.2	41.2	791	5.1

Winding Information					Temperature Rating	
Winding Length per Turn				Wound Coil Dimensions (mm)		
Winding Factor	(mm)	Winding Factor	(mm)	40% Winding Factor	OD	18.8
					0%	22.0
20%	24.4	45%	27.6	Completely Full Window	Max OD	23.7
25%	25.0	50%	28.3		Max HT	15.2
30%	25.6	60%	29.7	Surface Area (mm <sup>2</sup> )		
35%	26.2	70%	31.4	Unwound Core:	920	
				40% Wound:	1300	

Temperature Rating	
Curie Temp (°C):	500 °C
Coating Temp: (Continuous, up to; °C)	200 °C
<b>Notes:</b>	

