

GlobTek, Inc. www.globtek.com 186 Veterans Drive, Northvale, NJ 07647 Tel. (201) 784-1000 Fax (201) 784-0111	Drawing Title: DC POWER JACK, REWIRABLE; FEMALE BARREL 5.5 X 2.1 X 14MM <hr/> Model No. Connector <hr/> Part No./Ordering No. V02 <div style="text-align: right;">Rev B</div>	
---	--	--

In Addition to GlobTek Inc.'s renewed ISO9001:2008 - Quality Management System Certification, GlobTek Inc. is now certified to:

ISO13485:2003 - Medical Devices Quality Management System Certification

ISO14001:2004 - Environmental Management System Certification

ISO Certificates are available online at <http://www.globtek.com/iso-certificates/>

The acceptance of this specification and use of the product described in this document indicates the acceptance and binding of the customer to Globtek TERMS AND CONDITIONS (attached to the end of this document), which supersede all other agreements, terms, and conditions (<http://en.globtek.com/terms-and-conditions/>).

Prop 65 Statement: <https://en.globtek.com/prop-65-statement.pdf>

Footnote:

GlobTek Inc. will not be liable for the safety and performance of these power supplies if unauthorized access and repair occurs. End user should consult applicable UL, CSA or EN standards for proper installation instruction.

Limitation of Use:

GlobTek products are intended for use with commercial, medical, and/or industrial equipment only. GlobTek product are not authorized for use as mission critical components in life support hazardous environment, nuclear or aircraft applications without prior written approval from the CEO of GlobTek Inc.

Contents of this document are subject to change without prior notice.

Customer Approval of Specification:

Please approve, sign and send back to GlobTek so we can complete order processing.

A delay in receipt of this form will delay delivery schedule.

Company Name:

Customer P/N:

Quote Number:

Date:

Authorized Representative Name:

Authorized Representative Signature:

GlobTek, Inc. www.globtek.com 186 Veterans Drive, Northvale, NJ 07647 Tel. (201) 784-1000 Fax (201) 784-0111	Drawing Title: DC POWER JACK, REWIRABLE; FEMALE BARREL 5.5 X 2.1 X 14MM		
	Model No. Connector		
	Part No./Ordering No. V02	Rev B	

REVISION HISTORY

REV	DESCRIPTION	SUB	DATE	APPROVED
B	Revision of backshell dimensions, values, and spec format	DR	02/24/2022	QA
A	Initial release	DR	04/28/2020	QA

AGENCY ONLINE DOCUMENTS

RoHS/RoHS3 Declaration https://www.globtek.com/pdf/rohs_cert/01t30000002p9QGAAY

REACH Declaration https://www.globtek.com/pdf/iso_certificates/REACH.pdf

Conflict Minerals Declaration <https://www.globtek.com/pdf/conflict-minerals.pdf>

Prop 65 Statement <https://en.globtek.com/prop-65-statement.pdf>

IPXY rating is based on 3rd party testing and customers should check suitability and test system level IPXY rating before ordering.

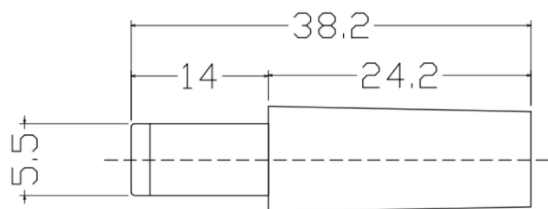

Electrical parameter

Project	Parameter
Connector pin out	
Current rating/Voltage	5A/50V
Insulation resistance	$\geq 100M\Omega$
Contact Impedance	$\leq 50m\Omega$
Withstanding voltage	$\geq 1500VAC/1min$
Durability	$\geq 1X100000$ Cycles

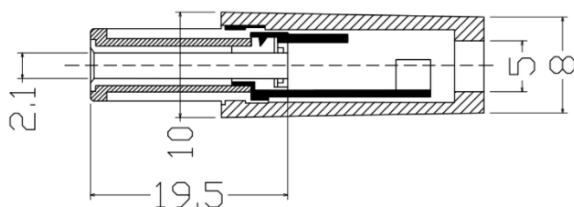

GlobTek, Inc. www.globtek.com 186 Veterans Drive, Northvale, NJ 07647 Tel. (201) 784-1000 Fax (201) 784-0111	Drawing Title: DC POWER JACK, REWIRABLE; FEMALE BARREL 5.5 X 2.1 X 14MM	
	Model No. Connector	
	Part No./Ordering No. V02	Rev B

PACKAGING

Packing Spec P/N:	
Box Qty:	1
Gift Box Size (mm):	
Gift Box Color:	White
Master Carton Size (mm):	TBD
Master Carton Cubic Volume (m³): 0.00	
Master GW (Kg):	kg
wt Ea. (Kg):	kg
wt Ea. (Kg):	kg
LABEL SPECS: ,	
PACK SPEC:	