

GlobTek, Inc. www.globtek.com 186 Veterans Drive, Northvale, NJ 07647 Tel. (201) 784-1000 Fax (201) 784-0111	Drawing Title: GTM96600-4520-T2, ICT / ITE / Medical Power Supply/Class 2/Household Power Supply, Efficiency Level: USA DOE Level VI / Eco-design Directive 2009/125/EC, (EU) 2019/1782, Case Color/Style: GlobTek Black, Desktop/External, Regulated Switchmode AC-DC Power Supply AC Adaptor, Input Rating: 100-240V~, 50-60Hz, IEC 60320/C8, Output Rating: 45W, 20.0V@2.25A, Output Configuration: 1200 mm, 20/1C + Shield Cond, UL 1185, Female Barrel 4.0*1.7*12mm or Equal, Ferrite: Core: RH 14.2*28.5*10, GlobTek Black, GT Cord # C26418, Pin Out: Center Positive (+V), symbol compliant with IEC 60417 symbol no. 5926, Blades/Input Cord: (Order Separately), Approvals: Korea (41V-54V Only); CB 60335; Fuse 60335; ETL; EAC; cETLus 60601-1; CB 62368; India BIS; UKCA; UL 1310; Conforms to 62368-1; CB 61158; FCC; IP41; Morocco; Korea (9-15V Only); ETL 62368; Korea (16,18,19 and 20V only); Malaysia; IRAM; Korea (19V Only); PSE; PSE; PSE; China RoHS; Level VI; RoHS; Ukraine; VCCI; WEEE; ETL; CE; CB 60950; ETL 60950; S-Mark 60950; Double Insulation; RCM; CB 60601-1; S-Mark IEC/EN 60601-1; EAC; CCC; LPS 60950; South Africa;	
	Model No. GTM96600-4520-T2	
	Part No./Ordering No. TR9KZ2250EI212MEDRB	Rev B

In Addition to GlobTek Inc.'s renewed ISO9001:2015 - Quality Management System Certification, GlobTek Inc. is now certified to:

ISO13485:2016 - Medical Devices Quality Management System Certification

ISO14001:2015 - Environmental Management System Certification

ISO Certificates are available online at <https://www.globtek.com/iso-certificates/>

The acceptance of this specification and use of the product described in this document indicates the acceptance and binding of the customer to Globtek TERMS AND CONDITIONS (attached to the end of this document), which supersede all other agreements, terms, and conditions (<https://en.globtek.com/terms-and-conditions/>).

The purchaser of this product (Customer) agrees that it is their sole responsibility to determine suitability/fitness of the product described in this specification for their application and to take precautions for protection against any hazards attendant to the handling and use of the product.

Footnote:

GlobTek Inc. will not be liable for the safety and performance of these power supplies/battery packs if unauthorized access and repair occurs. End user should consult applicable UL, CSA or EN standards for proper installation instruction.

Limitation of Use:

GlobTek products are intended for use with commercial, medical, and/or industrial equipment only. GlobTek product are not authorized for use as mission critical components in life support hazardous environment, nuclear or aircraft applications without prior written approval from the CEO of GlobTek Inc.

Contents of this document are subject to change without prior notice.

Customer Approval of Specification:

Please approve, sign and send back to GlobTek so we can complete order processing.

A delay in receipt of this form will delay delivery schedule.

Company Name:

Customer P/N:

Quote Number:

Date:

Authorized Representative Name:

Authorized Representative Signature:

GloTek, Inc. www.globtek.com 186 Veterans Drive, Northvale, NJ 07647 Tel. (201) 784-1000 Fax (201) 784-0111	Drawing Title: GTM96600-4520-T2, ICT / ITE / Medical Power Supply/Class 2/Household Power Supply, Efficiency Level: USA DOE Level VI / Eco-design Directive 2009/125/EC, (EU) 2019/1782, Case Color/Style: GlobTek Black, Desktop/External, Regulated Switchmode AC-DC Power Supply AC Adaptor, Input Rating: 100-240V~, 50-60Hz, IEC 60320/C8 , Output Rating: 45W, 20.0V@2.25A, Output Configuration: 1200 mm, 20/1C + Shield Cond, UL 1185, Female Barrel 4.0*1.7*12mm or Equal, Ferrite: Core: RH 14.2*28.5*10, GlobTek Black, GT Cord # C26418, Pin Out: Center Positive (+V), symbol compliant with IEC 60417 symbol no. 5926, Blades/Input Cord: (Order Separately), Approvals: Korea (41V-54V Only); CB 60335; Fuse 60335; ETL; EAC; cETLus 60601-1; CB 62368; India BIS; UKCA; UL 1310; Conforms to 62368-1; CB 61158; FCC; IP41; Morocco; Korea (9-15V Only); ETL 62368; Korea (16,18,19 and 20V only); Malaysia; IRAM; Korea (19V Only); PSE; PSE; PSE; China RoHS; Level VI; RoHS; Ukraine; VCCI; WEEE; ETL; CE; CB 60950; ETL 60950; S-Mark 60950; Double Insulation; RCM; CB 60601-1; S-Mark IEC/EN 60601-1; EAC; CCC; LPS 60950; South Africa;		
	Model No. GTM96600-4520-T2		
	Part No./Ordering No. TR9KZ2250EI212MEDRB		Rev B

REVISION HISTORY				
REV	DESCRIPTION	SUB	DATE	APPROVED
B	Correct the output to 20V/2.25A, change model to GTM96600-4520-T2	gyang	09/25/2018	QA
A	Initial Release	gyang	09/20/2018	QA

POWER SUPPLY INFORMATION	
TYPE	Desktop/External
TECHNOLOGY	Regulated Switchmode AC-DC Power Supply AC Adaptor
CASE COLOR	GlobTek Black
NAMEPLATE RATED INPUT	100-240V~, 50-60Hz, 1.5A
INPUT CONFIG	IEC 60320/C8
WATTS	45.00
VOLTS OUT	20.0
CURRENT OUT (Amps)	2.25
BLADE/CORD INCLUDED	None (Order Separately)
BLADE/CORD INSTALLED	None :(Order Separately)
INGRESS PROTECTION	IP41
GROUNDING CONFIGURATION	(F1) Class II / Double Insulated
EFFICIENCY LEVEL	USA DOE Level VI / Eco-design Directive 2009/125/EC, (EU) 2019/1782
OUTPUT CONFIGURATION	1200 mm, 20/1C + Shield Cond, UL 1185, Female Barrel 4.0*1.7*12mm or Equal, Ferrite: Core: RH 14.2*28.5*10, GlobTek Black, GT Cord # C26418
OVERMOLDED	Yes
OUTPUT CONNECTOR GENDER	Female
CONNECTOR PIN OUT	Center Positive (+V), symbol compliant with IEC 60417 symbol no. 5926
LABEL SPECS	Standard GT,L-1186
SPECIAL BARCODE LABEL MATERIAL	No
PACK SPEC	Standard DT, Cellular packaging, User manual
USER MANUAL	809-DESKTOPUSERMANUAL on A4 paper

GlobTek, Inc. www.globtek.com 186 Veterans Drive, Northvale, NJ 07647 Tel. (201) 784-1000 Fax (201) 784-0111	Drawing Title: GTM96600-4520-T2, ICT / ITE / Medical Power Supply/Class 2/Household Power Supply, Efficiency Level: USA DOE Level VI / Eco-design Directive 2009/125/EC, (EU) 2019/1782, Case Color/Style: GlobTek Black, Desktop/External, Regulated Switchmode AC-DC Power Supply AC Adaptor, Input Rating: 100-240V~, 50-60Hz, IEC 60320/C8 , Output Rating: 45W, 20.0V@2.25A, Output Configuration: 1200 mm, 20/1C + Shield Cond, UL 1185, Female Barrel 4.0*1.7*12mm or Equal, Ferrite: Core: RH 14.2*28.5*10, GlobTek Black, GT Cord # C26418, Pin Out: Center Positive (+V), symbol compliant with IEC 60417 symbol no. 5926, Blades/Input Cord: (Order Separately), Approvals: Korea (41V-54V Only); CB 60335; Fuse 60335; ETL; EAC; cETLus 60601-1; CB 62368; India BIS; UKCA; UL 1310; Conforms to 62368-1; CB 61158; FCC; IP41; Morocco; Korea (9-15V Only); ETL 62368; Korea (16,18,19 and 20V only); Malaysia; IRAM; Korea (19V Only); PSE; PSE; PSE; China RoHS; Level VI; RoHS; Ukraine; VCCI; WEEE; ETL; CE; CB 60950; ETL 60950; S-Mark 60950; Double Insulation; RCM; CB 60601-1; S-Mark IEC/EN 60601-1; EAC; CCC; LPS 60950; South Africa;	
	Model No. GTM96600-4520-T2	
	Part No./Ordering No. TR9KZ2250EI212MEDRB	Rev B

Notes/Modifications/Customizations (notes in this section supersede the values shown in the standard spec)

DIMENSIONS ARE IN MM UNLESS SPECIFIED OTHERWISE

Use #20 per customer requirement, can not match GlobTek EL VI requirement on DC wire <For 12V-23.9VV #16 (OD: 3.8mm) and 1200mm >

GlobTek, Inc. www.globtek.com 186 Veterans Drive, Northvale, NJ 07647 Tel. (201) 784-1000 Fax (201) 784-0111	Drawing Title: GTM96600-4520-T2, ICT / ITE / Medical Power Supply/Class 2/Household Power Supply, Efficiency Level: USA DOE Level VI / Eco-design Directive 2009/125/EC, (EU) 2019/1782, Case Color/Style: GlobTek Black, Desktop/External, Regulated Switchmode AC-DC Power Supply AC Adaptor, Input Rating: 100-240V~, 50-60Hz, IEC 60320/C8 , Output Rating: 45W, 20.0V@2.25A, Output Configuration: 1200 mm, 20/1C + Shield Cond, UL 1185, Female Barrel 4.0*1.7*12mm or Equal, Ferrite: Core: RH 14.2*28.5*10, GlobTek Black, GT Cord # C26418, Pin Out: Center Positive (+V), symbol compliant with IEC 60417 symbol no. 5926, Blades/Input Cord: (Order Separately), Approvals: Korea (41V-54V Only); CB 60335; Fuse 60335; ETL; EAC; cETLus 60601-1; CB 62368; India BIS; UKCA; UL 1310; Conforms to 62368-1; CB 61158; FCC; IP41; Morocco; Korea (9-15V Only); ETL 62368; Korea (16,18,19 and 20V only); Malaysia; IRAM; Korea (19V Only); PSE; PSE; PSE; China RoHS; Level VI; RoHS; Ukraine; VCCI; WEEE; ETL; CE; CB 60950; ETL 60950; S-Mark 60950; Double Insulation; RCM; CB 60601-1; S-Mark IEC/EN 60601-1; EAC; CCC; LPS 60950; South Africa;	
	Model No. GTM96600-4520-T2	
	Part No./Ordering No. TR9KZ2250EI212MEDRB	Rev B

ELECTRICAL SPECIFICATIONS

Input

Input Voltage:	Specified: 90-264VAC, Nameplate: 100-240VAC 100% rated load current for 90-264VAC 85% rated load current for 85-264VAC 100% rated load current for 110-370VDC
Input Frequency:	Specified: 47-63Hz, Nameplate: 50-60Hz
No Load Input Power:	<75mW @ 230VAC (EU CoC Tier 2 compliant) for ≤ 49W rating <150mW @ 230VAC (EU CoC Tier 2 compliant) for > 49W rating
Inrush Current:	30A/60A max. (cold start @ 115V/230VAC)
Efficiency:	DoE Level VI and EU CoC Tier 2 compliant

Output

Turn-on Delay:	1 second max. @ 115VAC and full load
Output Regulation:	± 5% (measured at output connector)
Line Regulation:	± 0.5% typ. (measured at output connector)
Ripple:	1% or 100mV, whichever is greater (using a 47µF low-ESR cap + 0.1µF ceramic capacitor, measured @ 20MHz BW, at output connector)
Transient Response:	5% max. deviation, 1ms typ. recovery time (with 40% to 70% load step)
Hold-up Time:	8ms typ. (nominal input voltage and full load)
Power Indicator:	Green LED

Protections

Input Protection:	MOV transient suppressor, input line fusing
Over-Current Protection:	110 - 160% of rated output current, auto-restart, current limit range determined by normal output power rating, not de-rated power rating
Short-Circuit Protection:	Auto-restart
Over-Voltage Protection:	110 - 130%, latched off, cycle AC to reset
Over-Temperature Protection:	On-chip temperature sensor (integrated in primary-side switching controller), shut down at Tj = ~140°C, latched off, cycle AC to reset

GlobTek, Inc. www.globtek.com 186 Veterans Drive, Northvale, NJ 07647 Tel. (201) 784-1000 Fax (201) 784-0111	Drawing Title: GTM96600-4520-T2, ICT / ITE / Medical Power Supply/Class 2/Household Power Supply, Efficiency Level: USA DOE Level VI / Eco-design Directive 2009/125/EC, (EU) 2019/1782, Case Color/Style: GlobTek Black, Desktop/External, Regulated Switchmode AC-DC Power Supply AC Adaptor, Input Rating: 100-240V~, 50-60Hz, IEC 60320/C8 , Output Rating: 45W, 20.0V@2.25A, Output Configuration: 1200 mm, 20/1C + Shield Cond, UL 1185, Female Barrel 4.0*1.7*12mm or Equal, Ferrite: Core: RH 14.2*28.5*10, GlobTek Black, GT Cord # C26418, Pin Out: Center Positive (+V), symbol compliant with IEC 60417 symbol no. 5926, Blades/Input Cord: (Order Separately), Approvals: Korea (41V-54V Only); CB 60335; Fuse 60335; ETL; EAC; cETLus 60601-1; CB 62368; India BIS; UKCA; UL 1310; Conforms to 62368-1; CB 61158; FCC; IP41; Morocco; Korea (9-15V Only); ETL 62368; Korea (16,18,19 and 20V only); Malaysia; IRAM; Korea (19V Only); PSE; PSE; PSE; China RoHS; Level VI; RoHS; Ukraine; VCCI; WEEE; ETL; CE; CB 60950; ETL 60950; S-Mark 60950; Double Insulation; RCM; CB 60601-1; S-Mark IEC/EN 60601-1; EAC; CCC; LPS 60950; South Africa;	
	Model No. GTM96600-4520-T2	
	Part No./Ordering No. TR9KZ2250EI212MEDRB	Rev B

Environmental

MTBF:	1,500,000 hours @ 25°C ambient, full load (Telcordia SR-332, Issue 3)
Operating Temperature:	-20°C to 40°C (full load)
Storage Temperature:	-30°C to 80°C
Humidity:	0% to 95% relative humidity, non-condensing
Altitude:	5000m
Cooling:	Convection
RoHS:	Complies with EU 2011/65/EU and China SJ/T 11363-2006
Note 1:	Regarding operating temperature a. See below de-rating table for output power capability at alternate temperature b. Extended low-end temperature range available as a custom option

Safety

Dielectric Withstand Voltage:	4000VAC or 5656VDC from input to output 3000VAC or 4242VDC from input to earth (Class I models only)
Touch Current:	Class I: 20µA max. Class II: 85µA max. Class II F2: 20µA max.
Earth Leakage Current	Class I: 300µA max. Class II: N/A
Means of Protection:	2 x MOPP
Output Isolation Options:	Class I: C6 or C14 inlet (output negative tied to Earth contact) Class II: C8 or C18 inlet Class II FE: C6 or C14 inlet (output isolated from Earth contact) Review isolation options by reading our white paper PSU Isolation and Identity .
Earth Continuity Test:	< 0.1Ω between earth pin (on AC inlet) and PCB termination point (Class I models only)
Compliant Standards:	See listing at end of this datasheet for specific standards

PROPRIETARY INFORMATION

PROPRIETARY OF GLOBTEK, INC. ANY REPRODUCTION, DISCLOSURE OR USE OF THIS DRAWING, IN WHOLE OR IN PART, IS HEREBY PROHIBITED EXCEPT AS SPECIFIED IN WRITING BY GLOBTEK, INC. © GlobTek, Inc. 2018 - 2023
quest / 09/28/2023 7:48:02 PM GMT CLONED FROM TR9KZ3160LLPCIMR6B

GloTek, Inc. www.globtek.com 186 Veterans Drive, Northvale, NJ 07647 Tel. (201) 784-1000 Fax (201) 784-0111	Drawing Title: GTM96600-4520-T2, ICT / ITE / Medical Power Supply/Class 2/Household Power Supply, Efficiency Level: USA DOE Level VI / Eco-design Directive 2009/125/EC, (EU) 2019/1782, Case Color/Style: GlobTek Black, Desktop/External, Regulated Switchmode AC-DC Power Supply AC Adaptor, Input Rating: 100-240V~, 50-60Hz, IEC 60320/C8 , Output Rating: 45W, 20.0V@2.25A, Output Configuration: 1200 mm, 20/1C + Shield Cond, UL 1185, Female Barrel 4.0*1.7*12mm or Equal, Ferrite: Core: RH 14.2*28.5*10, GlobTek Black, GT Cord # C26418, Pin Out: Center Positive (+V), symbol compliant with IEC 60417 symbol no. 5926, Blades/Input Cord: (Order Separately), Approvals: Korea (41V-54V Only); CB 60335; Fuse 60335; ETL; EAC; cETLus 60601-1; CB 62368; India BIS; UKCA; UL 1310; Conforms to 62368-1; CB 61158; FCC; IP41; Morocco; Korea (9-15V Only); ETL 62368; Korea (16,18,19 and 20V only); Malaysia; IRAM; Korea (19V Only); PSE; PSE; PSE; China RoHS; Level VI; RoHS; Ukraine; VCCI; WEEE; ETL; CE; CB 60950; ETL 60950; S-Mark 60950; Double Insulation; RCM; CB 60601-1; S-Mark IEC/EN 60601-1; EAC; CCC; LPS 60950; South Africa;	
	Model No. GTM96600-4520-T2	
	Part No./Ordering No. TR9KZ2250EI212MEDRB	Rev B

EMC

Applicable Standards:	Medical: EN60601-1-2, 4th edition Emissions: EN55032, EN61000-6-3, EN61000-6-4, CISPR11, CISPR22 Immunity: EN55024, EN61000-6-1, EN61000-6-2
Conducted Emissions:	Class B, FCC Part 15, Class B (with resistive load)
Radiated Emissions:	Class B, FCC Part 15, Class B (with resistive load)
Harmonic Current Voltage Distortion:	EN61000-3-2, Class A
Voltage Fluctuations/Flicker:	EN61000-3-3
Electrostatic Discharge (ESD) Immunity:	EN61000-4-2, 10KV contact discharge, 20KV air discharge
Radiated RF Immunity:	EN61000-4-3, 10V/m 80-1000MHz, 3V/m 1-2.7GHz, 80% 1KHz AM
EFT/Burst Immunity:	EN61000-4-4, 4KV/100kHz.
Line Surge Immunity:	EN61000-4-5, 2KV differential, 4KV common-mode
Conducted RF Immunity:	EN61000-4-6, 3VRMS, 80% 1KHz AM
Power Frequency Magnetic Field Immunity:	EN61000-4-8, 3A/m
Voltage Dip Immunity:	EN61000-4-11

Enclosure

Housing:	High impact plastic, 94V0 polycarbonate, non-vented
AC Input Mechanical Options:	Desktop: C6, C7, C14, or C18 inlet Hybrid: Desktop inlet or changeable blades for wall-plug-in style, Class I or Class II input
Markings:	Label and/or pad printed and/or laser-etched into case

Special Options

1. Removal of LED (cost reduction or aesthetic purpose)
2. Custom cordsets, various cordage types, and connector types
3. Custom markings
4. Short term output surge capability for motors or other high peak current loads. (Available up to 120W for 1 second at nameplate voltage range. Higher levels possible for limited input voltage range, or larger allowed voltage dip.)
5. Reduced leakage current
6. Tightened output voltage tolerance
7. Reduced output ripple level
8. Reduced output power rating
9. High reliability PCB laminate with plated through-holes for IPC610 Class 2 compliance
10. Low temperature option, down to -40°C
11. Special housing and cordset colors
12. "Back EMF" upgrade, for motor loads and other high inductance applications with reverse energy flow requirements
13. Improved ingress protection (IP) rating

PROPRIETARY INFORMATION

PROPRIETARY OF GLOBTEK, INC. ANY REPRODUCTION, DISCLOSURE OR USE OF THIS DRAWING, IN WHOLE OR IN PART, IS HEREBY PROHIBITED EXCEPT AS SPECIFIED IN

WRITING BY GLOBTEK, INC. © GlobTek, Inc. 2018 - 2023

quest / 09/28/2023 7:48:02 PM GMT CLONED FROM TR9KZ3160LLPCIMR6B

GlobTek, Inc. www.globtek.com 186 Veterans Drive, Northvale, NJ 07647 Tel. (201) 784-1000 Fax (201) 784-0111	Drawing Title: GTM96600-4520-T2, ICT / ITE / Medical Power Supply/Class 2/Household Power Supply, Efficiency Level: USA DOE Level VI / Eco-design Directive 2009/125/EC, (EU) 2019/1782, Case Color/Style: GlobTek Black, Desktop/External, Regulated Switchmode AC-DC Power Supply AC Adaptor, Input Rating: 100-240V~, 50-60Hz, IEC 60320/C8 , Output Rating: 45W, 20.0V@2.25A, Output Configuration: 1200 mm, 20/1C + Shield Cond, UL 1185, Female Barrel 4.0*1.7*12mm or Equal, Ferrite: Core: RH 14.2*28.5*10, GlobTek Black, GT Cord # C26418, Pin Out: Center Positive (+V), symbol compliant with IEC 60417 symbol no. 5926, Blades/Input Cord: (Order Separately), Approvals: Korea (41V-54V Only); CB 60335; Fuse 60335; ETL; EAC; cETLus 60601-1; CB 62368; India BIS; UKCA; UL 1310; Conforms to 62368-1; CB 61158; FCC; IP41; Morocco; Korea (9-15V Only); ETL 62368; Korea (16,18,19 and 20V only); Malaysia; IRAM; Korea (19V Only); PSE; PSE; PSE; China RoHS; Level VI; RoHS; Ukraine; VCCI; WEEE; ETL; CE; CB 60950; ETL 60950; S-Mark 60950; Double Insulation; RCM; CB 60601-1; S-Mark IEC/EN 60601-1; EAC; CCC; LPS 60950; South Africa;	
	Model No. GTM96600-4520-T2	
	Part No./Ordering No. TR9KZ2250EI212MEDRB	Rev B

Output Connectors

- Several output connector options are available with various output current ratings. GlobTek can supply 10A rated 2.1mm and 2.5mm style DC Power Jacks, to complement our 10A output rated 2.1mm and 2.5mm DC power plugs used on our output cordsets.
- Please visit our real-time listing of mating connector product offering:
<https://en.globtek.com/news/high-current-coaxial-barrel-plug-jacks-for-high-wattage-power-supplies>

TO ADDRESS SYSTEM-LEVEL EMI CONCERNS, FERRITE CHOKES/BEADS MAY BE ADDED/REVISED UPON REQUEST. A SAMPLE KIT OF GLOBTEK’S STANDARD FERRITES IS AVAILABLE UNDER GLOBTEK P/N: EMI-MITIGATION-KIT1

FOR ADDITIONAL INFORMATION, PLEASE READ OUR WHITE PAPER AT: <https://r.globtek.info/3QeaqtD>

INGRESS PROTECTION: IP41

GlobTek, Inc.
www.globtek.com
186 Veterans Drive,
Northvale, NJ 07647
Tel. (201) 784-1000
Fax (201) 784-0111

Drawing Title: GTM96600-4520-T2, ICT / ITE / Medical Power Supply/Class 2/Household Power Supply, Efficiency Level: USA DOE Level VI / Eco-design Directive 2009/125/EC, (EU) 2019/1782, Case Color/Style: GlobTek Black, Desktop/External, Regulated Switchmode AC-DC Power Supply AC Adaptor, Input Rating: 100-240V~, 50-60Hz, IEC 60320/C8 , Output Rating: 45W, 20.0V@2.25A, Output Configuration: 1200 mm, 20/1C + Shield Cond, UL 1185, Female Barrel 4.0*1.7*12mm or Equal, Ferrite: Core: RH 14.2*28.5*10, GlobTek Black, GT Cord # C26418, Pin Out: Center Positive (+V), symbol compliant with IEC 60417 symbol no. 5926, Blades/Input Cord: (Order Separately), Approvals: Korea (41V-54V Only); CB 60335; Fuse 60335; ETL; EAC; cETLus 60601-1; CB 62368; India BIS; UKCA; UL 1310; Conforms to 62368-1; CB 61158; FCC; IP41; Morocco; Korea (9-15V Only); ETL 62368; Korea (16,18,19 and 20V only); Malaysia; IRAM; Korea (19V Only); PSE; PSE; PSE; China RoHS; Level VI; RoHS; Ukraine; VCCI; WEEE; ETL; CE; CB 60950; ETL 60950; S-Mark 60950; Double Insulation; RCM; CB 60601-1; S-Mark IEC/EN 60601-1; EAC; CCC; LPS 60950; South Africa;

Model No. GTM96600-4520-T2

Part No./Ordering No. TR9KZ2250EI212MEDRB

Rev B

3D File Download <https://www.globtek.com/dl/GTM96600-T2.igs>

Mechanical drawing

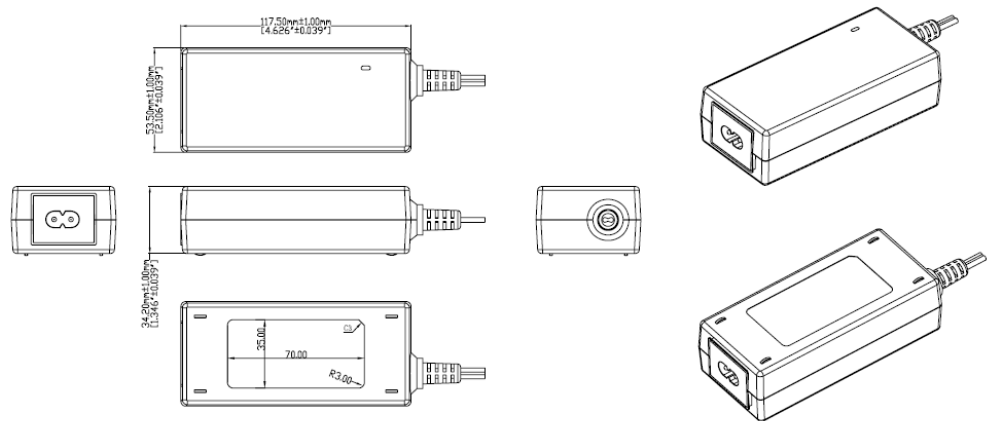

GlobTek, Inc.
www.globtek.com
186 Veterans Drive,
Northvale, NJ 07647
Tel. (201) 784-1000
Fax (201) 784-0111

Drawing Title: GTM96600-4520-T2, ICT / ITE / Medical Power Supply/Class 2/Household Power Supply, Efficiency Level: USA DOE Level VI / Eco-design Directive 2009/125/EC, (EU) 2019/1782, Case Color/Style: GlobTek Black, Desktop/External, Regulated Switchmode AC-DC Power Supply AC Adaptor, Input Rating: 100-240V~, 50-60Hz, IEC 60320/C8 , Output Rating: 45W, 20.0V@2.25A, Output Configuration: 1200 mm, 20/1C + Shield Cond, UL 1185, Female Barrel 4.0*1.7*12mm or Equal, Ferrite: Core: RH 14.2*28.5*10, GlobTek Black, GT Cord # C26418, Pin Out: Center Positive (+V), symbol compliant with IEC 60417 symbol no. 5926, Blades/Input Cord: (Order Separately), Approvals: Korea (41V-54V Only); CB 60335; Fuse 60335; ETL; EAC; cETLus 60601-1; CB 62368; India BIS; UKCA; UL 1310; Conforms to 62368-1; CB 61158; FCC; IP41; Morocco; Korea (9-15V Only); ETL 62368; Korea (16,18,19 and 20V only); Malaysia; IRAM; Korea (19V Only); PSE; PSE; PSE; China RoHS; Level VI; RoHS; Ukraine; VCCI; WEEE; ETL; CE; CB 60950; ETL 60950; S-Mark 60950; Double Insulation; RCM; CB 60601-1; S-Mark IEC/EN 60601-1; EAC; CCC; LPS 60950; South Africa;

Model No. GTM96600-4520-T2

Part No./Ordering No. TR9KZ2250EI212MEDRB

Rev B

DERATING CURVE



GloTek, Inc. www.globtek.com 186 Veterans Drive, Northvale, NJ 07647 Tel. (201) 784-1000 Fax (201) 784-0111	Drawing Title: GTM96600-4520-T2, ICT / ITE / Medical Power Supply/Class 2/Household Power Supply, Efficiency Level: USA DOE Level VI / Eco-design Directive 2009/125/EC, (EU) 2019/1782, Case Color/Style: GlobTek Black, Desktop/External, Regulated Switchmode AC-DC Power Supply AC Adaptor, Input Rating: 100-240V~, 50-60Hz, IEC 60320/C8 , Output Rating: 45W, 20.0V@2.25A, Output Configuration: 1200 mm, 20/1C + Shield Cond, UL 1185, Female Barrel 4.0*1.7*12mm or Equal, Ferrite: Core: RH 14.2*28.5*10, GlobTek Black, GT Cord # C26418, Pin Out: Center Positive (+V), symbol compliant with IEC 60417 symbol no. 5926, Blades/Input Cord: (Order Separately), Approvals: Korea (41V-54V Only); CB 60335; Fuse 60335; ETL; EAC; cETLus 60601-1; CB 62368; India BIS; UKCA; UL 1310; Conforms to 62368-1; CB 61158; FCC; IP41; Morocco; Korea (9-15V Only); ETL 62368; Korea (16,18,19 and 20V only); Malaysia; IRAM; Korea (19V Only); PSE; PSE; PSE; China RoHS; Level VI; RoHS; Ukraine; VCCI; WEEE; ETL; CE; CB 60950; ETL 60950; S-Mark 60950; Double Insulation; RCM; CB 60601-1; S-Mark IEC/EN 60601-1; EAC; CCC; LPS 60950; South Africa;	
	Model No. GTM96600-4520-T2	
	Part No./Ordering No. TR9KZ2250EI212MEDRB	Rev B

INPUT CONFIGURATION

(F1) Class II / Double Insulated

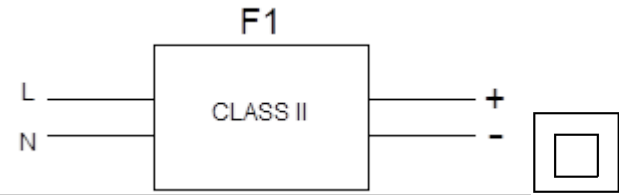

[Alternate grounding configurations](#) available upon request.

Blades/Cord Included:None:(Order Separately)

Blades/Cord Installed:None:(Order Separately)

IEC 60320/C8 AC Inlet connector, Class II, Non-Earth Ground (aka "Figure-8")

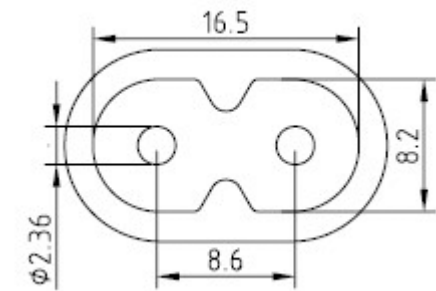

Mates with IEC 60320/C7 Plug

Below are standard cordsets which are "not included" (unless stated above); these may be purchased separately or packaged with the power supply. Please contact your Sales Engineer if the style required is not shown below. Many more available in different lengths, colors or cable material.

[Standard International IEC 320/C7 Cordsets](#)

GlobTek, Inc. www.globtek.com 186 Veterans Drive, Northvale, NJ 07647 Tel. (201) 784-1000 Fax (201) 784-0111	Drawing Title: GTM96600-4520-T2, ICT / ITE / Medical Power Supply/Class 2/Household Power Supply, Efficiency Level: USA DOE Level VI / Eco-design Directive 2009/125/EC, (EU) 2019/1782, Case Color/Style: GlobTek Black, Desktop/External, Regulated Switchmode AC-DC Power Supply AC Adaptor, Input Rating: 100-240V~, 50-60Hz, IEC 60320/C8 , Output Rating: 45W, 20.0V@2.25A, Output Configuration: 1200 mm, 20/1C + Shield Cond, UL 1185, Female Barrel 4.0*1.7*12mm or Equal, Ferrite: Core: RH 14.2*28.5*10, GlobTek Black, GT Cord # C26418, Pin Out: Center Positive (+V), symbol compliant with IEC 60417 symbol no. 5926, Blades/Input Cord: (Order Separately), Approvals: Korea (41V-54V Only); CB 60335; Fuse 60335; ETL; EAC; cETLus 60601-1; CB 62368; India BIS; UKCA; UL 1310; Conforms to 62368-1; CB 61158; FCC; IP41; Morocco; Korea (9-15V Only); ETL 62368; Korea (16,18,19 and 20V only); Malaysia; IRAM; Korea (19V Only); PSE; PSE; PSE; China RoHS; Level VI; RoHS; Ukraine; VCCI; WEEE; ETL; CE; CB 60950; ETL 60950; S-Mark 60950; Double Insulation; RCM; CB 60601-1; S-Mark IEC/EN 60601-1; EAC; CCC; LPS 60950; South Africa;		
	Model No. GTM96600-4520-T2		
	Part No./Ordering No. TR9KZ2250EI212MEDRB		Rev B

Part Number	Type	Standard	Connector	Length (mm)	Length (feet)
2094112M703(R)	Argentina (Type I)	IRAM 2063	IEC 320/C7	2000	7
5014112M703A(R)	Australian (Type I)	AS 3112	IEC 320/C7	2000	7
207B4111M8703(R)	Brazil (Type N)	NBR14136	IEC 320/C7	1800	6
4533501M8703(R)	China (Type A)	GB 2099.1	IEC 320/C7	1830	6
2074112M703A(R)	European (Type C)	CEE 7/16	IEC 320/C7	2000	7
2074112M703AEUSA(R)	European/South Africa Combo(Type C)	CEE 7/16	IEC 320/C7	2000	7
2084111M8703B(R)	India (Type D)	IS 1293	IEC 320/C7	1800	6
451J3401M8703(R)	Japan (Type A)	JIS 8303	IEC 320/C7	1830	6
2044112M703A(R)	Korea (Type C)	KS C8305	IEC 320/C7	2000	7
4511116F703A(R)	North America (Type A)	NEMA 1-15P	IEC 320/C7	1830	6
2084111M8703(R)	South Africa (Type M)	BS 546	IEC320/C7	1830	6
4033401M8703A(R)	Taiwan (Type A)	CNS690	IEC 320/C7	1830	6
6104112M703A(R)	UK, Hong Kong, Singapore, Gulf States (Type G)	BS1363	IEC 320/C7	2000	7
451G1116F703A(R)	Gulf States (Kuwait, Bahrain, Oman, Qatar, Saudi Arabia, Yemen and the United Arab Emirates (UAE)(Type A)	Nema 1-15P	IEC320/C7	1830	6
6303742M5703(R)	Thailand (Type C)	TIS 166-2549	IEC320/C7	2500	8

PROPRIETARY INFORMATION

GlobTek, Inc. www.globtek.com 186 Veterans Drive, Northvale, NJ 07647 Tel. (201) 784-1000 Fax (201) 784-0111	Drawing Title: GTM96600-4520-T2, ICT / ITE / Medical Power Supply/Class 2/Household Power Supply, Efficiency Level: USA DOE Level VI / Eco-design Directive 2009/125/EC, (EU) 2019/1782, Case Color/Style: GlobTek Black, Desktop/External, Regulated Switchmode AC-DC Power Supply AC Adaptor, Input Rating: 100-240V~, 50-60Hz, IEC 60320/C8, Output Rating: 45W, 20.0V@2.25A, Output Configuration: 1200 mm, 20/1C + Shield Cond, UL 1185, Female Barrel 4.0*1.7*12mm or Equal, Ferrite: Core: RH 14.2*28.5*10, GlobTek Black, GT Cord # C26418, Pin Out: Center Positive (+V), symbol compliant with IEC 60417 symbol no. 5926, Blades/Input Cord: (Order Separately), Approvals: Korea (41V-54V Only); CB 60335; Fuse 60335; ETL; EAC; cETLus 60601-1; CB 62368; India BIS; UKCA; UL 1310; Conforms to 62368-1; CB 61158; FCC; IP41; Morocco; Korea (9-15V Only); ETL 62368; Korea (16,18,19 and 20V only); Malaysia; IRAM; Korea (19V Only); PSE; PSE; PSE; China RoHS; Level VI; RoHS; Ukraine; VCCI; WEEE; ETL; CE; CB 60950; ETL 60950; S-Mark 60950; Double Insulation; RCM; CB 60601-1; S-Mark IEC/EN 60601-1; EAC; CCC; LPS 60950; South Africa;	
	Model No. GTM96600-4520-T2	
	Part No./Ordering No. TR9KZ2250EI212MEDRB	Rev B

OUTPUT CORD AND CONNECTOR: EI212/C26418

ACTUAL CONNECTORS, OVERMOLDS, FERRITES MAY VARY SLIGHTLY FROM THE PICTURE BELOW

CABLE TYPE	UL 1185
CABLE LENGTH (mm)	1200
CABLE TOLERANCE (mm)	+150 -0
WIRE GAUGE (AWG)	20
CONDUCTORS	1C + Shield
HANK DIMENSION (mm)	70 ± 10
CABLE / CONNECTOR OVERMOLD COLOR	GlobTek Black
FERRITE TYPE AND DIMENSION	Core: RH 14.2*28.5*10
FERRITE NUMBER OF TURNS(Definition)	2 Pass thru core (1 turns)
FERRITE DIMENSION FROM STRAIN RELIEF N/A	
FERRITE DIMENSION FROM PLUG	N/A
PLUG TYPE	Female Barrel 4.0*1.7*12mm or Equal
OUTPUT CONNECTOR GENDER	Female
OVERMOLDED	Yes
OVER MOLD ORIENTATION	Straight
CONNECTOR PIN OUT	Center Positive (+V), symbol compliant with IEC 60417 symbol no. 5926

ADDITIONAL REQUIREMENTS
UL1310 Warning Label Up To 36 Volts with plugs

ADDITIONAL OUTPUT PLUG OPTIONS ARE AVAILABLE AT <https://www.globtek.com/connectors/>
STANDARD PLUGS AND CONNECTORS CAN BE SEEN ONLINE AT <https://www.globtek.com/connectors/>
CALCULATE VOLTAGE REGULATION/DROP WITH OUR ONLINE CALCULATOR: <https://en.globtek.com/output-cable-regulation-calculator/>

PROPRIETARY INFORMATION

PROPRIETARY OF GLOBTEK, INC. ANY REPRODUCTION, DISCLOSURE OR USE OF THIS DRAWING, IN WHOLE OR IN PART, IS HEREBY PROHIBITED EXCEPT AS SPECIFIED IN Page 12 of 18
WRITING BY GLOBTEK, INC. © GlobTek, Inc. 2018 - 2023
quest / 09/28/2023 7:48:02 PM GMT CLONED FROM TR9KZ3160LLPCIMR6B

GlobTek, Inc. www.globtek.com 186 Veterans Drive, Northvale, NJ 07647 Tel. (201) 784-1000 Fax (201) 784-0111	Drawing Title: GTM96600-4520-T2, ICT / ITE / Medical Power Supply/Class 2/Household Power Supply, Efficiency Level: USA DOE Level VI / Eco-design Directive 2009/125/EC, (EU) 2019/1782, Case Color/Style: GlobTek Black, Desktop/External, Regulated Switchmode AC-DC Power Supply AC Adaptor, Input Rating: 100-240V~, 50-60Hz, IEC 60320/C8 , Output Rating: 45W, 20.0V@2.25A, Output Configuration: 1200 mm, 20/1C + Shield Cond, UL 1185, Female Barrel 4.0*1.7*12mm or Equal, Ferrite: Core: RH 14.2*28.5*10, GlobTek Black, GT Cord # C26418, Pin Out: Center Positive (+V), symbol compliant with IEC 60417 symbol no. 5926, Blades/Input Cord: (Order Separately), Approvals: Korea (41V-54V Only); CB 60335; Fuse 60335; ETL; EAC; cETLus 60601-1; CB 62368; India BIS; UKCA; UL 1310; Conforms to 62368-1; CB 61158; FCC; IP41; Morocco; Korea (9-15V Only); ETL 62368; Korea (16,18,19 and 20V only); Malaysia; IRAM; Korea (19V Only); PSE; PSE; PSE; China RoHS; Level VI; RoHS; Ukraine; VCCI; WEEE; ETL; CE; CB 60950; ETL 60950; S-Mark 60950; Double Insulation; RCM; CB 60601-1; S-Mark IEC/EN 60601-1; EAC; CCC; LPS 60950; South Africa;	
	Model No. GTM96600-4520-T2	
	Part No./Ordering No. TR9KZ2250EI212MEDRB	Rev B

OUTPUT CONNECTOR HOOK UP

TO ADDRESS SYSTEM-LEVEL EMI CONCERNS, FERRITE CHOKES/BEADS MAY BE ADDED/REVISED UPON REQUEST. A SAMPLE KIT OF GLOBTEK’S STANDARD FERRITES IS AVAILABLE UNDER GLOBTEK P/N: EMI-MITIGATION-KIT1

FOR ADDITIONAL INFORMATION, PLEASE READ OUR WHITE PAPER AT:
<https://en.globtek.com/technical-articles/ferrite-kit-radiated-emi-suppression-kit-for-globtek-power-supplies-cable-assemblies>

GlobTek, Inc. www.globtek.com 186 Veterans Drive, Northvale, NJ 07647 Tel. (201) 784-1000 Fax (201) 784-0111	Drawing Title: GTM96600-4520-T2, ICT / ITE / Medical Power Supply/Class 2/Household Power Supply, Efficiency Level: USA DOE Level VI / Eco-design Directive 2009/125/EC, (EU) 2019/1782, Case Color/Style: GlobTek Black, Desktop/External, Regulated Switchmode AC-DC Power Supply AC Adaptor, Input Rating: 100-240V~, 50-60Hz, IEC 60320/C8, Output Rating: 45W, 20.0V@2.25A, Output Configuration: 1200 mm, 20/1C + Shield Cond, UL 1185, Female Barrel 4.0*1.7*12mm or Equal, Ferrite: Core: RH 14.2*28.5*10, GlobTek Black, GT Cord # C26418, Pin Out: Center Positive (+V), symbol compliant with IEC 60417 symbol no. 5926, Blades/Input Cord: (Order Separately), Approvals: Korea (41V-54V Only); CB 60335; Fuse 60335; ETL; EAC; cETLus 60601-1; CB 62368; India BIS; UKCA; UL 1310; Conforms to 62368-1; CB 61158; FCC; IP41; Morocco; Korea (9-15V Only); ETL 62368; Korea (16,18,19 and 20V only); Malaysia; IRAM; Korea (19V Only); PSE; PSE; PSE; China RoHS; Level VI; RoHS; Ukraine; VCCI; WEEE; ETL; CE; CB 60950; ETL 60950; S-Mark 60950; Double Insulation; RCM; CB 60601-1; S-Mark IEC/EN 60601-1; EAC; CCC; LPS 60950; South Africa;	
	Model No. GTM96600-4520-T2	
	Part No./Ordering No. TR9KZ2250EI212MEDRB	Rev B

LABEL:L-1186

LABEL P/N	Standard GT
MATERIAL	Flat Thermal Transfer, Imprintable, Polyester Label and/or Pad Printed and/or Molded, and/or Laser Engraved in the case
BACKGROUND COLOR	Black if housing is Black, White or Silver if housing is White or Gray.
TEXT COLOR	White or Silver if label is Black Background for Black housing. Black if label is White or Silver background and Housing is White or Gray.
LABEL WIDTH (mm)	35.0
LABEL HEIGHT (mm)	70.0
SPECIAL BARCODE LABEL MATERIAL	No

Below is the minimum information which will appear on the label. NOTE: in the logo area additional/actual positioning of symbols and text is subjected to change as per agency updates/requirements or additional model approvals become available.

Regulatory certifications/label markings may be in logo area on the label or molded into the case housing outside the label area.

Information will be shown via label and/or pad printed and/or molded and/or laser engraved in the case. * Date code markings at GlobTek option

GlobTek[®], Inc.
www.globtek.com

A

B

C

D

E

**Regulatory Certifications/
Label Markings**
(see below)

MADE IN XXX XX制造

DATE CODE

↑
XXX = USA or CHINA

DATE CODE A *:

DATE CODE LABEL



Series NO.
Class NO. for production

or

DATE CODE B *:

WWYY
WW = WEEK
YY = YEAR

A=ICT / ITE / Medical Power Supply/Class 2/Household Power Supply

B=P/N: (料号) TR9KZ2250EI212MEDRB

C=Model (型号) GTM96600-4520-T2

D=Input (输入)100-240V~, 50-60Hz, 1.5A

E=Output (输出)20.0 V 2.25 A, 45.00W

PROPRIETARY INFORMATION

PROPRIETARY OF GLOBTEK, INC. ANY REPRODUCTION, DISCLOSURE OR USE OF THIS DRAWING, IN WHOLE OR IN PART, IS HEREBY PROHIBITED EXCEPT AS SPECIFIED IN Page 14 of 18

WRITING BY GLOBTEK, INC. © GlobTek, Inc. 2018 - 2023

quest / 09/28/2023 7:48:02 PM GMT CLONED FROM TR9KZ3160LLPCIMR6B

GloTek, Inc. www.globtek.com 186 Veterans Drive, Northvale, NJ 07647 Tel. (201) 784-1000 Fax (201) 784-0111	Drawing Title: GTM96600-4520-T2, ICT / ITE / Medical Power Supply/Class 2/Household Power Supply, Efficiency Level: USA DOE Level VI / Eco-design Directive 2009/125/EC, (EU) 2019/1782, Case Color/Style: GlobTek Black, Desktop/External, Regulated Switchmode AC-DC Power Supply AC Adaptor, Input Rating: 100-240V~, 50-60Hz, IEC 60320/C8 , Output Rating: 45W, 20.0V@2.25A, Output Configuration: 1200 mm, 20/1C + Shield Cond, UL 1185, Female Barrel 4.0*1.7*12mm or Equal, Ferrite: Core: RH 14.2*28.5*10, GlobTek Black, GT Cord # C26418, Pin Out: Center Positive (+V), symbol compliant with IEC 60417 symbol no. 5926, Blades/Input Cord: (Order Separately), Approvals: Korea (41V-54V Only); CB 60335; Fuse 60335; ETL; EAC; cETLus 60601-1; CB 62368; India BIS; UKCA; UL 1310; Conforms to 62368-1; CB 61158; FCC; IP41; Morocco; Korea (9-15V Only); ETL 62368; Korea (16,18,19 and 20V only); Malaysia; IRAM; Korea (19V Only); PSE; PSE; PSE; China RoHS; Level VI; RoHS; Ukraine; VCCI; WEEE; ETL; CE; CB 60950; ETL 60950; S-Mark 60950; Double Insulation; RCM; CB 60601-1; S-Mark IEC/EN 60601-1; EAC; CCC; LPS 60950; South Africa;	
	Model No. GTM96600-4520-T2	
	Part No./Ordering No. TR9KZ2250EI212MEDRB	Rev B

AGENCY ONLINE DOCUMENTS	http://www.globtek.info/certs/GTM96600-TZ/
CE EC-Declaration for Medical	http://globtek.force.com/models/ec_declaration_product?id=01t0c000008phBF&m=1
CE EC-Declaration for Industrial/Commercial/ITE	http://globtek.force.com/models/ec_declaration_product?id=01t0c000008phBF&i=2
CE EC-Declaration for Household	http://globtek.force.com/models/ec_declaration_product?id=01t0c000008phBF&h=2
UKCA-Declaration for Medical	http://globtek.force.com/models/ukca_declaration_product?id=01t0c000008phBF&m=1
UKCA-Declaration for Industrial/Commercial/ITE	http://globtek.force.com/models/ukca_declaration_product?id=01t0c000008phBF&i=2
UKCA-Declaration for Household	http://globtek.force.com/models/ukca_declaration_product?id=01t0c000008phBF&h=2
Morocco SDoC Declaration	https://globtek.secure.force.com/models/Morocco_SDoC_Declaration?id=a0Oa000000FjZOaEAN
RoHS/RoHS3 Declaration	https://www.globtek.com/pdf/rohs_cert/01t0c000008phBFAAY
REACH Declaration	https://www.globtek.com/pdf/iso_certificates/REACH.pdf
Conflict Minerals Declaration	https://www.globtek.com/pdf/conflict-minerals.pdf
Prop 65 Statement	https://en.globtek.com/prop-65-statement.pdf

IPXY rating is based on 3rd party testing and customers should check suitability and test system level IPXY rating before ordering.

Regulatory Certifications/Label Markings

Below follows a link to the latest regulatory certifications and marks for this specific product. National standards as well as certification schemes are constantly changing and so is the set of certification marks and symbols applicable to this product. Various standards, marks and symbols, and certificates are subject to change at any time without notice.

Additional standards or unique country certifications are available upon request. Please contact Globtek to request a quotation.

LATEST PRODUCT/MODEL CERTIFICATIONS: <https://www.globtek.com/datasheet/w70819>

AGENCY ONLINE DOCUMENTS <http://www.globtek.info/certs/GTM96600-TZ/>



(F1) Class II / Double Insulated

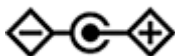

Center Positive (+V), symbol compliant with IEC 60417 symbol no. 5926

GlobTek, Inc. www.globtek.com 186 Veterans Drive, Northvale, NJ 07647 Tel. (201) 784-1000 Fax (201) 784-0111	Drawing Title: GTM96600-4520-T2, ICT / ITE / Medical Power Supply/Class 2/Household Power Supply, Efficiency Level: USA DOE Level VI / Eco-design Directive 2009/125/EC, (EU) 2019/1782, Case Color/Style: GlobTek Black, Desktop/External, Regulated Switchmode AC-DC Power Supply AC Adaptor, Input Rating: 100-240V~, 50-60Hz, IEC 60320/C8 , Output Rating: 45W, 20.0V@2.25A, Output Configuration: 1200 mm, 20/1C + Shield Cond, UL 1185, Female Barrel 4.0*1.7*12mm or Equal, Ferrite: Core: RH 14.2*28.5*10, GlobTek Black, GT Cord # C26418, Pin Out: Center Positive (+V), symbol compliant with IEC 60417 symbol no. 5926, Blades/Input Cord: (Order Separately), Approvals: Korea (41V-54V Only); CB 60335; Fuse 60335; ETL; EAC; cETLus 60601-1; CB 62368; India BIS; UKCA; UL 1310; Conforms to 62368-1; CB 61158; FCC; IP41; Morocco; Korea (9-15V Only); ETL 62368; Korea (16,18,19 and 20V only); Malaysia; IRAM; Korea (19V Only); PSE; PSE; PSE; China RoHS; Level VI; RoHS; Ukraine; VCCI; WEEE; ETL; CE; CB 60950; ETL 60950; S-Mark 60950; Double Insulation; RCM; CB 60601-1; S-Mark IEC/EN 60601-1; EAC; CCC; LPS 60950; South Africa;	
	Model No. GTM96600-4520-T2	
	Part No./Ordering No. TR9KZ2250EI212MEDRB	Rev B

PACKAGING

Packing Spec P/N	Standard DT, Cellular packaging, User manual
Box Qty	20
Gift Box Size (mm)	Egg Crate
Gift Box Color	None
Master Carton Size (mm)	158 x 427 x 405
Master Carton Cubic Volume (m³)	0.03
Master GW (Kg)	10.0 kg
BLADES INCLUDED	None: (Order Separately)
BLADE/CORD INSTALLED	None: (Order Separately)
USER MANUAL*	809-DESKTOPUSERMANUAL on A4 paper
USER MANUAL WEB LINK	https://en.globtek.com/pdf/809-DESKTOPUSERMANUAL.jpg

* This specification sheet is considered the user manual for all applications. It is expected that the buyer of this product will use it to formulate their own user manual for their end product and a user manual specifically for the power adapter is not usually required. If a user manual is not specifically listed above then none will be provided with this unit.

If specific packaging is required, this section must specify all requirements and note "no exceptions". If this section does not specify packaging, it is subject to change without notice at GlobTek's discretion.

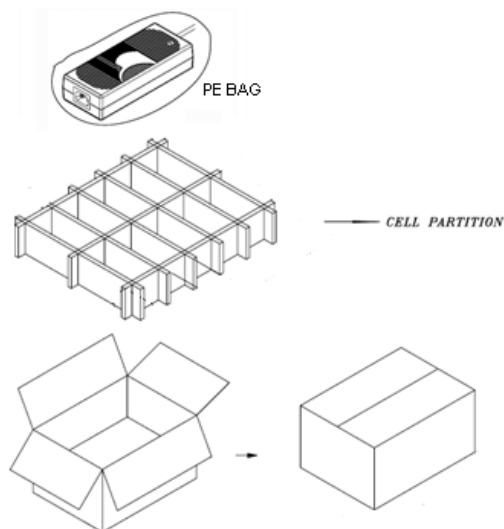

PROPRIETARY INFORMATION

PROPRIETARY OF GLOBTEK, INC. ANY REPRODUCTION, DISCLOSURE OR USE OF THIS DRAWING, IN WHOLE OR IN PART, IS HEREBY PROHIBITED EXCEPT AS SPECIFIED IN Page 16 of 18
WRITING BY GLOBTEK, INC. © GlobTek, Inc. 2018 - 2023
quest / 09/28/2023 7:48:02 PM GMT CLONED FROM TR9KZ3160LLPCIMR6B

GloTek, Inc. www.globtek.com 186 Veterans Drive, Northvale, NJ 07647 Tel. (201) 784-1000 Fax (201) 784-0111	Drawing Title: GTM96600-4520-T2, ICT / ITE / Medical Power Supply/Class 2/Household Power Supply, Efficiency Level: USA DOE Level VI / Eco-design Directive 2009/125/EC, (EU) 2019/1782, Case Color/Style: GlobTek Black, Desktop/External, Regulated Switchmode AC-DC Power Supply AC Adaptor, Input Rating: 100-240V~, 50-60Hz, IEC 60320/C8 , Output Rating: 45W, 20.0V@2.25A, Output Configuration: 1200 mm, 20/1C + Shield Cond, UL 1185, Female Barrel 4.0*1.7*12mm or Equal, Ferrite: Core: RH 14.2*28.5*10, GlobTek Black, GT Cord # C26418, Pin Out: Center Positive (+V), symbol compliant with IEC 60417 symbol no. 5926, Blades/Input Cord: (Order Separately), Approvals: Korea (41V-54V Only); CB 60335; Fuse 60335; ETL; EAC; cETLus 60601-1; CB 62368; India BIS; UKCA; UL 1310; Conforms to 62368-1; CB 61158; FCC; IP41; Morocco; Korea (9-15V Only); ETL 62368; Korea (16,18,19 and 20V only); Malaysia; IRAM; Korea (19V Only); PSE; PSE; PSE; China RoHS; Level VI; RoHS; Ukraine; VCCI; WEEE; ETL; CE; CB 60950; ETL 60950; S-Mark 60950; Double Insulation; RCM; CB 60601-1; S-Mark IEC/EN 60601-1; EAC; CCC; LPS 60950; South Africa;	
	Model No. GTM96600-4520-T2	
	Part No./Ordering No. TR9KZ2250EI212MEDRB	Rev B

INSTRUCTIONS TO THE OEM SYSTEMS ENGINEER

It is the responsibility of the OEM systems engineer to provide the end system user instructions and warnings for the use of this product in the end system.

If an input cord is required for this product, AC Mains voltage should be provided to the power supply by a power supply cord approved to the national standards of the country in which it will be used.

This product is not designed to be repaired. No serviceable parts inside. A blown internal fuse is an indication of catastrophic failure of circuit component(s). If a Failure Analysis is required for a failed power supply/battery charger, please return the damaged unit to GlobTek for an accurate determination of the root cause of the failure.

EMC Compliance of the complete OEM product, including the GlobTek power supply/battery charger needs to be verified by the OEM systems engineer.

INSTRUCTION SHEET

N/A

GlobTek, Inc. www.globtek.com 186 Veterans Drive, Northvale, NJ 07647 Tel. (201) 784-1000 Fax (201) 784-0111	Drawing Title: GTM96600-4520-T2, ICT / ITE / Medical Power Supply/Class 2/Household Power Supply, Efficiency Level: USA DOE Level VI / Eco-design Directive 2009/125/EC, (EU) 2019/1782, Case Color/Style: GlobTek Black, Desktop/External, Regulated Switchmode AC-DC Power Supply AC Adaptor, Input Rating: 100-240V~, 50-60Hz, IEC 60320/C8 , Output Rating: 45W, 20.0V@2.25A, Output Configuration: 1200 mm, 20/1C + Shield Cond, UL 1185, Female Barrel 4.0*1.7*12mm or Equal, Ferrite: Core: RH 14.2*28.5*10, GlobTek Black, GT Cord # C26418, Pin Out: Center Positive (+V), symbol compliant with IEC 60417 symbol no. 5926, Blades/Input Cord: (Order Separately), Approvals: Korea (41V-54V Only); CB 60335; Fuse 60335; ETL; EAC; cETLus 60601-1; CB 62368; India BIS; UKCA; UL 1310; Conforms to 62368-1; CB 61158; FCC; IP41; Morocco; Korea (9-15V Only); ETL 62368; Korea (16,18,19 and 20V only); Malaysia; IRAM; Korea (19V Only); PSE; PSE; PSE; China RoHS; Level VI; RoHS; Ukraine; VCCI; WEEE; ETL; CE; CB 60950; ETL 60950; S-Mark 60950; Double Insulation; RCM; CB 60601-1; S-Mark IEC/EN 60601-1; EAC; CCC; LPS 60950; South Africa;	
	Model No. GTM96600-4520-T2	
	Part No./Ordering No. TR9KZ2250EI212MEDRB	Rev B

